

KANSAS

WELL COMPLETION REPORT AND DRILLER'S LOG

API No. 15 — 179 — 20,579
County Number

S. 12 T. 10S. R. 26W E
State Geological Survey
WICHITA BRANCH
County Sheridan

Operator
Oxford Exploration Company

Address
1550 Denver Club Building Denver, CO 80202

Well No. 12-63 Lease Name Von Lintel

Footage Location
2970 feet from (E) (S) line 1650 feet from (E) (W) line

Principal Contractor Murfin Geologist Jim Reeves

Spud Date 1-1-81 Date Completed 1-5-81 Total Depth 4110 P.B.T.D.

Directional Deviation Oil and/or Gas Purchaser

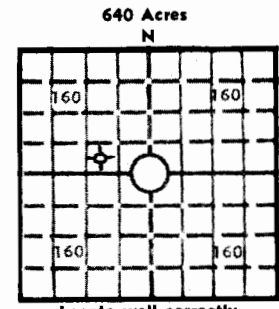

Elev.: Gr. 2584
DF KB 2589

CASING RECORD

Report of all strings set — surface, intermediate, production, etc.

Purpose of string	Size hole drilled	Size casing set (in O.D.)	Weight lbs/ft.	Setting depth	Type cement	Sacks	Type and percent additives
Surface	12 1/4"	8 5/8"		218	Common	180	

LINER RECORD

PERFORATION RECORD

Top, ft.	Bottom, ft.	Sacks cement	Shots per ft.	Size & type	Depth interval

TUBING RECORD

Size	Setting depth	Packer set at

ACID, FRACTURE, SHOT, CEMENT SQUEEZE RECORD

Amount and kind of material used	Depth interval treated

INITIAL PRODUCTION

Date of first production	Producing method (flowing, pumping, gas lift, etc.)				
RATE OF PRODUCTION PER 24 HOURS	Oil bbls.	Gas MCF	Water bbls.	Gas-oil ratio	CFPB
Disposition of gas (vented, used on lease or sold)			Producing interval (s)		

INSTRUCTIONS: As provided in KCC Rule 82-2-125, within 90 days after completion of a well, one completed copy of this Drillers Log shall be transmitted to the State Geological Survey of Kansas, 4150 Monroe Street, Wichita, Kansas 67209. Copies of this form are available from the Conservation Division, State Corporation Commission, 245 No. Water, Wichita, Kansas 67202. Phone AC 316-522-2206. If confidential custody is desired, please note Rule 82-2-125. Drillers Logs will be on open file in the Oil and Gas Division, State Geological Survey of Kansas, Lawrence, Kansas 66044.

Operator Oxford Exploration		DESIGNATE TYPE OF COMP.: OIL, GAS, DRY HOLE, SWDW, ETC.:
Well No. 12-63	Lease Name Von Lintel	Dry Hole
S 12 T10S R26W E W SW SE NW		

WELL LOG

Show all important zones of porosity and contents thereof; cored intervals, and all drill-stem tests, including depth interval tested, cushion used, time tool open, flowing and shut-in pressures, and recoveries.

SHOW GEOLOGICAL MARKERS, LOGS RUN, OR OTHER DESCRIPTIVE INFORMATION.

FORMATION DESCRIPTION, CONTENTS, ETC.	TOP	BOTTOM	NAME	DEPTH
Dst #1 3995-4044			Anhydrite	2212
20-40-45-90			Topeka	3594
Rec. 15' Mud			Heebner	3808
IH 2158 IF 31-31 ISIP 127			Toronto	3830
FH 2126 FF 31-42 FSIP 254			Lansing	3846
			Stark Shale	3972
			BKC	4076

USE ADDITIONAL SHEETS, IF NECESSARY, TO COMPLETE WELL RECORD.

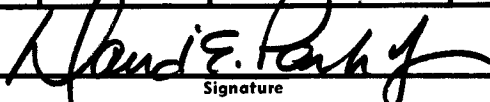
Date Received	 Signature
	President Title
	2-27-81 Date

6888L