

STATE CORPORATION COMMISSION OF KANSAS
OIL & GAS CONSERVATION DIVISION

WELL COMPLETION OR RECOMPLETION FORM
ACO-1 WELL HISTORY

DESCRIPTION OF WELL AND LEASE

Operator: license # 8996
name Mid Continent Resources, Inc.
address 2805 Bentbay Circle
City/State/Zip Wichita, KS 67204

Operator Contact Person Don V. Rider
Phone 316-838-9069

Contractor: license # 6033
name Murfin Drilling Co.

Wellsite Geologist Don V. Rider
Phone 316-838-9069

Designate Type of Completion

- New Well Re-Entry
- Oil SWD Temp Abd
- Gas Inj Delayed Comp.
- Dry Other (Core, Water Supply etc.)

If OWWO: old well info as follows:

Operator
Well Name
Comp. Date Old Total Depth

WELL HISTORY

Drilling Method: Mud Rotary Air Rotary Cable
6/25/84 Spud Date 7/3/84 Date Reached TD Plugged 7/4/84 Completion Date

RTD 4800' Total Depth Plugged D/A PBD

Amount of Surface Pipe Set and Cemented at 310 feet

Multiple Stage Cementing Collar Used? Yes No
If Yes, Show Depth Set feet

If alternate 2 completion, cement circulated from surface feet depth to 310' w/ 250' SX cmt

API NO. 15-193-20,312
County Thomas
SW NE Sec 31S Twp 10S Rge 31W
3300 Ft North from Southeast Corner of Section
1980 Ft West from Southeast Corner of Section
(Note: locate well in section plat below)

Lease Name "A-2" Moorhous Well# MCR#1V-84

Field Name Wildcat

Producing Formation

Elevation: Ground 2957 KB 2962

AUG 13 1985
State Geological Survey
WICHITA BRANCH

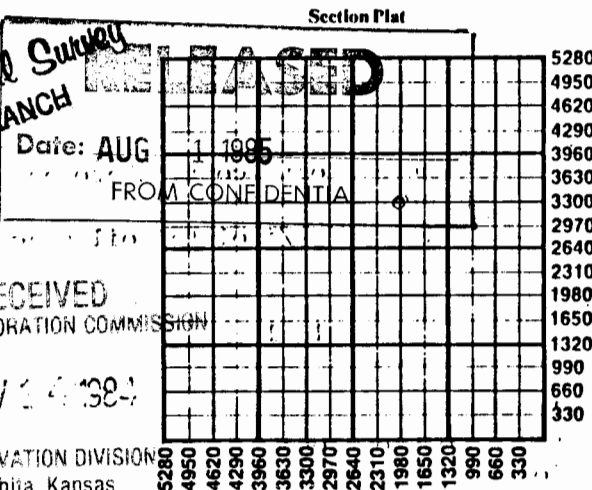

RECEIVED
STATE CORPORATION COMMISSION
NOV 14 1984
CONSERVATION DIVISION
Wichita, Kansas

WATER SUPPLY INFORMATION

Source of Water:
Division of Water Resources Permit #
 Groundwater Ft North From Southeast Corner and (Well) Ft. West From Southeast Corner of Sec Twp Rge East West
 Surface Water Ft North From Southeast Corner and (Stream, Pond etc.) Ft West From Southeast Corner Sec Twp Rge East West
 Other (explain) (purchased from city, R.W.D.#)

Disposition of Produced Water: n/a Disposal Repressuring

Docket #

RECEIVED
STATE CORPORATION COMMISSION
CONSERVATION DIVISION
Wichita, Kansas

I. INSTRUCTIONS: This form shall be completed in duplicate and filed with the Kansas Corporation Commission, 200 Colorado Derby Building, Wichita, Kansas 67202, within 90 days after completion or recompletion of any well. Rules 82-3-130 and 82-3-107 apply.

Information on side two of this form will be held confidential for a period of 12 months if requested in writing and submitted with the form. See rule 82-3-107 for confidentiality in excess of 12 months.

One copy of all wireline logs and drillers time log shall be attached with this form. Submit CP-111 form with all plugged wells. Submit CP-111 form with all temporarily abandoned wells.

79374

East
 West

Operator Name Mid Continent Resources Inc. "A-2" Lease Name Moorhouse MCR #1 V-87 Well# SL 31 TWP. 10S RGE. 31

WELL LOG

INSTRUCTIONS: Show important tops and base of formations penetrated. Detail all cores. Report all drill stem tests giving interval tested, time tool open and closed, flowing and shut-in pressures, whether shut-in pressure reached static level, hydrostatic pressures, bottom hole temperature, fluid recovery, and flow rates if gas to surface during test. Attach extra sheet if more space is needed. Attach copy of log.

Drill Stem Tests Taken Yes No
 Samples Sent to Geological Survey Yes No
 Cores Taken Yes No

Formation Description
 Log Sample

Name	Top	Bottom
Anhydrite	2496	+ 466
Heebner	3942	- 980
Toronto	3968	-1006
Lansing K.C.	3983	-1021
Base K.C.	4260	-1298
Marmaton	4291	-1329
Pawnee	4384	-1422
Cherokee	4446	-1484
Johnson Zone	4518	-1556
Mississippi	4576	-1614
RTD	4800	-1838
LTD	4801	-1839

DST #1 4388-4468:
ZONES TESTED: Pawnee, Fort Scott, Cherokee
Testing Times: 60-60-30-3-
Recovery: 65' drlg. mud w/isolated oil specks in tool.
ISIP: 646#
FSIP: 232#
Flow Pressures: 80-80,91-91

DST #2 4519-4544:
Zones Tested: Johnson Zone
Testing Times: 60-60-60-60
Recovery: 180' of watery mud
ISIP: 1086#
FSIP: 1046#
Flow Pressures: 40-60,70-70

CASING RECORD new used

Report all strings set - conductor, surface, intermediate, production, etc.

Purpose of string	size hole drilled	size casing set (In O.D.)	weight lbs/ft.	setting depth	type of cement	# sacks used	type and percent additives
surface	12 1/4"	8 5/8"	23#	310'	Sunset	250	

PERFORATION RECORD

shots per foot specify footage of each interval perforated

Acid, Fracture, Shot, Cement Squeeze Record

(amount and kind of material used) Depth

shots per foot	specify footage of each interval perforated	(amount and kind of material used)	Depth

WELL LOG

COMPANY MID-CONTINENT RESOURCES, INC.
 3301 Country Lane - ~~2805 Bentbay Circle~~
 Hays, KS 67601 ~~Wichita, KS 67204~~
FARM A-2 MOORHOUSE **NO.** IV-84

SEC. 31 **T.** 10S **R.** 31W
LOC. SW NE

RIG. NO. 21
TOTAL DEPTH 4800'
COMM. 6-25-84 **COMP.** 7-4-84

COUNTY Thomas
 KANSAS

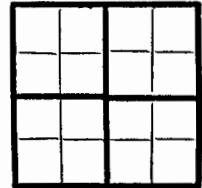

CONTRACTOR MURFIN DRILLING COMPANY
 250 N. Water, Suite 300
 Wichita, KS 67202

CASING
 20 10
 15 8 -5/8" csg set @ 309' w/200 sx Sunset
 12 6
 13 5

ELEVATION

PRODUCTION

FIGURES INDICATE BOTTOM OF FORMATIONS

Soil & Shale	310'
Shale	2497'
Anhydrite	2532'
Shale	4035'
Lime & Shale	(RTD) 4800'

~~CONFIDENTIAL~~

AUG 13 1984

State Geological Survey
 WICHITA BRANCH

RECEIVED
 STATE CORPORATION COMMISSION

OCT 11 1984

WICHITA BRANCH
 Wichita, Kansas

RECEIVED
 STATE CORPORATION COMMISSION

JUL 27 1984

CONSERVATION DIVISION
 Wichita, Kansas