

15-193-20139

State Geological Survey  
WICHITA BRANCH  
KANSAS DRILLERS LOG

S. 31 T. 10S R. 32 <sup>K</sup><sub>W</sub>  
Loc. 150' S of SW NE  
County Thomas

API No. 15 —————  
County Number

Operator  
Abercrombie Drilling, Inc.

Address  
801 Union Center, Wichita, Kansas

Well No. 2 Lease Name HECKER

Footage Location  
150 feet from (X) (S) line of SW/4 NE/4 ~~XXXXXXXXXXXX~~

Principal Contractor: Abercrombie Drilling, Inc. Geologist: Jerry A. Langrehr

Spud Date: May 31, 1977 Total Depth: 4720' P.B.T.D.

Date Completed: August 25, 1977 Oil Purchaser

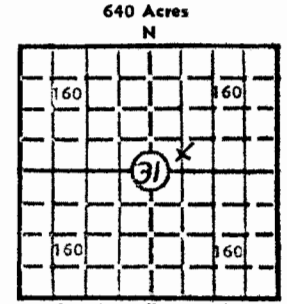

Elev.: Gr. 3070'  
DF 3073' KB 3075'

CASING RECORD

Report of all strings set — surface, intermediate, production, etc.

Purpose of string	Size hole drilled	Size casing set (in O.D.)	Weight lbs/ft.	Setting depth	Type cement	Sacks	Type and percent additives
Surface	12 1/4"	8-5/8"		248.33'	Common	175	2% gel, 3% CaCl
Production	7-7/8"	4 1/2"		(K.B.) 4401.89'	50/50 Posmix & Common	25 150	2% gel, 12 1/2# gilsinite 10% salt 4 1/2# friction reducer

LINER RECORD

PERFORATION RECORD

Top, ft.	Bottom, ft.	Sacks cement	Shots per ft.	Size & type	Depth interval
					4289-4294'

TUBING RECORD

Size	Setting depth	Packer set at

ACID, FRACTURE, SHOT, CEMENT SQUEEZE RECORD

Amount and kind of material used	Depth interval treated

INITIAL PRODUCTION

Date of first production August 25, 1977	Producing method (flowing, pumping, gas lift, etc.) Pumping				
RATE OF PRODUCTION PER 24 HOURS	Oil 152 bbls.	Gas 0 MCF	Water 24% bbls.	Gas-oil ratio 0	CFPB
Disposition of gas (vented, used on lease or sold)			Producing interval(s) 4289-4294'		

INSTRUCTIONS: As provided in KCC Rule 82-2-125, within 90 days after completion of a well, one completed copy of this Drillers Log shall be transmitted to the State Geological Survey of Kansas, 4150 Monroe Street, Wichita, Kansas 67209. Copies of this form are available from the Conservation Division, State Corporation Commission, 3830 So. Meridian (P.O. Box 17027), Wichita, Kansas 66217. Phone AC 316-522-2206. If confidential custody is desired, please note Rule 82-2-125. Drillers Logs will be on open file in the Oil and Gas Division, State Geological Survey of Kansas, Lawrence, Kansas 66044.

Operator: **Abercrombie Drilling, Inc.** DESIGNATE TYPE OF COMP.: OIL, GAS, DRY HOLE, SWDW, ETC.: **oil**

Well No. **2** Lease Name **HECKER**

S 31 T 10S R 32 <sup>K</sup>/<sub>W</sub>

**WELL LOG**

Show all important zones of porosity and contents thereof; cored intervals, and all drill-stem tests, including depth interval tested, cushion used, time tool open, flowing and shut-in pressures, and recoveries.

SHOW GEOLOGICAL MARKERS, LOGS RUN, OR OTHER DESCRIPTIVE INFORMATION.

FORMATION DESCRIPTION, CONTENTS, ETC.	TOP	BOTTOM	NAME	DEPTH
Sand	0	157	<u>SAMPLE TOPS:</u>	
Shale & surface clay	157	255		
Shale & sand	255	900	Anhydrite	2572' ( +503)
Shale & lime	900	1871	B/Anhydrite	2622' ( +453)
Sand & shale	1871	2572	Heebner	3992' ( -917)
Anhydrite	2572	2622	Toronto	4014' ( -939)
Shale & shells	2622	2756	Lansing	4030' ( -955)
Shale	2756	3167	Stark Sh.	4246' ( -1171)
Shale & lime	3167	3443	B/KC	4313' ( -1238)
Lime	3443	4230	Marmaton	4342' ( -1267)
Shale & lime	4230	4255	Pawnee	4440' ( -1365)
Lime	4255	4720	Upper Cher.	4496' ( -1421)
Rotary Total Depth		4720	Lower Cher.	4529' ( -1454)
DST #1 (4068-4140') 30", 45", 60", 45". Rec. 310' muddy salt water. IFP 76-109. IBHP 1327, FFP 120-185, FBHP 1317.			Johnson Zone	4573' ( -1498)
DST #2 (4173-4230') 30", 30", 30", 30". Weak blow - died in 15". Rec. 20' mud. IFP 43-43, IBHP 757, FFP 54-54, FBHP 458.			Mississippian	4630' ( -1555)
DST #3 (4214-4280') 30", 45", 60", 45". Weak blow throughout. Rec. 40' ocwm, 60' soc thin mud. IFP 65-76, IBHP 1065. FFP 76-98, FBHP 863.			<u>ELECTRIC LOG TOPS:</u>	
DST #4 (4278-4302') 15", 45", 60", 45". Strong blow. Rec. 1060' gip, 90' clean oil (Gravity 39.5) 150' muddy oil, 25% water. IFP 43-57, IBHP 1338, FFP 76-109, FBHP 1317.			Anhydrite	2572' ( +503)
DST #5 (4549-4590') 30", 30", 30", 30". Weak blow throughout. Rec. 20' ocm. IFP 43-54, IBHP 229, FFP 54-54, FBHP 109			B/Anhydrite	2600' ( +475)
			Heebner	3989' ( -914)
			Toronto	4012' ( -937)
			Lansing	4030' ( -955)
			Stark Sh.	4244' ( -1169)
			B/KC	4311' ( -1236)
			Marmaton	4338' ( -1263)
			Upper Cher.	4495' ( -1420)
			Lower Cher.	4628' ( -1553)
			Johnson	4574' ( -1499)
			Mississippian	4630' ( -1555)
			ELTD	4721' ( -1646)
			RTD	4720' ( -1645)

USE ADDITIONAL SHEETS, IF NECESSARY, TO COMPLETE WELL RECORD.

Date Received \_\_\_\_\_

*Jack L. Partridge*  
 Signature  
 Jack L. Partridge  
 Assistant Secretary-Treasurer  
 Title

September 2, 1977  
 Date