

15-193-20049  
JUN 27 1974

**IMPORTANT**  
Kans. Geo. Survey request  
samples on this well.

**KANSAS DRILLERS LOG**

S. 32 T. 10 R. 32WE  
W

API No. 15 — 193 — 20,049  
County Number

Loc. C SE NW  
County Thomas

Operator  
Donald C. Slawson

Address  
408 120 Building, Wichita, Kansas 67202

Well No. # 1 Lease Name Meek "A"

Footage Location  
feet from (N) (S) line feet from (E) (W) line

Principal Contractor Slawson Drilling Company, Inc. Geologist Ralph Ruwwe

Spud Date June 25, 1974 Total Depth 4630' P.B.T.D.

Date Completed Aug. 8, 1974 Oil Purchaser APCO

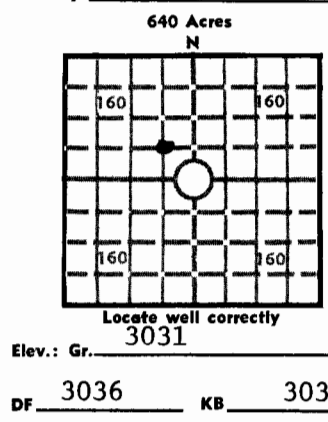

**CASING RECORD**

Report of all strings set — surface, intermediate, production, etc.

Purpose of string	Size hole drilled	Size casing set (in O.D.)	Weight lbs/ft.	Setting depth	Type cement	Sacks	Type and percent additives
Surface	12 1/4"	8 5/8"	28	287'	60/40 Poz	225 sx	2% Ge1 3% CaCl2
Production	7 7/8"	4 1/2"	10.5	4609'	50-50 Poz	225 sx	18% Salt

**LINER RECORD**

**PERFORATION RECORD**

Top, ft.	Bottom, ft.	Sacks cement	Shots per ft.	Size & type	Depth interval
			2	1/2 jets	4024-26 )
			"	"	4141-43 )
			"	"	4218-20 ) L-KC
			"	"	4249-52 )
			"	"	4529-32 )
			"	"	4538-40 ) Cher Ls

**ACID, FRACTURE, SHOT, CEMENT SQUEEZE RECORD**

Amount and kind of material used	Depth interval treated
750 GA NE 28%	Cherokee
2500 " "	L-KC

**INITIAL PRODUCTION**

Date of first production August 8, 1974	Producing method (flowing, pumping, gas lift, etc.) Pumping
RATE OF PRODUCTION PER 24 HOURS Oil 150.32 BOPD	Gas TSTM MCF Water tr bbls. Gas-oil ratio 0 CFPB
Disposition of gas (vented, used on lease or sold) N/A	Producing interval (s) L-KC; Cher Ls

INSTRUCTIONS: As provided in KCC Rule 82-2-125, within 90 days after completion of a well, one completed copy of this Drillers Log shall be transmitted to the State Geological Survey of Kansas, 4150 Monroe Street, Wichita, Kansas 67209. Copies of this form are available from the Conservation Division, State Corporation Commission, 3830 So. Meridian (P.O. Box 17027), Wichita, Kansas 66217. Phone AC 316-522-2206. If confidential custody is desired, please note Rule 82-2-125. Drillers Logs will be on open file in the Oil and Gas Division, State Geological Survey of Kansas, Lawrence, Kansas 66044.

Operator Donald C. Slawson DESIGNATE TYPE OF COMP.: OIL, GAS, DRY HOLE, SWDW, ETC.: Oil

Well No. 1 Lease Name Meek "A"

S 32 T 10 R 32W E W

**WELL LOG**

Show all important zones of porosity and contents thereof; cored intervals, and all drill-stem tests, including depth interval tested, cushion used, time tool open, flowing and shut-in pressures, and recoveries.

SHOW GEOLOGICAL MARKERS, LOGS RUN, OR OTHER DESCRIPTIVE INFORMATION.

FORMATION DESCRIPTION, CONTENTS, ETC.	TOP	BOTTOM	NAME	DEPTH
Surface Hole	0	230	ANH	2540 (+499)
Gray Shale	230	397	B/ANH	2569 (+470)
Shale & Shells	397	1902	HEEB	3952 (-913)
Shale & Lime	1902	2500	TORO	3972 (-933)
Shale & Lime	2500	2539	LANS	3992 (-953)
Anhydrite	2539	2590	STARK SH	4203 (-1164)
Shale & Lime	2590	3411	B/KC	4267 (-1228)
Lime & Shale	3411	3907	U/C	4451 (-1412)
Lime	3907	4340	L/C	4485 (-1446)
Lime & Shale	4340	4370	JOHN ZN	4528 (-1489)
Lime	4370	4630	MISS	4578 (-1539)
RTD	4630		LTD	4631 (-1592)
DST #1 3958-3987, 30,45,45,60, Fr str. blo. Rec. 275' MSW, IFP 45-90#, IBHP 1163#, FFP 90-161#, FBHP 1145#				
DST #2 4011-4064, 30,45,45,60, Wk gd. blo. Rec. 90' GIP 150' VMO 30' VHOCM 30' HOCWM, IFP 9-52#, IBHP 1270#, FFP 52-95# FBHP 1270#				
DST #3 4072-4077, 30,45,45,45, Rec 12' Mud w/scum oil, IFP 13-13#, BHP 69#, FFP 13-13# FBHP 69#				
DST #4 4110-4160, 30-45-45-60, Str. blo. Rec. 1260' CGO 240' Mdy Oil, IFP 56-314#, IBHP 1316 FFP 314-564#, FBHP 1302#				
<del>DST #5 4150-4182, 30-45-45-60, Cd blo. inc. to Str. blo. Rec. 330' GIP 100' OGCM 40' VHOCM IFP 36-64#, IBHP 926#, FFP 64-82# FBHP 1227#</del>				
DST #6 4176-4207, 30-45-45-60, Rec. 540' GIP 180' MGO, 30' OGCM, IFP 32-78, IBHP 591#, FFP 78-106#, FBHP 500#				
DST #7 4233-4370, 30-45-45-60, Rec. 930' GIP 310' GCM 30' HOCM, IFP 120-176#, IBHP 1223#, FFP 176-259#, FBHP 1163#				
DST #8 4475-4555, 30-45-45-60, wk blo. 240' OCM 30' Mud IFP 36-91#, IBHP 1163#, FFP 91-161#, FBHP 1131#				

USE ADDITIONAL SHEETS, IF NECESSARY, TO COMPLETE WELL RECORD.

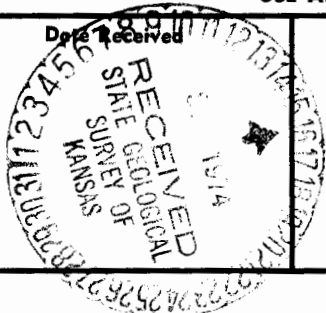

*James C. Remsburg*  
 James C. Remsburg Signature  
 Petroleum Engineer

Title  
 August 19, 1974  
 Date

7906L

COMPANY: Donald C. Slawson  
 408 One Twenty Building  
 Wichita, Kansas 67202

LEASE: Meek 'A' #1  
 C SE NW Sec. 32-10-32W  
 Thomas County, Kansas

TOTAL DEPTH: 4630 feet

COMMENCED: June 25, 1974

COMPLETED: July 8, 1974

CONTRACTOR: Slawson Drilling Company, Inc.

CASING: Set 8 5/8" 287' w/225 sx

32-10-32W  
 15-193-20049  
 cont.

0-230	Surface Hole
230-397	Gray Shale
397-1902	Shale & Shells
1902-2500	Shale & Lime
2500-2539	Shale & L
2539-2590	Anhydrite
2590-3411	Shale & Lime
3411-3907	Lime & Shale
3907-4340	Lime
4340-4370	Lime & Shale
4370-4630	Lime
4630	RTD

RECEIVED  
 STATE CORPORATION COMMISSION  
 JUL 24 1974  
 CONSERVATION DIVISION  
 Wichita, Kansas

STATE OF KANSAS )  
 ) SS.  
 COUNTY OF SEDGWICK )

RECEIVED  
 STATE GEOLOGICAL  
 SURVEY OF  
 KANSAS  
 AUG 1974

I, JAMES C. REMSBERG, of the Slawson Drilling Company, Inc. upon oath state that the above and foregoing is a true and correct copy of the log of the Meek 'A' #1 well.

*James C. Remsberg*  
 JAMES C. REMSBERG

Subscribed and sworn to before me this 19th day of July, 1974.

*Dolores B. Coady*  
 Dolores B. Coady, Notary Public

My Commission Expires: