

State Geological Survey
WICHITA, BRANCH

KANSAS DRILLERS LOG

API No. 15 — 193 — 20069
County Number

S. 32 T. 10 R. 32 
Loc. C SW SW
County Thomas

Operator
Donald C. Slawson

Address
408 120 Building

Well No. #6 Lease Name Meek 'A'

Footage Location
feet from (N) (S) line _____ feet from (E) (W) line _____

Principal Contractor Slawson Drilling Company Geologist Ralph Ruwwe

Spud Date October 3, 1975 Total Depth 4625 P.B.T.D. _____

Date Completed October 13, 1975 Oil Purchaser N/A

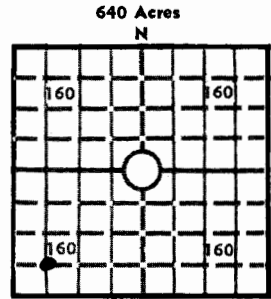

Elev.: Gr. 3092
3094 DF 3097 KB

CASING RECORD

Report of all strings set — surface, intermediate, production, etc.

Purpose of string	Size hole drilled	Size casing set (in O.D.)	Weight lbs/ft.	Setting depth	Type cement	Sacks	Type and percent additives
Surface	12½"	8 5/8"		342'	60/40 poz	250 sx	

LINER RECORD

PERFORATION RECORD

Top, ft.	Bottom, ft.	Sacks cement	Shots per ft.	Size & type	Depth interval

Size	Setting depth	Packer set at

ACID, FRACTURE, SHOT, CEMENT SQUEEZE RECORD

Amount and kind of material used	Depth interval treated

INITIAL PRODUCTION

Date of first production _____ Producing method (flowing, pumping, gas lift, etc.) _____

RATE OF PRODUCTION PER 24 HOURS	Oil	Gas	Water	Gas-oil ratio
	bbls.	MCF	bbls.	CFPB

Disposition of gas (vented, used on lease or sold) _____ Producing interval (s) _____

INSTRUCTIONS: As provided in KCC Rule 82-2-125, within 90 days after completion of a well, one completed copy of this Drillers Log shall be transmitted to the State Geological Survey of Kansas, 4150 Monroe Street, Wichita, Kansas 67209. Copies of this form are available from the Conservation Division, State Corporation Commission, 3830 So. Meridian (P.O. Box 17027), Wichita, Kansas 66217. Phone AC 316-522-2206. If confidential custody is desired, please note Rule 82-2-125. Drillers Logs will be on open file in the Oil and Gas Division, State Geological Survey of Kansas, Lawrence, Kansas 66044.

Operator Donald C. Slawson DESIGNATE TYPE OF COMP.: OIL, GAS, DRY HOLE, SWDW, ETC.: dry hole

Well No. #6 Lease Name Meek 'A'

S 32 T 10 R 32 W

WELL LOG

Show all important zones of porosity and contents thereof; cored intervals, and all drill-stem tests, including depth interval tested, cushion used, time tool open, flowing and shut-in pressures, and recoveries.

SHOW GEOLOGICAL MARKERS, LOGS RUN, OR OTHER DESCRIPTIVE INFORMATION.

FORMATION DESCRIPTION, CONTENTS, ETC.	TOP	BOTTOM	NAME	DEPTH	
Surface hole	0	350	No Electric Log		
Shale and Shells	350	2590			
Anhydrite	2590	2622			
Shale and Shells	2622	2885			
Shale	2885	3547			
Shale and Lime	3547	4121			
Lime	4121	4315			
Lime and Shale	4315	4625			
RTD	4625				
DST #1 4170-4240, 30-45-30+45, VWB/30" NB/2nd opening. Rec. 60' M w/few spks O, IFP 27-36#, IBHP 736#, FFP 72-81#, FBHP 342#					
DST #2 4234-68, FB inc SB, Rec. 155' GMO (55% O, 4% M) bottom 55% O, 43% M, 2% W, IFP 54-72#, IBHP 611# FFP 72-108#, FBHP 575#					
DST #3 4268-4285, VWBTO, Rec. 20' M, NS, IFP 18-18#, IBHP 1184#, FFP 18-14#, FBHP 1184#					
DST #4 4545-4625, 30-45-45-60, WB inc FB on init. VWBTO on final. Rec. 190' M, NS, NW, IFP 27-72#, IBHP 431#, FFP 72-143#, FBHP 341#					

USE ADDITIONAL SHEETS, IF NECESSARY, TO COMPLETE WELL RECORD.

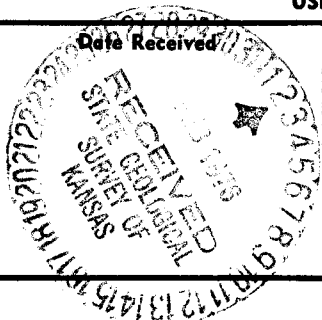

James C. Remsberg
Signature

James C. Remsberg, Petroleum Engineer
Title

October 23, 1975
Date

0106L

Cont.

15-193-20,069

OPERATOR: Donald C. Slawson
408 120 Building
Wichita, Kansas

LEASE: #6 Meek 'A'
C SW SW Sec. 32-10-32W
Thomas Co., Kansas

CONTRACTOR: Slawson Drilling Company, Inc.

COMMENCED: October 3, 1975

COMPLETED: October 13, 1975

CASING: Set 8 5/8" @ 342' w/250 sx

TOTAL DEPTH: 4625'

0 - 350	Surface hole
350 - 2590	Shale and Shells
2590 - 2622	Anhydrite
2622 - 2885	Shale and Shells
2885 - 3547	Shale
3547 - 4121	Shale and Lime
4121 - 4315	Lime
4315 - 4625	Lime and Shale
4625	RTD.



STATE OF KANSAS)
) SS.
COUNTY OF SEDGWICK)

I, JAMES C. REMSBERG, of the Slawson Drilling Company, Inc. upon oath state that the above and foregoing is a true and correct copy of the log of the #6 Meek 'A' well.

James C. Remsberg
James C. Remsberg

Subscribed and sworn to before me this 23rd day of October, 1975

Dolores B. Coady
Dolores B. Coady, Notary Public