

API No. 15 — County — Number

Operator  
Donald C. Slawson

Address  
408 One Twenty Building, Wichita, Ks. 67202

Well No. #1 Lease Name Dumler 'H'

Footage Location  
2260' feet from (N) (S) line 2150' feet from (E) (W) line

Principal Contractor Slawson Drilling Co., Inc. Geologist George Mueller

Spud Date March 9, 1977 Total Depth 4684' P.B.T.D. 4332'

Date Completed March 20, 1977 Oil Purchaser

S. 3 T. 10 R. 33W E  
Loc. App N/2 NW SE  
County Thomas

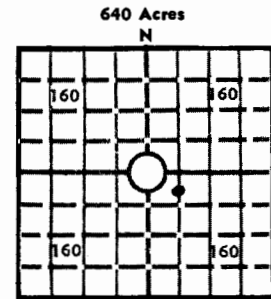

Locate well correctly  
Elev.: Gr. 3128  
DF 3131 KB 3133

CASING RECORD

Report of all strings set — surface, intermediate, production, etc.

Purpose of string	Size hole drilled	Size casing set (in O.D.)	Weight lbs/ft.	Setting depth	Type cement	Sacks	Type and percent additives
Surface	12 1/4"	8 5/8"	24#	374'	60/40 poz	225 sx	2% gel, 3% cc
Production	7 7/8"	4 1/2"	10.5#	4332'	50/50 poz	150 sx	18% salt, 3/4 of 1% CFR-2

LINER RECORD

PERFORATION RECORD

Top, ft.	Bottom, ft.	Sacks cement	Shots per ft.	Size & type	Depth interval
			2	golden jets	4221-25
					4250-58

ACID, FRACTURE, SHOT, CEMENT SQUEEZE RECORD

Amount and kind of material used	Depth interval treated
2500 gal NE-28 acid	4250-4258

INITIAL PRODUCTION

Date of first production March 31, 1977		Producing method (flowing, pumping, gas lift, etc.) Pumping			
RATE OF PRODUCTION PER 24 HOURS	Oil 180.35 bbls.	Gas TSTM MCF	Water Trace bbls.	Gas-oil ratio -----	CFPB
Disposition of gas (vented, used on lease or sold)			Producing interval(s) 4250-4258 4221-25		

INSTRUCTIONS: As provided in KCC Rule 82-2-125, within 90 days after completion of a well, one completed copy of this Drillers Log shall be transmitted to the State Geological Survey of Kansas, 4150 Monroe Street, Wichita, Kansas 67209. Copies of this form are available from the Conservation Division, State Corporation Commission, 3830 So. Meridian (P.O. Box 17027), Wichita, Kansas 66217. Phone AC 316-522-2206. If confidential custody is desired, please note Rule 82-2-125. Drillers Logs will be on open file in the Oil and Gas Division, State Geological Survey of Kansas, Lawrence, Kansas 66044.

Operator

DESIGNATE TYPE OF COMP.: OIL, GAS, DRY HOLE, SWDW, ETC.:  
oil

Well No.

#1

Lease Name

Dumler 'H'

S 3 T0 R 33W E  
W

**WELL LOG**

Show all important zones of porosity and contents thereof; cored intervals, and all drill-stem tests, including depth interval tested, cushion used, time tool open, flowing and shut-in pressures, and recoveries.

SHOW GEOLOGICAL MARKERS, LOGS RUN, OR OTHER DESCRIPTIVE INFORMATION.

FORMATION DESCRIPTION, CONTENTS, ETC.	TOP	BOTTOM	NAME	DEPTH
0 - 376 Surface hole				
376 - 1507 Shale, shells and sand				
1507 - 2645 Shale and shells				
2645 - 2676 Anhydrite				
2676 - 2694 Shale and shells				
2694 - 2944 Shale and lime				
2944 - 3225 Shale				
3225 - 4235 Shale and lime				
4235 - 4684 Lime				
4684 RTD				
<p>DST #1 4195-4235 (140' zn), Pkr failed.  DST #2 4200-4235 (140' zn), 30-45-30-30,  VWB/died 28", Rec. 60' VSOCM, FO on top of rec.  IFP 27-37#, ISIP 1352#, FFP 46-55#, FSIP 1315#  DST #3 4132-4164 (160' zn), 30-45-45-60, SBTO,  Rec. 2236' GIP, 868' GMO, NW 40° @ 60° IFP 2-17#?,  ISIP 1318#, FFP 183-311#, FSIP 1300# 120°  DST #4 4276-4290 (180' zn), 30-30-30-30,, VSB/20',  Rec. 1' MO, IFP 6-6#, ISIP 596#, FFP 7-7#, FSIP 49#  DST #5 4284-4320 (200' zn), 30-45-45-60, GBTO,  Rec. 450' Slty sulf wtr, IFP 55-128#, ISIP 1297#,  FFP 128-219#, FSIP 1297#, 125°  DST #6 4560-4637 (straddle) 30-45-30-30,(JH ZN),  VWB/30", Rec. 20' M, NS, IFP 36-55#, ISIP 201#,  FFP 55-55#, FSIP 109#, 130°</p>				
USE ADDITIONAL SHEETS, IF NECESSARY TO COMPLETE WELL RECORD.				

LOG TOPS  
ANH 2648 (-586)  
HEEB 4028 (-895)  
TORO 4050 (-917)  
LANS 4068 (-935)  
STK 4284 (-1151)  
B/KC 4340 (-1207)  
MARM 4370 (-1237)  
PAWN 4478 (-1345)  
L/CK 4568 (-1435)  
MISS 4670 (-1537)  
LTD 4685 (-1552)

Date Received

*R. J. Thatcher*  
Signature

R. J. Thatcher

Title

April 20, 1977

Date

EMBL