

STATE CORPORATION COMMISSION OF KANSAS  
OIL & GAS CONSERVATION DIVISION  
WELL COMPLETION OR RECOMPLETION FORM  
ACO-1 WELL HISTORY  
DESCRIPTION OF WELL AND LEASE

Operator: License # 8541  
Petex, Inc.  
Name  
Address 1111 S. Glenstone, #1-104  
City/State/Zip Springfield, MO 65804

Purchaser  
Operator Contact Person Larry Childress  
Phone (417) 862-2177

Contractor: License # 5104  
Blue Goose Drilling  
Name

Wellsite Geologist Thomas Funk  
Phone (316) 686-5836

Designate Type of Completion  
 New Well  Re-Entry  Workover  
 Oil  SWD  Temp Abd  
 Gas  Inj  Delayed Comp.  
 Dry  Other (Core, Water Supply etc.)  
If OWWO: old well info as follows:  
Operator  
Well Name  
Comp. Date Old Total Depth

WELL HISTORY

Drilling Method:  
 Mud Rotary  Air Rotary  Cable  
11/3/88 11/12/88 11-12-88  
Spud Date Date Reached TD Completion Date  
4740  
Total Depth PBTD  
Amount of Surface Pipe Set and Cemented at 321 feet  
Multiple Stage Cementing Collar Used? Yes No  
If yes, show depth set feet  
If alternate 2 completion, cement circulated from feet depth to w/ SX cmt  
Cement Company Name  
Invoice #

API NO. 15-  
County Thomas  
S 1/2 S 1/2 SW 14 10 33 East  
Sec Twp Rge X West  
330 Ft North from Southeast Corner of Section  
3960 Ft West from Southeast Corner of Section  
(Note: Locate well in section plat below)

Lease Name Krug Well # 1  
Field Name  
Producing Formation  
Elevation: Ground 3142 8149 KB

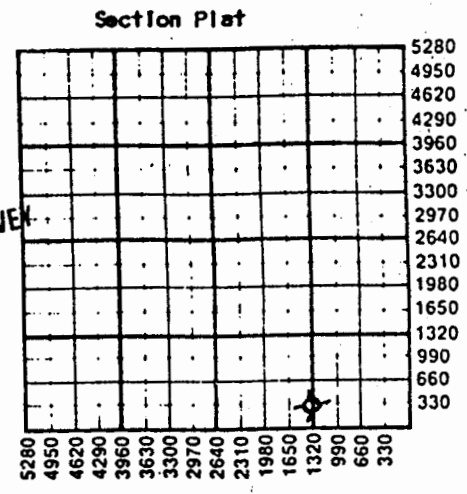

WATER SUPPLY INFORMATION  
Disposition of Produced Water: Disposal  
Docket # Repressuring

Questions on this portion of the ACO-1 call:  
Water Resources Board (913) 296-3717  
Source of Water:  
Division of Water Resources Permit #  
Groundwater Ft North from Southeast Corner (Well) Ft West from Southeast Corner of Sec Twp Rge East West  
Surface Water Ft North from Southeast Corner (Stream, pond etc) Ft West from Southeast Corner Sec Twp Rge East West  
Other (explain) (purchased from city, R.W.D. #)

INSTRUCTIONS: This form shall be completed in triplicate and filed with the Kansas Corporation Commission, 200 Colorado Derby Building, Wichita, Kansas 67202, within 120 days of the spud date of any well. Rule 82-3-130, 82-3-107 and 82-3-106 apply. Information on side two of this form will be held confidential for a period of 12 months if requested in writing and submitted with the form. See rule 82-3-107 for confidentiality in excess of 12 months. One copy of all wireline logs and drillers time log shall be attached with this form. Submit CP-4 form with all plugged wells. Submit CP-111 form with all temporarily abandoned wells.

All requirements of the statutes, rules and regulations promulgated to regulate the oil and gas industry have been fully complied with and the statements herein are complete and correct to the best of my knowledge.

Signature Larry Childress  
Title President Date 1/10/89

Subscribed and sworn to before me this 10 day of January 1989  
Notary Public Peggy Steelman  
Date Commission Expires 7/29/91

K.C.C. OFFICE USE ONLY  
C Wireline Log Received  
C Drillers Timelog Received  
Distribution  
KCC SWD/Rep NGPA  
KGS Plug Other  
(Specify)

RECEIVED  
STATE CORPORATION COMMISSION

JAN 17 1989

CONSERVATION DIVISION  
Wichita, Kansas

Form ACO-1 (5-86)

Sec 14 Twp 10 Rge 33W

**WELL LOG**

INSTRUCTIONS: Show important tops and base of formations penetrated. Detail all cores. Report all drill stem tests giving interval tested, time tool open and closed, flowing and shut-in pressures, whether shut-in pressure reached static level, hydrostatic pressures, bottom hole temperature, fluid recovery, and flow rates if gas to surface during test. Attach extra sheet if more space is needed. Attach copy of log.

Drill Stem Tests Taken  Yes  No  
 Samples Sent to Geological Survey  Yes  No  
 Cores Taken  Yes  No

Formation Description  
 Log  Sample

	Name	Top	Bottom
	<del>Anhydrite</del>		
	B/anhydrite	2641	+508
2	Heebner	2672	+477
	Lansing	4039	- 890
	Stark	4077	- 928
#3	Marmaton	4298	-1149
	Pawnee	4380	-1231
#4	Cherokee	4501	-1352
	Johnson	4586	-1437
	Miss	4633	-1484
		4722	-1573

**CASING RECORD**  New  Used

Report all strings set-conductor, surface, intermediate, production, etc.

Purpose of String	Size Hole Drilled	Size Casing Set (in O.D.)	Weight Lbs/Ft.	Setting Depth	Type of Cement	#Sacks Used	Type and Percent Additives
surface	12 1/4	8-5/8	20#	321	pozmix	190	
.....	.....	.....	.....	.....	.....	.....	.....
.....	.....	.....	.....	.....	.....	.....	.....

**PERFORATION RECORD**

Shots Per Foot	Specify Footage of Each Interval Perforated	Acid, Fracture, Shot, Cement Squeeze Record (Amount and Kind of Material Used)	Depth
.....	.....	.....	.....
.....	.....	.....	.....
.....	.....	.....	.....

**TUBING RECORD**

Size	Set At	Packer at	Liner Run	<input type="checkbox"/> Yes <input type="checkbox"/> No
.....	.....	.....	.....	.....

Date of First Production ..... Producing Method  Flowing  Pumping  Gas Lift  Other (explain).....

Estimated Production Per 24 Hours	Oil Bbls	Gas MCF	Water Bbls	Gas-Oil Ratio	Gravity
.....	.....	.....	.....	.....	.....

**METHOD OF COMPLETION**

Production Interval

Disposition of gas:  Vented  Open Hole  Perforation  
 Sold  Other (Specify) .....  
 Used on Lease  Dually Completed  
 Conmingled

0986L