

15-193-20156

State Geological Survey
WICHITA DISTRICT
KANSAS DRILLERS LOG

IMPORTANT
Kans. Geo. Survey request
samples on this well.

S. 29 T. 10 R. 33 E
W

API No. 15 — 193 — 20,156
County Number

Loc. C NW SW

Operator
Thunderbird Drilling, Inc.

County Thomas

Address
P. O. Box 18407 Wichita, Kansas 67218

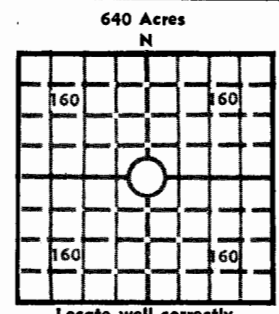

Well No. #1 Lease Name Smith "E"

Elev.: Gr. 3152

Footage Location
feet from (N) (S) line feet from (E) (W) line

Principal Contractor Thunderbird Drilling, Inc. Geologist Stanton S. Cox

DF KB 3157

Spud Date 12/23/77 Total Depth 4738 P.B.T.D.

Date Completed 1/8/78 Oil Purchaser

CASING RECORD

Report of all strings set — surface, intermediate, production, etc.

Purpose of string	Size hole drilled	Size casing set (in O.D.)	Weight lbs/ft.	Setting depth	Type cement	Sacks	Type and percent additives
Surface		8 5/8"		385'	com	275	2% gel, 3% cc.

LINER RECORD

PERFORATION RECORD

Top, ft.	Bottom, ft.	Sacks cement	Shots per ft.	Size & type	Depth interval

TUBING RECORD

Size	Setting depth	Packer set at

ACID, FRACTURE, SHOT, CEMENT SQUEEZE RECORD

Amount and kind of material used	Depth interval treated

INITIAL PRODUCTION

Date of first production		Producing method (flowing, pumping, gas lift, etc.)			
RATE OF PRODUCTION PER 24 HOURS	Oil	Gas	Water	Gas-oil ratio	
	bbis.	MCF	bbis.	CFPB	
Disposition of gas (vented, used on lease or sold)			Producing interval(s)		

INSTRUCTIONS: As provided in KCC Rule 82-2-125, within 90 days after completion of a well, one completed copy of this Drillers Log shall be transmitted to the State Geological Survey of Kansas, 4150 Monroe Street, Wichita, Kansas 67209. Copies of this form are available from the Conservation Division, State Corporation Commission, 3830 So. Meridian (P.O. Box 17027), Wichita, Kansas 66217. Phone AC 316-522-2206. If confidential custody is desired, please note Rule 82-2-125. Drillers Logs will be on open file in the Oil and Gas Division, State Geological Survey of Kansas, Lawrence, Kansas 66044.

Operator Thunderbird Drilling, Inc.		DESIGNATE TYPE OF COMP.: OIL, GAS, DRY HOLE, SWDW, ETC.:
Well No. 1	Lease Name Smith "E"	Dry Hole
S 29 T 10S R 33W E W		

WELL LOG

Show all important zones of porosity and contents thereof; cored intervals, and all drill-stem tests, including depth interval tested, cushion used, time tool open, flowing and shut-in pressures, and recoveries.

SHOW GEOLOGICAL MARKERS, LOGS RUN,
OR OTHER DESCRIPTIVE INFORMATION.

FORMATION DESCRIPTION, CONTENTS, ETC.	TOP	BOTTOM	NAME	DEPTH
DST #1, /45-45-45-45, rec. 1740' wtr, FP 121-886#, BHP 1345-1345#	4142	4192	Anhydrite B/Anhydrite Heebner Toronto	2642+ 515 2679+ 478 4037- 880 4066- 909
DST #2, /45-45-45-45, rec. 125' sgcwm, FP 52-104#, BHP 1332-1306#	4211	4250	Lansing-Kansas City Stark Base Kansas	4080- 923 4304-1147
DST #3, /45-45-45-45, rec. 55' thin mud, FP 35-61#, BHP 1228-1159#	4251	4284	City Marmaton Pawnee Fort Scott	4364-1207 4388-1231 4494-1337 4554-1397
DST #4, /45-45-45-45, rec. 260' thin mud w/few sps oil, FP 104-182#, BHP 1254-1159#	4279	4362	Cherokee Mississippian RTD LTD	4583-1426 4688-1531 4738-1581 4739-1582
DST #5 /30-30-30-30, rec. 15' mud, FP 77-82# BHP 130-87#	4590	4680		

USE ADDITIONAL SHEETS, IF NECESSARY, TO COMPLETE WELL RECORD.

Date Received	_____
	Signature

	Title

	Date

1686L