

KANSAS *PL*

WELL COMPLETION REPORT AND *State Geological Survey*
DRILLER'S LOG

WICHITA BRANCH

API No. 15 — 167 — 21,631
County Number

S. 16 T. 11S R. 15 W

Loc. NW SE NW

County Russell

Operator
Sohio Petroleum Company

Address
P.O. Box 30, Casper, WY 82602

Well No. 6 Lease Name Hines 'B'

Footage Location
990 feet from (N) (S) line 990 feet from (E) (W) line

Principal Contractor Emphasis Oil Operations Geologist Francis C. Whisler

Spud Date 3-31-81 Date Completed 5-14-81 Total Depth 3387' P.B.T.D. -

Directional Deviation 1/2° Oil and/or Gas Purchaser Koch Oil Company

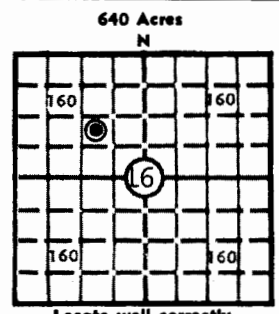

Locate well correctly
Elev.: Gr. 1937'

DF KB 1942'

CASING RECORD

Report of all strings set — surface, intermediate, production, etc.

Purpose of string	Size hole drilled	Size casing set (in O.D.)	Weight lbs./ft.	Setting depth	Type cement	Sacks	Type and percent additives
Surface	12 1/4"	8-5/8"	20	198	60-40 poz Class 'A'	150	2% gel 3% CaCl
Production	7-7/8"	5 1/2"	14	3379	50-50 poz Howcolite	170	.75% CFR ₂ , 18% salt 10# gilsonite/sk

LINER RECORD

PERFORATION RECORD

Top, ft.	Bottom, ft.	Sacks cement	Shots per ft.	Size & type	Depth interval
--	--	--	Open Hole	--	3379-3387'

TUBING RECORD

Size	Setting depth	Packer set at
2-3/8"	3341'	--

ACID, FRACTURE, SHOT, CEMENT SQUEEZE RECORD

Amount and kind of material used	Depth interval treated
Spot 50 gal MCA	3379-3387'

INITIAL PRODUCTION

Date of first production 5-21-81 Producing method (flowing, pumping, gas lift, etc.) Pumping

RATE OF PRODUCTION PER 24 HOURS	OIL	Gas	Water	Gas-oil ratio
	<u>13</u> bbls.	<u>-</u> MCF	<u>0</u> bbls.	<u>CFPB</u>

Disposition of gas (vented, used on lease or sold) _____ Producing interval(s) 3379-3387'

INSTRUCTIONS: As provided in KCC Rule 82-2-125, within 90 days after completion of a well, one completed copy of this Drillers Log shall be transmitted to the State Geological Survey of Kansas, 4150 Monroe Street, Wichita, Kansas 67209. Copies of this form are available from the Conservation Division, State Corporation Commission, 245 No. Water, Wichita, Kansas 67202. Phone AC 316-522-2206. If confidential custody is desired, please note Rule 82-2-125. Drillers Logs will be on open file in the Oil and Gas Division, State Geological Survey of Kansas, Lawrence, Kansas 66044.

Operator Sohio Petroleum Company

DESIGNATE TYPE OF COMP.: OIL, GAS,
DRY HOLE, SWDW, ETC.:
Oil

Well No.

6

Lease Name

Hines 'B'

S 16 T 11S R 15 ^R_W

WELL LOG

Show all important zones of porosity and contents thereof; cored intervals, and all drill-stem tests, including depth interval tested, cushion used, time tool open, flowing and shut-in pressures, and recoveries.

SHOW GEOLOGICAL MARKERS, LOGS RUN,
OR OTHER DESCRIPTIVE INFORMATION.

FORMATION DESCRIPTION, CONTENTS, ETC.	TOP	BOTTOM	NAME	DEPTH
Logs: Gamma Ray - Neutron - Laterlog - Caliper - CCL - CBL			Grand Haven	2466
			Dover	2500
			Tarkio Lime	2536
DST #1 3378'-86' (corrected to 3379-87 log)			Elmont	2596
			Topeka	2782
Time interval: 5-60-60-150 with fair to strong blow			Heebner	3005
			Toronto	3024
			LKC	3054
Recovery: 150' of clean oil; 210' of mud cut oil			Base of LKC	3310
			Arbuckle	3377
			Log TD	3387
IFP: 42 to 53 psi				
IBHP: 422 psi				
FFP: 53 to 148 psi				
FBHP: 401 psi				
BHT: 99°				

USE ADDITIONAL SHEETS, IF NECESSARY, TO COMPLETE WELL RECORD.

Date Received

W. H. Ward

Signature

District Superintendent

Title

8-13-81

Date

07808