

State Geological Survey

WICHITA BRANCH
KANSAS DRILLERS LOG

15-167-21054

API No. 15 — 167 — 21, 054
County Number

S. 22 T. 11 R. 15 W

Loc. NW SW NE

County Russell

Operator
Shields Oil Producers, Inc.

Address
Shields Building Russell, Kansas 67665

Well No. #1 Lease Name Reich "D"

Footage Location
1650 feet from (N) (S) line 2410 feet from (E) (W) line

Principal Contractor Shields Drlg. Co., Inc. Geologist M. L. Ratts

Spud Date 5-28-77 Total Depth 3281 P.B.T.D.

Date Completed 6-4-77 Oil Purchaser Koch

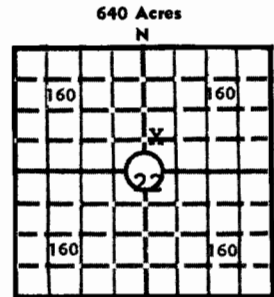

Locate well correctly

Elev.: Gr. 1812

DF 1815 KB 1817

CASING RECORD

Report of all strings set — surface, intermediate, production, etc.

Purpose of string	Size hole drilled	Size casing set (in O.D.)	Weight lbs/ft.	Setting depth	Type cement	Sacks	Type and percent additives
Surface	12 1/4	8 5/8	24	270	Quickset	170	
Production	7 7/8	5 1/2	14	3277	Common	125	

LINER RECORD

PERFORATION RECORD

Top, ft.	Bottom, ft.	Sacks cement	Shots per ft.	Size & type	Depth interval

Size	Setting depth	Packer set at

ACID, FRACTURE, SHOT, CEMENT SQUEEZE RECORD

Amount and kind of material used	Depth interval treated
1,500 gal. 15% Acid	3277-3281

INITIAL PRODUCTION

Date of first production 6-25-77	Producing method (flowing, pumping, gas lift, etc.) Pumping
RATE OF PRODUCTION PER 24 HOURS	Oil 25 bbls. Gas None MCF Water None bbls. Gas-oil ratio CFPB
Disposition of gas (vented, used on lease or sold) None	Producing interval(s) 3277-3281

INSTRUCTIONS: As provided in KCC Rule 82-2-125, within 90 days after completion of a well, one completed copy of this Drillers Log shall be transmitted to the State Geological Survey of Kansas, 4150 Monroe Street, Wichita, Kansas 67209. Copies of this form are available from the Conservation Division, State Corporation Commission, 3830 So. Meridian (P.O. Box 17027), Wichita, Kansas 66217. Phone AC 316-522-2206. If confidential custody is desired, please note Rule 82-2-125. Drillers Logs will be on open file in the Oil and Gas Division, State Geological Survey of Kansas, Lawrence, Kansas 66044.

Operator
Shields Oil Producers, Inc.

DESIGNATE TYPE OF COMP.: OIL, GAS,
DRY HOLE, SWDW, ETC.:

Well No. 1

Lease Name
Reich "D"

Oil

S 22 T 11 R 15 K
W

WELL LOG

Show all important zones of porosity and contents thereof; cored intervals, and all drill-stem tests, including depth interval tested, cushion used, time tool open, flowing and shut-in pressures, and recoveries.

SHOW GEOLOGICAL MARKERS, LOGS RUN,
OR OTHER DESCRIPTIVE INFORMATION.

FORMATION DESCRIPTION, CONTENTS, ETC.	TOP	BOTTOM	NAME	DEPTH
D.S.T. #1 2950-3010 Good blow for 1 hr. Rec. 300' Gas 40' O.C.M.Wtr. 180' M.W. I.S.I.P. - 465#/30 minutes I.F.P. - 113# F.F.P. - 192# F.S.I.P. - 477#/30 minutes			Anhydrite Heebner Sh. Toronto Lm. L-K.C. Lm. Arbuckæ Dol.	882 2895 2914 2945 3274
D.S.T. #2 3090-3140 Fair blow 1 hr. Rec. 260' Gas 100' Heavily O & GCM I.S.I.P. - 493#/30 minutes I.F.P. - 96# F.F.P. - 84# F.S.I.P. - 469#/30 minutes				

USE ADDITIONAL SHEETS, IF NECESSARY, TO COMPLETE WELL RECORD.

Date Received

M. Z. Pratt
Signature

Geologist-Engineer
Title

6-28-77
Date

81554