

**WELL COMPLETION REPORT AND
DRILLER'S LOG**

State Geol. Survey
KANSAS
WICHITA BRANCH

S. 22 T. 11 R. 15 ^X/_W
Loc. Approx. N/2 NW SE
County Russell

API No. 15 — 167 — 21,462 JUL 8 0 REC'D
County Number

Operator
Shields Oil Producers, Inc.

Address
Shields Bldg., Russell, Kansas 67665

Well No. 4 Lease Name Reich "D"

Footage Location
2310 feet from (S) line 1980 feet from (E) line

Principal Contractor Shields Drlg., Co., Inc. Geologist M. L. Ratts

Spud Date 5-31-80 Date Completed 6-7-80 Total Depth 3340 P.B.T.D.

Directional Deviation Oil and/or Gas Purchaser

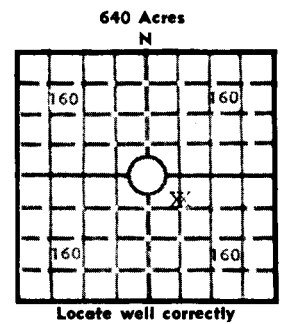

Elev.: Gr. 1831
DF 1834 KB 1836

CASING RECORD

Report of all strings set — surface, intermediate, production, etc.

Purpose of string	Size hole drilled	Size casing set (in O.D.)	Weight lbs/ft.	Setting depth	Type cement	Sacks	Type and percent additives
Surface	12 1/4	8 5/8	20	255	Quickset	160	

LINER RECORD

PERFORATION RECORD

Top, ft.	Bottom, ft.	Sacks cement	Shots per ft.	Size & type	Depth interval
TUBING RECORD					
Size	Setting depth	Packer set at			

ACID, FRACTURE, SHOT, CEMENT SQUEEZE RECORD

Amount and kind of material used	Depth interval treated

INITIAL PRODUCTION

Date of first production Producing method (flowing, pumping, gas lift, etc.)

RATE OF PRODUCTION PER 24 HOURS	Oil	Gas	Water	Gas-oil ratio
	bbls.	MCF	bbls.	CFPB

Disposition of gas (vented, used on lease or sold) Producing interval (s)

INSTRUCTIONS: As provided in KCC Rule 82-2-125, within 90 days after completion of a well, one completed copy of this Drillers Log shall be transmitted to the State Geological Survey of Kansas, 4150 Monroe Street, Wichita, Kansas 67209. Copies of this form are available from the Conservation Division, State Corporation Commission, 245 No. Water, Wichita, Kansas 67202. Phone AC 316-522-2206. If confidential custody is desired, please note Rule 82-2-125. Drillers Logs will be on open file in the Oil and Gas Division, State Geological Survey of Kansas, Lawrence, Kansas 66044.

Operator **Shields Oil Producers, Inc.** DESIGNATE TYPE OF COMP.: OIL, GAS, DRY HOLE, SWDW, ETC.:

Well No. **4** Lease Name **Reich "D"** **Dry Hole**

S 22 T 11 R 15 ^X/_W

WELL LOG

Show all important zones of porosity and contents thereof; cored intervals, and all drill-stem tests, including depth interval tested, cushion used, time tool open, flowing and shut-in pressures, and recoveries.

SHOW GEOLOGICAL MARKERS, LOGS RUN, OR OTHER DESCRIPTIVE INFORMATION.

FORMATION DESCRIPTION, CONTENTS, ETC.	TOP	BOTTOM	NAME	DEPTH
<p><u>D.S.T. #1 3310-3340</u> Strong blow for 1 hr. Rec. 1400' salt water</p> <p>I.S.I.P. - 771#/30 minutes I.F.P. - 179# F.F.P. - 498# F.S.I.P. - 787#/30 minutes</p>			Anhydrite Heebner Sh Toronto Lm L-KC Lm Cong. Sd Arbuckle Dol	908 2926 2946 2978 3312 3332

USE ADDITIONAL SHEETS, IF NECESSARY, TO COMPLETE WELL RECORD.

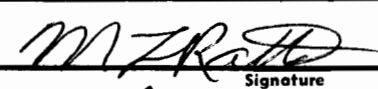
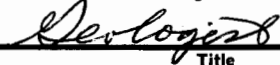
Date Received	 Signature
	 Title
	6-9-80 Date

L5518