

32-11-15W

STATE CORPORATION COMMISSION OF KANSAS
OIL & GAS CONSERVATION DIVISION

WELL COMPLETION OR RECOMPLETION FORM
ACO-1 WELL HISTORY

DESCRIPTION OF WELL AND LEASE

Operator: License # 6854
Name Sohio Petroleum Company
Address 50 Penn Place, Suite 1100
City/State/Zip Oklahoma City, OK 73118

Purchaser Koch-Matador
316-832-5215

Operator Contact Person G. J. Plisga
Phone 405-848-7571

Contractor: License # 7049
Name Rapid Well Service

Wellsite Geologist N/A
Phone

Designate Type of Completion
 New Well Re-Entry Workover
 Oil S.W.D. Temp Abd
 Gas Inj Delayed Comp.
 Dry Other (Core, Water Supply etc.)

If OWWO: old well info as follows:

Operator Grimes-Dieffenbach
Well Name Dodge #4
Comp. Date 8/31/26 Old Total Depth 2880'

WELL HISTORY

Drilling Method:
 Mud Rotary Air Rotary Cable
9/4/85 9/12/85 9/30/85
Spud Date Date Reached TD Completion Date
3189' 3087'
Total Depth PBTD

Amount of Surface Pipe Set and Cemented at 488' feet
Multiple Stage Cementing Collar Used? Yes No
If yes, show depth set.....feet
If alternate 2 completion, cement circulated
from.....feet depth to.....w/.....SX cmt

API NO. 15-167-06191-002

County Russell

NE NW SW Sec. 32 Twp. 11S Rge. 15W East West

2310 Ft North from Southeast Corner of Section
4290 Ft West from Southeast Corner of Section
(Note: Locate well in section plat below)

Lease Name Dodge Well # 4

Field Name Fairport

Producing Formation Plattsmouth, L.K.C.

Elevation: Ground 1762' KB N/A
Section Plat

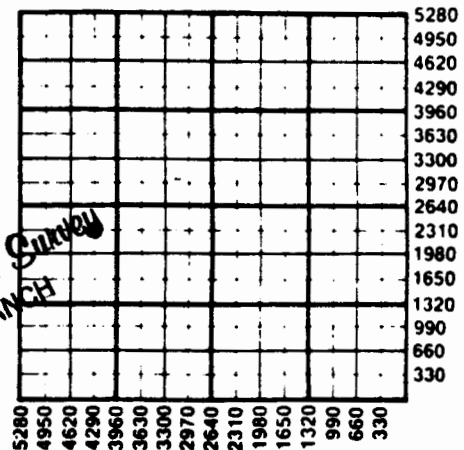

OCT 16 1985
State Geological Survey
WICHITA BRANCH

WATER SUPPLY INFORMATION

Disposition of Produced Water: Disposal Repressuring
Docket # D-24,089

Questions on this portion of the ACO-1 call:
Water Resources Board (913) 296-3717

Source of Water: N/A
Division of Water Resources Permit #

Groundwater.....Ft North from Southeast Corner
(Well)Ft West from Southeast Corner of
Sec Twp Rge East West

Surface Water.....Ft North from Southeast Corner
(Stream, pond etc).....Ft West from Southeast Corner
Sec Twp Rge East West

Other (explain) Provided by contractor....
(purchased from city, R.W.D. #)

INSTRUCTIONS: This form shall be completed in duplicate and filed with the Kansas Corporation Commission, 200 Colorado Derby Building, Wichita, Kansas 67202, within 90 days after completion or recompletion of any well. Rule 82-3-130 and 82-3-107 apply. Information on side two of this form will be held confidential for a period of 12 months if requested in writing and submitted with the form. See rule 82-3-107 for confidentiality in excess of 12 months. One copy of all wireline logs and drillers time log shall be attached with this form. Submit CP-4 form with all plugged wells. Submit CP-111 form with all temporarily abandoned wells.

81812

SIDE TWO

Operator Name Sohio Petroleum Company Lease Name..... Dodge Well #..... 4

Sec..... 32 Twp..... 11 Rge..... 15 East West County..... Russell

WELL LOG

INSTRUCTIONS: Show important tops and base of formations penetrated. Detail all cores. Report all drill stem tests giving interval tested, time tool open and closed, flowing and shut-in pressures, whether shut-in pressure reached static level, hydrostatic pressures, bottom hole temperature, fluid recovery, and flow rates if gas to surface during test. Attach extra sheet if more space is needed. Attach copy of log.

Drill Stem Tests Taken Yes No
Samples Sent to Geological Survey Yes No
Cores Taken Yes No

Formation Description
 Log Sample

All work in cased hole.

Name	Top	Bottom
Topeka	2578	
Heebner	2797	
Toronto	2816	
L-KC	2846	
P.B.T.D.	3087	

Estimated Production Per 24 Hours	Oil	Gas	Water	Gas-Oil Ratio	Gravity
	2 Bbls	MCF	62 Bbls	CFPB	

METHOD OF COMPLETION

Production Interval

Disposition of gas: Vented Open Hole Perforation Sold Other (Specify) 2847'-3068' Used on Lease

CASING RECORD New Used

Report all strings set-conductor, surface, intermediate, production, etc.

Purpose of String	Size Hole Drilled	Size Casing Set (in O.D.)	Weight Lbs/Ft.	Setting Depth	Type of Cement	#Sacks Used	Type and Percent Additives
.....	15 1/2"	488'	N/R	N/R	N/R
Surface	12 1/2"	803'	N/R	N/R	N/R
Intermediate	10"	1401'	N/R	N/R	N/R
.....	8 1/2"	2300'	N/R	N/R	N/R
Liner	6 5/8"	2809'	N/R	N/R	N/R
.....	5 1/2"	3159'	N/R	N/R	N/R

PERFORATION RECORD

Acid, Fracture, Shot, Cement Squeeze Record

Shots Per Foot	Specify Footage of Each Interval Perforated	(Amount and Kind of Material Used)	Depth
4 SPF	2063'-68', 3055'-59', 3036'-42'	Treat w/ 1 bbl per ft. 15% HCL and 5% checker-sol.	
4 SPF	3012-17', 3008-11', 2986-90', 2947-52'		
4 SPF	2932-40', 2922-25', 2900-12', 2891-98'		
4 SPF	2853-59', 2847-51'		

TUBING RECORD

Size 2 3/8" Set At 3070' Packer at

Liner Run Yes No

Date of First Production

Producing Method

9/18/85

Flowing Pumping Gas Lift Other (explain).....