

KANSAS DRILLERS LOG

S. 10 T. 11 R. 17 ^E/_W

API No. 15 State Geological Survey 138
 County WICHITA, BRANCH Number

Loc. C NW NE SE

Operator TGT Petroleum Corp.

County Ellis

Address 209 East William Wichita, Kansas 67202

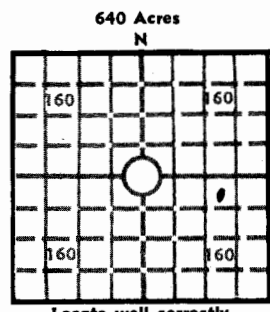

Well No. #1 Lease Name Simpson

Elev.: Gr. 1822'

Footage Location 330 feet from (N) (E) line 990 feet from (E) (W) line

Principal Contractor Dreiling Oil, Inc. Geologist George R. Dent

Spud Date January 17, 1976 Total Depth 3407' P.B.T.D.

DF 1824' KB 1827'

Date Completed Plugged January 23, 1976 Oil Purchaser

CASING RECORD

Report of all strings set — surface, intermediate, production, etc.

Purpose of string	Size hole drilled	Size casing set (in O.D.)	Weight lbs/ft.	Setting depth	Type cement	Sacks	Type and percent additives
Surface Csg.	12-1/4"	8-5/8"	28 lb.	208'	Common	140	

LINER RECORD

PERFORATION RECORD

Top, ft.	Bottom, ft.	Sacks cement	Shots per ft.	Size & type	Depth interval

TUBING RECORD

Size	Setting depth	Packer set at

ACID, FRACTURE, SHOT, CEMENT SQUEEZE RECORD

Amount and kind of material used	Depth interval treated

MAR 17 1976

INITIAL PRODUCTION

Date of first production		Producing method (flowing, pumping, gas lift, etc.)			
RATE OF PRODUCTION PER 24 HOURS		Oil bbls.	Gas MCF	Water bbls.	Gas-oil ratio CFPB
Disposition of gas (vented, used on lease or sold)				Producing interval (s)	

INSTRUCTIONS: As provided in KCC Rule 82-2-125, within 90 days after completion of a well, one completed copy of this Drillers Log shall be transmitted to the State Geological Survey of Kansas, 4150 Monroe Street, Wichita, Kansas 67209. Copies of this form are available from the Conservation Division, State Corporation Commission, 3830 So. Meridian (P.O. Box 17027), Wichita, Kansas 66217. Phone AC 316-522-2206. If confidential custody is desired, please note Rule 82-2-125. Drillers Logs will be on open file in the Oil and Gas Division, State Geological Survey of Kansas, Lawrence, Kansas 66044.

Operator
TGT Petroleum Corporation

DESIGNATE TYPE OF COMP.: OIL, GAS,
DRY HOLE, SWDW, ETC.:
Dry Hole

Well No. 1 Lease Name Simpson

S 10 T 11 R 17 ^X W

WELL LOG

Show all important zones of porosity and contents thereof; cored intervals, and all drill-stem tests, including depth interval tested, cushion used, time tool open, flowing and shut-in pressures, and recoveries.

SHOW GEOLOGICAL MARKERS, LOGS RUN, OR OTHER DESCRIPTIVE INFORMATION.

FORMATION DESCRIPTION, CONTENTS, ETC.	TOP	BOTTOM	NAME	DEPTH
Top Soil	0'	35'	Anhydrite	1036'
Shale	35'	1033'	Heebner	3004'
Anhydrite	1033'	1075'	Toronto	3024'
Shale	1075'	1440'	Lansing	3045'
Shale & Lime	1440'	3080'	Base K/C	3267'
Lime	3080'	3407'	Conglomerate	3371'
			Arbuckle	3401'
			R. T. D.	3407'
<p>DST #1, 3380-3407'</p> <p>Op 30", cl 60", op 90", cl 60". IFF 58, FSI 618, ISI 1153, FSI 1153. Had good blow throughout flow periods. Recovered 1,235' muddy water.</p>				

USE ADDITIONAL SHEETS, IF NECESSARY, TO COMPLETE WELL RECORD.

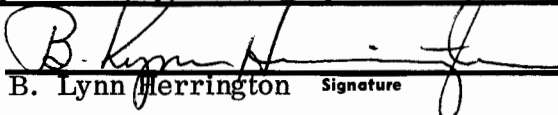
Date Received	 B. Lynn Merrington Signature General Manager Title April 9, 1976 Date
---------------	------------------------------------------------------------------------------------------------------------------------------------------------------------------------------------