

PI

KANSAS

WELL COMPLETION REPORT AND DRILLER'S LOG

API No. 15 — 051 — 22,076
 County Number

Operator
 CHAMPLIN PETROLEUM COMPANY

Address
 6441 N.W. Grand Blvd, Suite 300, Okla. City, OK 73116

Well No. 20 Lease Name Hadley "D"

Footage Location
 1980 feet from (S) line 2640 feet from (E) (W) line

Principal Contractor Red Tiger Drilling Geologist

Spud Date 9-30-80 Date Completed 12-4-80 Total Depth 3615' P.B.T.D. 3411

Directional Deviation Oil and/or Gas Purchaser Koch

S. 17 T. 11S R. 17 W
 Loc. Original Survey
 County Ellis

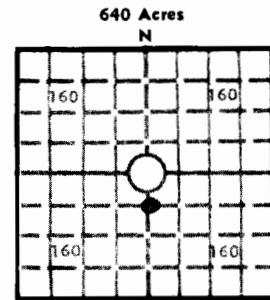

Elev.: Gr. 1875'
 DF KB 1880'

CASING RECORD

Report of all strings set — surface, intermediate, production, etc.

Purpose of string	Size hole drilled	Size casing set (in O.D.)	Weight lbs/ft.	Setting depth	Type cement	Sacks	Type and percent additives
Surface	12-1/4"	8-5/8"	24#	263	Quickset	200	2% gel
Production	7-7/8"	5-1/2"	14#	3614'	50-50 Pozmix	200	18% salt
					Litewate	385	5% Gilsonite/sk

LINER RECORD

PERFORATION RECORD

Top, ft.	Bottom, ft.	Sacks cement	Shots per ft.	Size & type	Depth interval
			2		3468-70'
TUBING RECORD			2	.52"	3434-38'
			2	.52	3417-20'
Size	Setting depth	Packer set at	2		3414+17'
2-7/8"	3387'		2	.52"	3400-06'

ACID, FRACTURE, SHOT, CEMENT SQUEEZE RECORD

Amount and kind of material used	Depth interval treated
Acidized/250 gal. 15% NE acid @ 400#	3468-70'

INITIAL PRODUCTION

Date of first production 12-4-80	Producing method (flowing, pumping, gas lift, etc.) Pumping				
RATE OF PRODUCTION PER 24 HOURS	Oil 14 bbls.	Gas MCF	Water 456 bbls.	Gas-oil ratio CFPB	
Disposition of gas (vented, used on lease or sold) Vented			Producing interval (s) 3400-06'		

INSTRUCTIONS: As provided in KCC Rule 82-2-125, within 90 days after completion of a well, one completed copy of this Drillers Log shall be transmitted to the State Geological Survey of Kansas, 4150 Monroe Street, Wichita, Kansas 67209. Copies of this form are available from the Conservation Division, State Corporation Commission, 245 No. Water, Wichita, Kansas 67202. Phone AC 316-522-2206. If confidential custody is desired, please note Rule 82-2-125. Drillers Logs will be on open file in the Oil and Gas Division, State Geological Survey of Kansas, Lawrence, Kansas 66044.

Operator
CHAMPLIN PETROLEUM COMPANY

DESIGNATE TYPE OF COMP.: OIL, GAS,
DRY HOLE, SWDW, ETC.:
Single Oil

Well No. 20 Lease Name Hadley "D"

S 17 T11S R 17 ^{EX} W

WELL LOG

Show all important zones of porosity and contents thereof; cored intervals, and all drill-stem tests, including depth interval tested, cushion used, time tool open, flowing and shut-in pressures, and recoveries.

SHOW GEOLOGICAL MARKERS, LOGS RUN, OR OTHER DESCRIPTIVE INFORMATION.

FORMATION DESCRIPTION, CONTENTS, ETC.	TOP	BOTTOM	NAME	DEPTH
<u>LOGS</u>				
Acoustilog	1600	3617		
Laterolog	258	3622		
<u>DRILLERS LOG</u>				
Shale & Rock	0	265		
Shale	265	507		
Hard Sand	507	543		
Shale	543	610		
Sand	610	775		
Shale	755	850		
Shale & Red Bed	850	1121		
Anhydrite	1121	1151		
Shale	1151	1650		
Shale & Lime Streaks	1650	2035		
Shale & Lime	2035	2755		
Lime & Shale	2755	2855		
Shale & Lime	2855	2945		
Lime & Shale	2945	3155		
Shale & Lime	3155	3240		
Lime	3240	3615		
RTD		3615		

USE ADDITIONAL SHEETS, IF NECESSARY, TO COMPLETE WELL RECORD.

Date Received

J. S. Lord
Signature

REGULATORY ANALYST
Title

January 13, 1981
Date

86040

DRILLERS LOG

State Geological Survey
WICHITA, BRANCH

No. 20 Hadley "D"

CASING RECORD:	COMPANY:	Champlin Petroleum Company	DESCRIPTION:
8 5/8" @ 251' w/200 sx cement	CONTRACTOR:	Red Tiger Drilling Company	C N/2 S/2 Sec. 17-T11S-R17W Ellis County, Kansas
5 1/2" @ 3,614' w/200 sx cement	COMMENCED:	September 30, 1980	
TOTAL DEPTH: 3,615'	COMPLETED:	October 9, 1980	ELEVATION: 1,895' KB

<u>FORMATION</u>	<u>FROM</u>	<u>TO</u>	<u>REMARKS</u>
Shale & Rock	0	265	
Shale	265	507	
Hard Sand	507	543	
Shale	543	610	
Sand	610	775	
Shale	775	850	
Shale & Red Bed	850	1121	
Anhydrite	1121	1151	
Shale	1151	1650	
Shale & Lime Streaks	1650	2035	
Shale & Lime	2035	2755	
Lime & Shale	2755	2855	
Shale & Lime	2855	2945	
Lime & Shale	2945	3155	
Shale & Lime	3155	3240	
Lime	3240	3615	
RTD		3615	

Certify that this is a true and correct copy of the above log to the best of my knowledge.

RED TIGER DRILLING COMPANY

Gloria Fawcett
Gloria Fawcett

Subscribed and sworn to before me this 14th day of October, 1980.

James A. Baw
Notary Public