

Shel

33-117W

S
P

SIDE ONE

STATE CORPORATION COMMISSION OF KANSAS
OIL & GAS CONSERVATION DIVISION

WELL COMPLETION OR RECOMPLETION FORM
ACO-1 WELL HISTORY

DESCRIPTION OF WELL AND LEASE

Operator: License # 6854
Name Sohio Petroleum Co.
Address 50 Penn Place, Suite 1100
City/State/Zip Oklahoma City, OK 73118

Purchaser N/A

Operator Contact Person G.J. Plisga
Phone 405-848-7571

Contractor: License # 5418
Name Allen Drilling

Wellsite Geologist Steve Brachman
Phone 405-848-7571

Designate Type of Completion

- New Well Re-Entry Workover
- Oil SWD Temp Abd
- Gas Inj Delayed Comp.
- Dry Other (Core, Water Supply etc.)

If ONWO: old well info as follows:

Operator
Well Name
Comp. Date Old Total Depth.....

WELL HISTORY

Drilling Method:

- Mud Rotary Air Rotary Cable

8/16/85 8/23/85 8/30/85
Spud Date Date Reached TD Completion Date

3773' 3677'
Total Depth PBD

Amount of Surface Pipe Set and Cemented at 1,277 feet
Multiple Stage Cementing Collar Used? Yes No
If yes, show depth set.....feet
If alternate 2 completion, cement circulated
from.....feet depth to.....w/.....SX cmt

API NO. 15-051-24269
County Ellis
NE NE NE Sec. 33 Twp. 11 Rge. 17 East West

4950 Ft North from Southeast Corner of Section
405 Ft West from Southeast Corner of Section
(Note: Locate well in section plat below)

Lease Name Bemis Well # F-13

Field Name Bemis

Producing Formation Arbuckle

Elevation: Ground 2030' KB 2048'

Section Plat

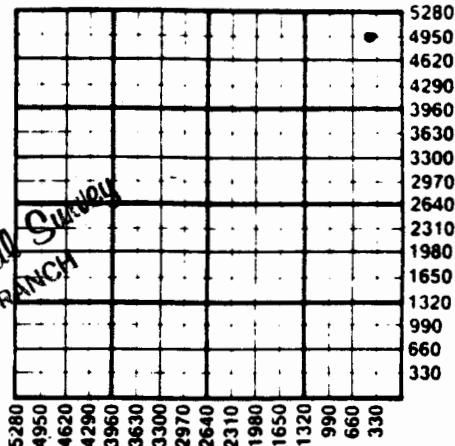

WATER SUPPLY INFORMATION

Disposition of Produced Water: Disposal
Docket # N/A Repressuring

Questions on this portion of the ACO-1 call:

Water Resources Board (913) 296-3717

Source of Water: N/A

Division of Water Resources Permit #.....

Groundwater.....Ft North from Southeast Corner
(Well)Ft West from Southeast Corner of
Sec Twp Rge East West

Surface Water.....Ft North from Southeast Corner
(Stream, pond etc).....Ft West from Southeast Corner
Sec Twp Rge East West

Other (explain) Provided by Contractor
(purchased from city, R.W.D. #)

INSTRUCTIONS: This form shall be completed in duplicate and filed with the Kansas Corporation Commission, 200 Colorado Derby Building, Wichita, Kansas 67202, within 90 days after completion or recompletion of any well. Rule 82-3-130 and 82-3-107 apply.
Information on side two of this form will be held confidential for a period of 12 months if requested in writing and submitted with the form. See rule 82-3-107 for confidentiality in excess of 12 months.
One copy of all wireline logs and drillers time log shall be attached with this form. Submit CP-4 form with

89946

SIDE TWO

Operator Name Sohio Petroleum Co. Lease Name..... Bemis Well #..... F-13

Sec...33..... Twp...11..... Rge...17..... East West County..... Ellis.....

WELL LOG

INSTRUCTIONS: Show important tops and base of formations penetrated. Detail all cores. Report all drill stem tests giving interval tested, time tool open and closed, flowing and shut-in pressures, whether shut-in pressure reached static level, hydrostatic pressures, bottom hole temperature, fluid recovery, and flow rates if gas to surface during test. Attach extra sheet if more space is needed. Attach copy of log.

Drill Stem Tests Taken Yes No
 Samples Sent to Geological Survey Yes No
 Cores Taken Yes No

DST #1: 3533'-3564', IHP 1807 psi, FHP 1749 psi, IFP 39 psi, ISIP 234 psi, FFP 39 psi FSIP 185 psi, Test periods - IF 10 min. ISI 30 min. FF30 min. FSI 30 min.
 D.P. rec. 5' mud. Sample chamber rec. 2200 cc mud.
 DST #2 IHP 1798 psi, IFP 88 psi ISIP 828 psi FFP 88-156 psi, FSIP 799 psi, FHP 1730 psi D.P. rec. 253' water cut mud w/ trace oil. Sampler red. 2200 cc, 90% mud, 8% water, 2% oil. Same times on tests.

Formation Description		
Name	Top	Bottom
Heebner	3232	3236
Toronto	3236	3275
Lansing-KC	3275	3561
Arbuckle	3561	3773

CASING RECORD <input type="checkbox"/> New <input type="checkbox"/> Used							
Report all strings set-conductor, surface, intermediate, production, etc.							
Purpose of String	Size Hole Drilled	Size Casing Set (in O.D.)	Weight Lbs/Ft.	Setting Depth	Type of Cement	#Sacks Used	Type and Percent Additives
Surface	12 1/4"	8 5/8"	24# K-55	1277	HCL	350	3% cc 1/4" flocc
Intermediate	7 7/8"	5 1/2"	14# J-55	3772	Class "A"	130	.75% Halad-322, 18% salt, 5% calsea
PERFORATION RECORD				Acid, Fracture, Shot, Cement Squeeze Record			
Shots Per Foot	Specify Footage of Each Interval Perforated			(Amount and Kind of Material Used)			Depth
4	3589-92			500 gal 15% Fe acid			
4	3562-69						
TUBING RECORD				Liner Run <input type="checkbox"/> Yes <input type="checkbox"/> No			
N/A	Size	Set At	Packer at				

1/4# 5K flosea