

3-11-18W

State Geological Survey  
WICHITA, BRANCH

KANSAS DRILLERS LOG

API No. 15 — 051 — 20,908  
County Number

S. 3 T. 11 R. 18 E  
Loc. 2400 FNL 1481 FEL

County Ellis

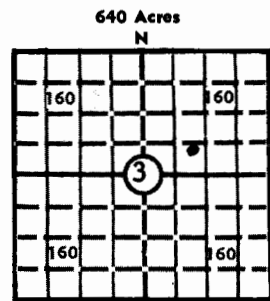

Locate well correctly  
Elev.: Gr. 2082  
DF -- KB 2087

Operator  
**Continental Oil Co.**

Address  
**3535 N. W. 58th Street  
Oklahoma City, Oklahoma**

Well No. **#13** Lease Name **Warren Mortgage**

Footage Location  
**2400** feet from (N) ~~XX~~ line **1481** feet from (E) ~~XX~~ line

Principal Contractor **Garvey Drilling Co.** Geologist **Paul Willis**

Spud Date **7-26-73** Total Depth **3703** P.B.T.D. **D&A**

Date Completed **8-7-73** Oil Purchaser

CASING RECORD

Report of all strings set — surface, intermediate, production, etc.

Purpose of string	Size hole drilled	Size casing set (in O.D.)	Weight lbs/ft.	Setting depth	Type cement	Sacks	Type and percent additives
Surface	12 1/4"	8 5/8"	24#	259'	Class "A"	200	2% Gel & 2% CaCl <sup>2</sup>

LINER RECORD

PERFORATION RECORD

Top, ft.	Bottom, ft.	Sacks cement	Shots per ft.	Size & type	Depth interval

Size	Setting depth	Packer set at

ACID, FRACTURE, SHOT, CEMENT SQUEEZE RECORD

Amount and kind of material used	Depth interval treated

INITIAL PRODUCTION

Date of first production \_\_\_\_\_ Producing method (flowing, pumping, gas lift, etc.) \_\_\_\_\_

RATE OF PRODUCTION PER 24 HOURS	Oil	Gas	Water	Gas-oil ratio
	bbls.	MCF	bbls.	CFPB

Disposition of gas (vented, used on lease or sold) \_\_\_\_\_ Producing interval (s) \_\_\_\_\_

INSTRUCTIONS: As provided in KCC Rule 82-2-125, within 90 days after completion of a well, one completed copy of this Drillers Log shall be transmitted to the State Geological Survey of Kansas, 4150 Monroe Street, Wichita, Kansas 67209. Copies of this form are available from the Conservation Division, State Corporation Commission, 3830 So. Meridian (P.O. Box 17027), Wichita, Kansas 66217. Phone AC 316-522-2206. If confidential custody is desired, please note Rule 82-2-125. Drillers Logs will be on open file in the Oil and Gas Division, State Geological Survey of Kansas, Lawrence, Kansas 66044.

Operator **Continental Oil Company** DESIGNATE TYPE OF COMP.: OIL, GAS, DRY HOLE, SWDW, ETC.:

Well No. **13** Lease Name **Warren Mortgage Inv. Co.** **Dry Hole**

S 3 T 11 S 18 R XEX W

**WELL LOG**

Show all important zones of porosity and contents thereof; cored intervals, and all drill-stem tests, including depth interval tested, cushion used, time tool open, flowing and shut-in pressures, and recoveries.

SHOW GEOLOGICAL MARKERS, LOGS RUN, OR OTHER DESCRIPTIVE INFORMATION.

FORMATION DESCRIPTION, CONTENTS, ETC.	TOP	BOTTOM	NAME	DEPTH
Lansing-Kansas City Lime No tests (oil-water)	3305	3527	Heebner L-KC	3263 3305
Simpson Dolomite DST #1 (3617-37) IFP-30", ISIP-45", FFP-90", FSIP 120", IFP-85 psi, ISIP-85 psi, FFP-34-77 psi, FSIP-85 psi, Recovered 100' SOCWM	3616	3620	Simpson Arbuckle	3616 3636
Arbuckle Dolomite DST #2 (3640'-58') IFP-5", ISIP-30", FFP-60", FSIP-60", IFP-26-122 psi, ISIP-813 psi, FFP-122-603 psi, FSIP-734 psi. Recovered 1300' MW	3636	3700		
Well D&A in accordance with State Corporation Commission Rules.				

USE ADDITIONAL SHEETS, IF NECESSARY, TO COMPLETE WELL RECORD.

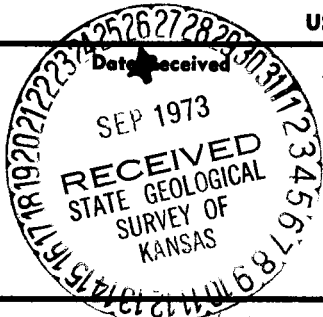

*Thomas R. Smith*  
Signature  
*Engineer*  
Title  
*8/8/73*  
Date

107028

# WELL LOG

3-11-18W

COMPANY Continental Oil Company

FARM Warren Mortge. Inv. No. 13  
Co.

TOTAL DEPTH 3702'

COMM. 7-26-73 COMP. 8-4-73

CONTRACTOR Garvey Drilling Company

CASING  
8 5/8" @ 258' w/200sx

RECEIVED  
AUG 9 1973  
GARVEY DRILG CO.  
WICHITA, KANSAS

SEC. 3 T. 11S R. 18W

LOC. 2400' FNL & 1650' FWL

COUNTY Ellis, Kansas

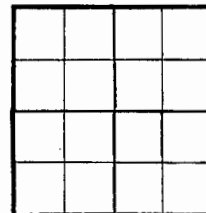

ELEVATION

PRODUCTION Temporary Abandoned

FIGURES INDICATE BOTTOM OF FORMATIONS

600' Shale  
1280' Shale & Sand  
1385' Shale  
1416' Anhydrite  
1910' Shale  
2230' Shale & Lime  
2745' Lime & Shale  
3440' Lime  
3600' Conglomerate  
3630' Arbuckle  
3702' Arbuckle  
3702' RTD

