

KANSAS *PI*

WELL COMPLETION REPORT AND DRILLER'S LOG

State Geological Survey
WICHITA BRANCH

API No. 15 - 051 - 2231
County Number

S. 5 T. 11 R. 18 W
Loc. C-SE-NW
County Ellis

Operator Kenny Brown Enterprises

Address Drawer 340 Plainville Kans

Well No. 2 Lease Name Saline River Grazing

Footage Location
660 feet from (S) line 660 feet from (E) line

Principal Contractor Drilling Oil Co Geologist Tony Gray

Spud Date 3-2-81 Date Completed 3-7-81 Total Depth 3575 P.B.T.D.

Directional Deviation Oil and/or Gas Purchaser W. Kach

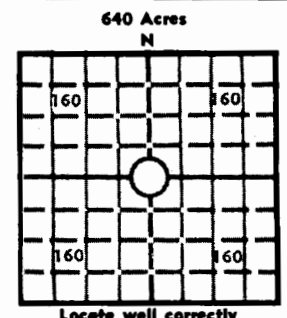

Locate well correctly
Elev.: Gr. 2070
DF 2072 KB 2075

CASING RECORD

Report of all strings set — surface, intermediate, production, etc.

Purpose of string	Size hole drilled	Size casing set (in O.D.)	Weight lbs/ft.	Setting depth	Type cement	Sacks	Type and percent additives
<u>Surface</u>	<u>12 1/4</u>	<u>8 7/8</u>	<u>20 #</u>	<u>170</u>	<u>allied quick set</u>	<u>130</u>	
<u>Oil</u>	<u>7 7/8</u>	<u>4 1/2</u>	<u>10 1/2 #</u>	<u>3573</u>	<u>60 1/4 Portland</u>	<u>175</u>	

LINER RECORD

PERFORATION RECORD

Top, ft.	Bottom, ft.	Sacks cement	Shots per ft.	Size & type	Depth interval

Size	Setting depth	Packer set at

ACID, FRACTURE, SHOT, CEMENT SQUEEZE RECORD

Amount and kind of material used	Depth interval treated

INITIAL PRODUCTION

Date of first production 4-16-81 Producing method (flowing, pumping, gas lift, etc.) Pumping

RATE OF PRODUCTION PER 24 HOURS	Oil <u>35</u> bbls.	Gas <u>50</u> MCF	Water <u>50</u> bbls.	Gas-oil ratio	CFPB
---------------------------------	---------------------	-------------------	-----------------------	---------------	------

Disposition of gas (vented, used on lease or sold) Producing interval (s) KE 3442 to 3530

INSTRUCTIONS: As provided in KCC Rule 82-2-125, within 90 days after completion of a well, one completed copy of this Drillers Log shall be trans- mitted to the State Geological Survey of Kansas, 4150 Monroe Street, Wichita, Kansas 67209. Copies of this form are available from the Conservation Division, State Corporation Commission, 245 No. Water, Wichita, Kansas 67202. Phone AC 316-522-2206. If confidential custody is desired, please note Rule 82-2-125. Drillers Logs will be on open file in the Oil and Gas Division, State Geological Survey of Kansas, Lawrence, Kansas 66044.

Operator Benny Brown Enterprises DESIGNATE TYPE OF COMP.: OIL, GAS, DRY HOLE, SWDW, ETC.: Oil

Well No. 2 Lease Name Saline River Grazing Co

S 5 T 11 R 18 W

WELL LOG

Show all important zones of porosity and contents thereof; cored intervals, and all drill-stem tests, including depth interval tested, cushion used, time tool open, flowing and shut-in pressures, and recoveries.

SHOW GEOLOGICAL MARKERS, LOGS RUN, OR OTHER DESCRIPTIVE INFORMATION.

FORMATION DESCRIPTION, CONTENTS, ETC.	TOP	BOTTOM	NAME	DEPTH
<p>There was no tests or Electric Logs</p>	1396		Anky	
	3051		Jafeka	
	3272		Heebna	
	3287		Toranto	
	3312		L X C	
	3549		Base X C	

USE ADDITIONAL SHEETS, IF NECESSARY, TO COMPLETE WELL RECORD.

Date Received

Benny Brown
Signature

Owner
Title

4-27-81
Date

06088

PT

DREILING OIL, INC.

Victoria, Kansas 67671

State Geological Survey
WICHITA BRANCH

WELL LOG

Company **Kenny Brown Enterprises**
 P. O. Drawer 340
 Plainville, KS 67663

Farm Saline ~~Valley~~ ^{Blue} Grazing No. 2

Total Depth 3575'

Comm. 3-2-81 Comp. 3-7-81

Contractor **Dreiling Oil, Inc.**
 Rt. #1
 Victoria, KS 67671

Sec. 5 Twp. 11 Rng. 18

Location C SE NW

County Ellis

Elevation: 2075' **K. B.**
 2072' **D. F.**
 2070' **G. R.**

Casing Record
 170' - 8 5/8"
 3574' - 4 1/2"

Cement Record
 130 sacks cement
 175 sacks cement

Production:

Figures Indicate Bottom of Formations

0'	80'	Post Rock
80'	174'	Shale
174'	390'	Shale
390'	880'	Shale
880'	1070'	Sand
1070'	1073'	Shale
1073'	1396'	Shale
1396'	1436'	Anhy.
1436'	1676'	Shale
1676'	2035'	Shale
2035'	2300'	Shale & Lime
2300'	2503'	Lime
2503'	2693'	Lime & Shale
2693'	2963'	Shale & Lime
2963'	3131'	Lime
3131'	3248'	Lime
3248'	3367'	Lime
3367'	3480'	Lime
3480'	3575'	Lime
3575'	T.D.	

STATE OF KANSAS)
)ss
 COUNTY OF ELLIS)

I, Patty Dreiling, of Dreiling Oil, Inc., upon oath states that the above and foregoing is a true and correct copy from the Daily Drilling Report from the Saline Valley Grazing #2.

Patty Dreiling
 Patty Dreiling