

**State Geological Survey**  
**KANSAS DRILLERS LOG**  
 WICHITA, BRANCH

S. 18 T. 11 R. 18 <sup>R</sup>/<sub>W</sub>  
 Loc. NW NW NE 100' W  
 County Ellis

API No. 15 — 051 — 21,219  
 County Number

Operator  
Robert R. Price

Address  
Box 45442 Tulsa, Oklahoma 74145

Well No. #1 Lease Name Frisbie

Footage Location  
330 feet from (N) line 230' feet from (W) line

Principal Contractor Allen Drilling Co. Geologist Robert Price

Spud Date 10-4-76 Total Depth 3520 P.B.T.D.

Date Completed 10-10-76 Oil Purchaser

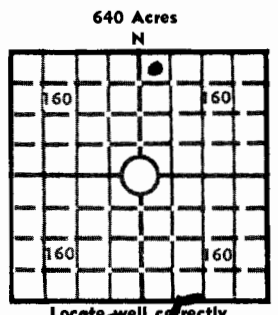

Locate well correctly  
 Elev.: Gr. 1908  
 DF 1908 KB 1908

**CASING RECORD**

Report of all strings set— surface, intermediate, production, etc.

Purpose of string	Size hole drilled	Size casing set (in O.D.)	Weight lbs/ft.	Setting depth	Type cement	Sacks	Type and percent additives
<u>Surface</u>	<u>12 1/4"</u>	<u>8 5/8"</u>	<u>24#</u>	<u>258'</u>	<u>Common</u>	<u>175</u>	<u>2% Gel</u> <u>3% CaCl</u>

**LINER RECORD**

**PERFORATION RECORD**

Top, ft.	Bottom, ft.	Sacks cement	Shots per ft.	Size & type	Depth interval

**TUBING RECORD**

Size	Setting depth	Packer set at

**ACID, FRACTURE, SHOT, CEMENT SQUEEZE RECORD**

Amount and kind of material used	Depth interval treated

**INITIAL PRODUCTION**

Date of first production		Producing method (flowing, pumping, gas lift, etc.)			
RATE OF PRODUCTION PER 24 HOURS	Oil	Gas	Water	Gas-oil ratio	CFPB
Disposition of gas (vented, used on lease or sold)			Producing interval(s)		

INSTRUCTIONS: As provided in KCC Rule 82-2-125, within 90 days after completion of a well, one completed copy of this Drillers Log shall be transmitted to the State Geological Survey of Kansas, 4150 Monroe Street, Wichita, Kansas 67209. Copies of this form are available from the Conservation Division, State Corporation Commission, 3830 So. Meridian (P.O. Box 17027), Wichita, Kansas 66217. Phone AC 316-522-2206. If confidential custody is desired, please note Rule 82-2-125. Drillers Logs will be on open file in the Oil and Gas Division, State Geological Survey of Kansas, Lawrence, Kansas 66044.

Operator

Robert R. Price

DESIGNATE TYPE OF COMP.: OIL, GAS, DRY HOLE, SWPW, ETC.:

Dry Hole

Well No.

1

Lease Name

Frisbie

S 18 T 11 S R 18 W

WELL LOG

Show all important zones of porosity and contents thereof; cored intervals, and all drill-stem tests, including depth interval tested, cushion used, time tool open, flowing and shut-in pressures, and recoveries.

SHOW GEOLOGICAL MARKERS, LOGS RUN, OR OTHER DESCRIPTIVE INFORMATION.

FORMATION DESCRIPTION, CONTENTS, ETC.	TOP	BOTTOM	NAME	DEPTH
DST #1 3160-3220			Anhydrite	1238'
ISIP 1084"			Topeka	2905'
KSIP 1064"			Heebner	3130'
Recovered 90' W.M.			Toronto	3151'
			Lansing	3171'
			D/KC	3400'
			Conglomerate	3426'
			Arkuckle	3516'
			T.D.	3520'

USE ADDITIONAL SHEETS, IF NECESSARY, TO COMPLETE WELL RECORD.

Date Received

Robert R. Price

Signature

Operator

Title

10-11-76

Date

928178