

KANSAS CORPORATION COMMISSION

WELL RECORD

(Mail to Kansas Geological Survey, 4150 Monroe Street, Wichita, Kansas 67209)

20-11-19W

API-15-051-20,810

L

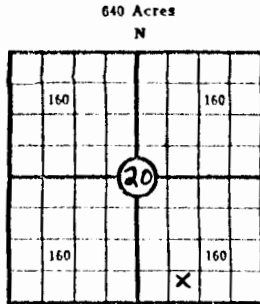

Locate well correctly

Lease Name: HAGEN Well No. 2
 Well Located: Approx. C SE SW SE
 County: Ellis SEC 20 TWP 11S RGE 19W
 Operator: Abercrombie Drilling, Inc.
 Address: 801 Union Center, Wichita, Kansas 67202
 Elevation: Ground 1957 D.F. 1963 K.B. 1965
 Type Well: (Oil, gas, dry hole) Dry Hole

Drilling Commenced: March 2, 1972 Drilling Completed: March 10, 1972
 Well Completed: 19 Total Depth 3541'
 Initial Production: D & A

Casing Record

Size: 7" Set at 1116' Size: _____ Set at _____
 Size: _____ Set at _____ Size: _____ Set at _____

Set 31 joints of 7" surface casing set at 1108' w/175 sx. common cement, 2% gel and 150 sx. Sunset cement. Cement circulated. Plug was down at 11:30 a.m. 3-2-72.
Dry and Abandoned.

Contractor's record

Size: _____ Set from _____ To _____

Cementing

Casing Size	Sacks	Type Cement and Additives
7"	325	175 sx. common 2% gel
		150 sx. Sunset

Perforations

Formation	Perforated Interval and Number Shots

Electric Log Run (Show type log and depths covered)

None

cont.
20-11-19w

Show Drill Stem Tests,
Well Stimulation and
Production Tests

Formation	Top	Bottom	
Lansing-K.C.	3378'	3415'	10" - 30" - 30" - 30" Weak blow for 15" then died. Rec. 10' mud. IFP 21-21#, IBHP 213#, FFP 21-21# FBHP 27#.
Arbuckle	3521	3535	20" - 30" - 120" - 45" Fair to weak blow, died in 80" Rec. 120' V.H. black oil (15° gravity) IFP 53-59#, IBHP 690# FFP 74-91#, FBHP 518#. BHT 121°
Arbuckle	3536	3541	20" - 45" - 60" - 60" Rec. 30' muddy water, 30' H. black oil IFP 6-6#, IBHP 1010# FFP 17-21#, FBHP 909#. BHT 123°.

0	50	Sand & Rock
50	485	Shale & Shells
485	547	Shale
547	578	Sand
578	765	Shale
765	975	Sand
975	1299	Shale
1299	1340	Anhydrite
1340	1770	Shale
1770	2455	Shale & Lime
2455	3080	Lime & Shale
3080	3210	Lime
3210	3390	Lime & Shale
3390	3535	Lime
3535	3541	Arbuckle
	3541	Rotary Total Depth

<u>SAMPLE TOPS</u>		<u>ELEVATION</u>	
Anhydrite	1299 (+ 666)	1965 K.B.	
B/Anhydrite	1340 (+ 625)	1963 D.F.	
Heebner	3191 (-1226)	1957 G.L.	
Toronto	3212 (-1247)		
Lansing	3232 (-1267)		
B/K.C.	3451 (-1486)		
Conglomerate	3479 (-1514)		
Arbuckle	3531 (-1566)		
Rotary Total Depth	3541 (-1576)		
		<u>SMP TOPS DEPTH</u>	
		ANHY	1299
		B ANHY	1340
		HEEB	3191
		TOR	3212
		LANS	3232
		BKC	3451
		CONG	3479
		RTD	3541

OH088