

**KANSAS DRILLERS LOG**

S. 34 T. 11 R. 19 <sup>N</sup>/<sub>W</sub>

Loc. NE SW NW

County Ellis

API No. 15 — 051 — 21,458  
County Number

Operator  
Staab-Dreiling Oil Operations

Address  
Catherine Route, Box 39 Hays, Kansas 67601

Well No. #1 Lease Name Jensen

Footage Location  
990 feet from (S) line 1070 feet from (W) line

Principal Contractor Helberg Geologist Jerry J.R. Green & Green

Spud Date 3-16-78 Total Depth 3639 P.B.T.D.

Date Completed 3-29-78 Oil Purchaser Clearcreek

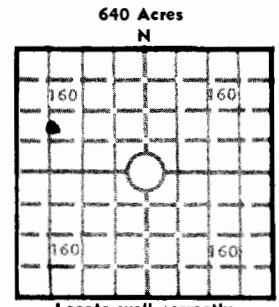

Elev.: Gr. 2061

DF 2063 KB 2066

**CASING RECORD**

Report of all strings set — surface, intermediate, production, etc.

Purpose of string	Size hole drilled	Size casing set (in O.D.)	Weight lbs/ft.	Setting depth	Type cement	Sacks	Type and percent additives
Surface		8 5/8	14	168	Common	100	
Production		5 1/2	16	3637	Pos mix Common	70 105	Salt 2000 lbs Gel 300 lbs

**LINER RECORD**

**PERFORATION RECORD**

Top, ft.	Bottom, ft.	Sacks cement	Shots per ft.	Size & type	Depth interval
			4	FP	3276 1/2 - 3278 1/2

**TUBING RECORD**

Size	Setting depth	Packer set at
2 3/8	3521	3525

**ACID, FRACTURE, SHOT, CEMENT SQUEEZE RECORD**

Amount and kind of material used	Depth interval treated
Acid 1,000 gal 28% 600 gal mud Acid	3276 1/2 - 3278 1/2

**INITIAL PRODUCTION**

Date of first production <u>April 28, 1978</u>		Producing method (flowing, pumping, gas lift, etc.)			
RATE OF PRODUCTION PER 24 HOURS	Oil <u>12</u> bbls.	Gas <u>8</u> bbls.	Water <u>8</u> bbls.	Gas-oil ratio	CFPB
Disposition of gas (vented, used on lease or sold)			Producing interval (s)		

INSTRUCTIONS: As provided in KCC Rule 82-2-125, within 90 days after completion of a well, one completed copy of this Drillers Log shall be transmitted to the State Geological Survey of Kansas, 4150 Monroe Street, Wichita, Kansas 67209. Copies of this form are available from the Conservation Division, State Corporation Commission, 3830 So. Meridian (P.O. Box 17027), Wichita, Kansas 66217. Phone AC 316-522-2206. If confidential custody is desired, please note Rule 82-2-125. Drillers Logs will be on open file in the Oil and Gas Division, State Geological Survey of Kansas, Lawrence, Kansas 66044.

DESIGNATE TYPE OF COMP.: OIL, GAS, DRY HOLE, SWDW, ETC.:

Operator *Staagb-Drilling Oil Operations*

Well No. *# 1* Lease Name *Jensen*

*Oil*

S \_\_\_ T \_\_\_ R \_\_\_ E \_\_\_ W

**WELL LOG**

Show all important zones of porosity and contents thereof; cored intervals, and all drill-stem tests, including depth interval tested, cushion used, time tool open, flowing and shut-in pressures, and recoveries.

SHOW GEOLOGICAL MARKERS, LOGS RUN, OR OTHER DESCRIPTIVE INFORMATION.

FORMATION DESCRIPTION, CONTENTS, ETC.	TOP	BOTTOM	NAME	DEPTH
<i>Heebner</i> <i>-1195</i> <i>3261</i>				
<i>Toronto</i> <i>-1210</i> <i>3276</i>				
<i>Lansing-KC</i> <i>-1236</i> <i>3302</i>				
<i>KC Base</i> <i>-1464</i> <i>3530</i>				
<i>Arbuckle</i> <i>-1522</i> <i>3588</i>				

USE ADDITIONAL SHEETS, IF NECESSARY, TO COMPLETE WELL RECORD.

Date Received

Signature

Title

Date

DRILLERS LOG

JENSEN #1

CASING RECORD:

8 5/8" set at 168'

TOTAL DEPTH:

3638'

OPERATOR: Staab-Dreiling Oil Operations

CONTRACTOR: Helberg Oil Company

COMMENCED: March 16, 1978

COMPLETED: March 29, 1978

DESCRIPTION:

NE SW NW  
Sec. 34-11s-19w Ellis County, Kansas

<u>FORMATION</u>	<u>FROM</u>	<u>TO</u>	<u>REMARKS</u>
Shale & Sand	0	168	
Shale & Sand	168	183	
Shale & Sand	183	872	
Sand & Shale	872	1357	
Anhydrite	1357	1373	
Anhydrite	1373	1402	
Shale	1402	1555	
Shale	1555	1819	
Shale	1819	2023	
Shale	2023	2158	
Shale	2158	2250	
Shale	2250	2363	
Shale	2363	2467	
Shale	2467	2590	
Shale	2590	2670	
Shale	2670	2748	
Shale	2748	2854	
Shale	2854	2914	
Lime & Shale	2854	2968	
Shale & Lime	2968	3043	
Lime & Shale	3043	3074	
Lime	3074	3088	
Lime	3088	3138	
Lime	3138	3186	
Lime	3186	3235	
Lime	3235	3266	
Lime	3266	3280	
Lime	3280	3294	
Lime	3294	3299	
Lime	3299	3349	
Lime & Shale	3349	3385	
Lime	3385	3414	
Lime	3413	3456	
Lime	3456	3500	
Lime	3500	3535	
Lime	3535	3575	
Lime	3575	3585	
Lime	3585	3596	
Lime	3596	3638	
T.D.	3638		Run Casing