

WICHITA BRANCH
KANSAS DRILLERS LOG

IMPORTANT
Kans. Geo. Survey request
samples on this well.

S. 5 T. 11 R. 22 ^K/_W
Loc. NW SW SW
County Trego

API No. 15 — 195 — 20,472
County Number

Operator
A. Scott Ritchie

Address
950 Vickers KSB&T Building Wichita, Kansas 67202

Well No. #1 Lease Name Baughman

Footage Location
feet from (N) (S) line _____ feet from (E) (W) line _____

Principal Contractor Murfin Drilling Co. Geologist Roger Welty

Spud Date 5/05/78 Total Depth 3770' P.B.T.D. _____

Date Completed 5/11/78 Oil Purchaser none

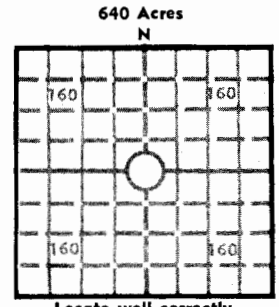

Elev.: Gr. 2244'
DF _____ KB 2249'

CASING RECORD

Report of all strings set — surface, intermediate, production, etc.

Purpose of string	Size hole drilled	Size casing set (in O.D.)	Weight lbs/ft.	Setting depth	Type cement	Sacks	Type and percent additives
surface	12 1/4"	8 5/8"	28#	184'	common	140	quickset

LINER RECORD

PERFORATION RECORD

Top, ft.	Bottom, ft.	Sacks cement	Shots per ft.	Size & type	Depth interval

TUBING RECORD

Size	Setting depth	Packer set at

ACID, FRACTURE, SHOT, CEMENT SQUEEZE RECORD

Amount and kind of material used	Depth interval treated

INITIAL PRODUCTION

Date of first production _____		Producing method (flowing, pumping, gas lift, etc.) _____			
RATE OF PRODUCTION PER 24 HOURS	Oil _____ bbls.	Gas _____ MCF	Water _____ bbls.	Gas-oil ratio _____ CFPB	
Disposition of gas (vented, used on lease or sold) _____			Producing interval (s) _____		

INSTRUCTIONS: As provided in KCC Rule 82-2-125, within 90 days after completion of a well, one completed copy of this Drillers Log shall be transmitted to the State Geological Survey of Kansas, 4150 Monroe Street, Wichita, Kansas 67209. Copies of this form are available from the Conservation Division, State Corporation Commission, 3830 So. Meridian (P.O. Box 17027), Wichita, Kansas 66217. Phone AC 316-522-2206. If confidential custody is desired, please note Rule 82-2-125. Drillers Logs will be on open file in the Oil and Gas Division, State Geological Survey of Kansas, Lawrence, Kansas 66044.

94032

Operator A. Scott Ritchie		DESIGNATE TYPE OF COMP.: OIL, GAS, DRY HOLE, SWDW, ETC.: dry hole
Well No. 1	Lease Name Baughman	
S 15 T 11 S R 22 ^{EX} _W		

WELL LOG

Show all important zones of porosity and contents thereof; cored intervals, and all drill-stem tests, including depth interval tested, cushion used, time tool open, flowing and shut-in pressures, and recoveries.

SHOW GEOLOGICAL MARKERS, LOGS RUN, OR OTHER DESCRIPTIVE INFORMATION.

FORMATION DESCRIPTION, CONTENTS, ETC.	TOP	BOTTOM	NAME	DEPTH
DST #1 3590-3606' Rec. 5' mud. IFP 32#/20"; ISIP 65#/30"; FFP 32#/20"; FSIP 32#/30".				
DST #2 3645'-3675' Rec. 2' mud. IFP 44#/20"; ISIP 197#/30"; FFP 44#/20"; FSIP 87#/30".				
DST #3 3674'-3712' Rec. 840' muddy salt water. FP 55-440#/60"; ISIP 778#/45"; FSIP 769#/45".				
DST #4 3712'-3740' Rec. 10' mud. IFP 44#/20"; ISIP 55#/30"; FFP 44#/20"; FSIP 44#/30".				
			NO ELECTRIC LOG RAN	

USE ADDITIONAL SHEETS, IF NECESSARY, TO COMPLETE WELL RECORD.

Date Received	<i>F. Johnson Hippa</i>	
	Signature	
	Geologist	
	Title	
	May 24, 1978	
	Date	

COMPANY A. Scott Ritchie

SEC. 5 T. 11S R. 22W

FARM BAUGHMAN NO. 1

LOC. NW SW SW

RIG. NO. 16

TOTAL DEPTH 3770'

COUNTY Trego
KANSAS

COMM. 5-5-78

COMP. 5-12-78

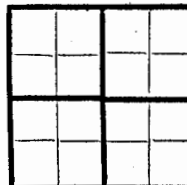

CONTRACTOR Murfin Drilling Company

CASING

20	10	
15		8-5/8" @ 184' w/140 sx.
12	6	
13	5	

ELEVATION

PRODUCTION

FIGURES INDICATE BOTTOM OF FORMATIONS

100'	Surface soil, sand & Shale
185'	Shale
630'	Shale & Sand
1230'	Clay & Shale
1470'	Sand
1510'	Shale & Red Beds
1719'	Shale
1766'	Anhydrite
1935'	Shale
2430'	Shale & Sand
3395'	Shale
3606'	Shale & Lime
3675'	Lime & Shale
3770'	Lime RTD