

KANSAS CORPORATION COMMISSION

WELL RECORD

(Mail to Kansas Geological Survey, 4150 Monroe Street, Wichita, Kansas 67209)

6-11-22W

API # 15-195-20,227

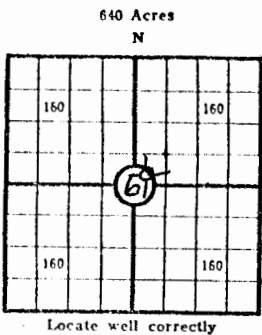

Lease Name: McCall Well No. 1
 Well Located: Trego County, Kansas
SW SW NE SEC 6 TWP 11S RGE 22W
 Operator: Mack Oil Company
 Address: 812 Union Center, Wichita, KS 67202
 Elevation: Ground 2262' D.F. 2267' K.B. 2269'
 Type Well: (Oil, gas, dry hole) dry hole

Drilling Commenced: 7-24 1972 Drilling Completed: 7-30- 1972
 Well Completed: 7-31 1972 Total Depth 3995' LTD
 Initial Production: D & A

Casing Record

Size: 8 5/8" Set at 220' Size: _____ Set at _____
 Size: _____ Set at _____ Size: _____ Set at _____

Liner Record

Size: _____ Set from _____ To _____

Cementing

<u>Casing Size</u>	<u>Sacks</u>	<u>Type Cement and Additives</u>
<u>8 5/8"</u>	<u>150 sx</u>	<u>pozmix, 3% HA-5</u>
_____	_____	_____
_____	_____	_____

Perforations

<u>Formation</u>	<u>Perforated Interval and Number Shots</u>
_____	_____
_____	_____
_____	_____
_____	_____

Electric Log Run (Show type log and depths covered)

Laterolog-Gamma Ray-Neutron 222' - 3994'

(Fill in formation and related information on reverse side)

904

FORMATION, TESTING AND COMPLETION RECORD

Cont. 6-11-22a

Show Drill Stem Tests,
Well Stimulation and
Production Tests

Formation	Top	Bottom
Shale	0	222
Shale & Shells	222	966
Sand	966	1478
Shale	1478	1980
Shale & Lime	1980	2387
Shale & Shells	2387	2646
Shale & Lime	2646	2879
Lime	2879	3990

no tests