

PI

Released 9/28/81
 AUG 8 0 REC'D
 State Geological Survey
 WICHITA BRANCH

KANSAS DRILLERS LOG

S. 7 T. 11S R. 22 E
 W
 Loc. NW SW SE
 County Trego

API No. 15 — 195 — 20,649
 County Number

Operator
 A. Scott Ritchie

Address Suite 950- 125 N. Market, Wichita, KS 67202

Well No. 1 Lease Name Buchholz "B"

Footage Location
 990 feet from (N) (S) line 330 feet from (E) (W) line SE/4

Principal Contractor Geologist
 Murfin Drilling Co. Roger Fisher

Spud Date Total Depth P.B.T.D.
 June 13, 1980 3932'

Date Completed Oil Purchaser
 August 5, 1980 Clear Creek

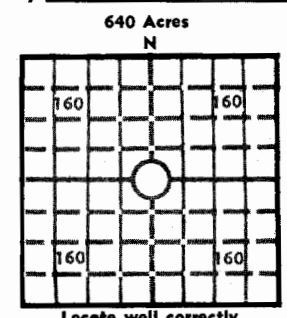

Locate well correctly
 Elev.: Gr. 2226'
 DF KB 2231'

CASING RECORD

Report of all strings set — surface, intermediate, production, etc.

Purpose of string	Size hole drilled	Size casing set (in O.D.)	Weight lbs/ft.	Setting depth	Type cement	Sacks	Type and percent additives
surface	12 1/4"	8-5/8"	24-28#	191'	quickset	160	
production		4 1/2"		3927'	60/40 pozmix	175	10% salt

LINER RECORD

PERFORATION RECORD

Top, ft.	Bottom, ft.	Sacks cement	Shots per ft.	Size & type	Depth interval
			2 SSB jets		3594'-3598'
					3581'-3585'
					3572'-3576'
					3555'-3558'
					3539'-3542'

TUBING RECORD

Size	Setting depth	Packer set at	Depth interval
			3500'-3506'
			3690'-3694'

ACID, FRACTURE, SHOT, CEMENT SQUEEZE RECORD

Amount and kind of material used	Depth interval treated
1000 gal. I.N.S. & 1000 gal. 28% acid	3906'-3911'
500 gal. MCA	3824'-3844'
1500 gal. 28% acid	3690'-3694'
2500 gal. 28% acid	3596', 3584', 3573 1/2'
2000 gal. 28% acid	3556', 3540'
1200 gal. 28% acid	3500'-3506'

INITIAL PRODUCTION

Date of first production August 5, 1980	Producing method (flowing, pumping, gas lift, etc.) swabbed; will be pumping
RATE OF PRODUCTION PER 24 HOURS	Oil 80 bbls. Gas MCF 20% bbls. Water Gas-oil ratio CFPB
Disposition of gas (vented, used on lease or sold)	Producing interval (s) see perforation record

INSTRUCTIONS: As provided in KCC Rule 82-2-125, within 90 days after completion of a well, one completed copy of this Drillers Log shall be transmitted to the State Geological Survey of Kansas, 4150 Monroe Street, Wichita, Kansas 67209. Copies of this form are available from the Conservation Division, State Corporation Commission, 3830 So. Meridian (P.O. Box 17027), Wichita, Kansas 66217. Phone AC 316-522-2206. If confidential custody is desired, please note Rule 82-2-125. Drillers Logs will be on an open file in the Oil and Gas Division, State Geological Survey of Kansas, Lawrence, Kansas 66044.

Operator A. Scott Ritchie		DESIGNATE TYPE OF COMP.: OIL, GAS, DRY HOLE, SWDW, ETC.: oil
Well No. 1	Lease Name Buchholz "B"	
S 7 T 11 R 22 EX W		

WELL LOG

Show all important zones of porosity and contents thereof; cored intervals, and all drill-stem tests, including depth interval tested, cushion used, time tool open, flowing and shut-in pressures, and recoveries.

SHOW GEOLOGICAL MARKERS, LOGS RUN, OR OTHER DESCRIPTIVE INFORMATION.

FORMATION DESCRIPTION, CONTENTS, ETC.	TOP	BOTTOM	NAME	DEPTH
DST #1 from 3490'-3548' Recovered 125' very muddy oil (73% oil), 250' m&gco 505' muddy to clean oil. IFP 140-896#/30"; FFP 281-324#/30"; FSIP 238#/30"; ISIP 396#/30"	995'	gas in pipe (95% oil)		
DST #2 from 3546'-3579' Rec. 1050' g&mco(85% oil), 440' mo(70% oil). IFP 183-519#/30"; ISIP 831#/30"; FSIP 831#/30".	200'	clean oil,		
DST #3 from 3578'-3615' GTS 17" into 2nd Rec. 760' m&gco (60% oil), 1040' sli. mo (95% oil) IFP 398-540#/30"; ISIP 821#/30"; FSIP 810#/30".		Flow.		
DST #4 from 3615'-3676' Rec. 15' mud. Top malfunctioned and bottom clock stopped. IFP 54-68#; ISIP:367#.		recorder		
DST #5 from 3678'-3735' Rec. 125' mud. IFP 45"; ISIP 831#/45"; FFP 75-97#/45"; FSIP 788#/45".		64-75#/ 45"	ELECTRIC	LOG TOPS
DST #6 from 3821'-3865' Rec. 125' drlg.mud. IFP 64-75#/45"; ISIP 1175#/45"; FFP 97-103#/45"; FSIP 1111#/45".			Anhydrite	1701' (+ 530)
			B/Anhydrite	1745' (+ 486)
			Topeka	3248' (-1017)
			Heebner	3461' (-1230)
			Toronto	3484' (-1253)
			Lansing	3499' (-1268)
			B/KC	3723' (-1492)
			Marmaton	3820' (-1589)
			Arbuckle	3904' (-1673)
			RTD	3928' (-1697)
			LTD	3932' (-1701)
DST #7 from 3913'-3928' Rec. 75' mud with spots oil. IFP 75-75#/45"; ISIP 961#/45"; FFP 75-75#/45"; FSIP 928#/45".		few		

USE ADDITIONAL SHEETS, IF NECESSARY, TO COMPLETE WELL RECORD.

Date Received	<i>F. Judson Hipps</i> Signature
	F. Judson Hipps, Geologist Title
	August 12, 1980 Date

94113

K. G. S. LIBRARY

WELL LOG

COMPANY A. Scott Ritchie
FARM ~~EE~~ BUCHHOLZ 'B' NO. 1
(ORL of 2007)
RIG. NO. 15
TOTAL DEPTH 3928'
COMM. 6-13-80 **COMP.** 6-22-80
CONTRACTOR Murfin Drilling Company

SEC. 7 **T.** 11S **R.** 22W
LOC.

COUNTY Trego
 KANSAS

NW	SW	SE

CASINO

20 10
 15 8 -5/8" csg. set @ 191' w/160 sx. of Quickset **ELEVATION**

12 6
 13 5 **PRODUCTION**

4½" csg. set @ 3927' w/175 sx. of 60-40 posmix, 10% salt.
FIGURES INDICATE BOTTOM OF FORMATIONS

191' Surface Dirt -- Clay -- Shale
 1200' Shale
 1440' Sand
 1698' Shale -- Red Bed
 1745' ANHYDRITE
 2590' Shale
 3548' Shale & Lime
 3765' Lime
 3928' Lime & Chirt R T D