

"No Log run"

Geological Survey

KANSAS DRILLERS LOG

S. 2 T. 11 R. 23 E West W

API No. 15 County Number

Loc. SW SW NW

County Trego

Operator Rains & Williamson Oil Co., Inc.

Address 435 Page Court-220 West Douglas-Wichita, Ks

Well No. 1 Lease Name McCall

Footage Location feet from (N) (S) line feet from (E) (W) line

Principal Contractor Rains & Williamson Oil Co. Inc. Geologist Harvey Gough

Spud Date 12-6-75 Total Depth 3725' P.B.T.D.

Date Completed 12-15-75 Oil Purchaser

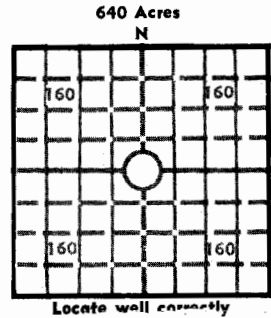

Elev.: Gr.

DF KB 2233'

CASING RECORD

Report of all strings set — surface, intermediate, production, etc.

Purpose of string	Size hole drilled	Size casing set (in O.D.)	Weight lbs/ft.	Setting depth	Type cement	Sacks	Type and percent additives
	12 1/2"	8-5/8"		211'	common	150	

LINER RECORD

PERFORATION RECORD

Top, ft.	Bottom, ft.	Sacks cement	Shots per ft.	Size & type	Depth interval

Size	Setting depth	Packer set at

ACID, FRACTURE, SHOT, CEMENT SQUEEZE RECORD

Amount and kind of material used	Depth interval treated

INITIAL PRODUCTION

Date of first production Producing method (flowing, pumping, gas lift, etc.)

RATE OF PRODUCTION PER 24 HOURS Oil bbls. Gas MCF Water bbls. Gas-oil ratio CFPB

Disposition of gas (vented, used on lease or sold) Producing interval (s)

INSTRUCTIONS: As provided in KCC Rule 82-2-125, within 90 days after completion of a well, one completed copy of this Drillers Log shall be transmitted to the State Geological Survey of Kansas, 4150 Monroe Street, Wichita, Kansas 67209. Copies of this form are available from the Conservation Division, State Corporation Commission, 3830 So. Meridian (P.O. Box 17027), Wichita, Kansas 66217. Phone AC 316-522-2206. If confidential custody is desired, please note Rule 82-2-125. Drillers Logs will be on open file in the Oil and Gas Division, State Geological Survey of Kansas, Lawrence, Kansas 66044.

Operator Rains & Williamson Oil Co., Inc.		DESIGNATE TYPE OF COMP.: OIL, GAS, DRY HOLE, SWDW, ETC.:
Well No. 1	Lease Name McCall	Dry Hole
S <u>2</u> T <u>11</u> R <u>23</u> E West W		

**WELL LOG**

Show all important zones of porosity and contents thereof; cored intervals, and all drill-stem tests, including depth interval tested, cushion used, time tool open, flowing and shut-in pressures, and recoveries.

SHOW GEOLOGICAL MARKERS, LOGS RUN, OR OTHER DESCRIPTIVE INFORMATION.

FORMATION DESCRIPTION, CONTENTS, ETC.	TOP	BOTTOM	NAME	DEPTH
DST #1 3483-3500/30-30-90-45, 20' GIP, 20' th M, 20' SOCM, SIP 182-164#, FP 18-41#				
DST #2 3505-45/30-30-60-30, Rec 50' M w/F Spk O, SIP 754-145#, FP 27-54#				
DST #3 3542-72/30-30-30-30 Rec 10 M, SIP 182-82#, FP 27-27#				
DST #4 3610-70/30-30-30-30, Rec 80' M, SIP 227-164#, FP 41-91#				
DST #5 3672-3725/30-30-30-30, Rec 10' M, 5'W, SIP 63-45#, FP 27-27#				
<u>TOPS</u>				
Anhydrite	1711-62	+ 522		
Heebner	3453	-1220		
Lansing	3488	-1255		
B/Kansas City	3714	-1481		
RTD	3725	-1492		

USE ADDITIONAL SHEETS, IF NECESSARY, TO COMPLETE WELL RECORD.

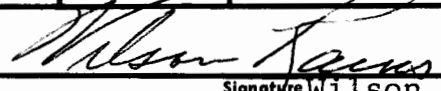
Date Received	 Signature <u>Wilson Rains</u> President -Rains & Williamson Oil Co., Inc. Title 4-27-76 Date
---------------	--

98096