

STATE CORPORATION COMMISSION OF KANSAS  
OIL & GAS CONSERVATION DIVISION  
WELL COMPLETION OR RECOMPLETION FORM  
ACO-1 WELL HISTORY  
DESCRIPTION OF WELL AND LEASE

Operator: License # 5046  
Name Raymond Oil Company, Inc.  
Address P.O. Box 48788  
City/State/Zip Wichita, KS 67201

Purchaser

Operator Contact Person Pat Raymond  
Phone 316-267-4214

Contractor: License # 5929  
Name Duke Drilling Co., Inc.

Wellsite Geologist Steven E. Stribling  
Phone 316/267-4214

Designate Type of Completion  
New Well  Re-Entry  Workover   
Oil  SWD  Temp Abd   
Gas  Inj  Delayed Comp.   
 Dry  Other (Core, Water Supply etc.)

If OWWO: old well info as follows:  
Operator Porter Oil & Gas Co.  
Well Name Hillie #1  
Comp. Date 10-13-55 Old Total Depth 3751

WELL HISTORY

Drilling Method:  Mud Rotary  Air Rotary  Cable  
12-13-85 12-19-85 12-19-85  
Spud Date Date Reached TD Completion Date  
3748'  
Total Depth PBSD

Amount of Surface Pipe Set and Cemented at 164 feet  
Multiple Stage Cementing Collar Used? Yes No  
If yes, show depth set.....feet  
If alternate 2 completion, cement circulated  
from.....feet depth to.....w/.....SX cmt  
Cement Company Name  
Invoice #

API NO. 15-195-01,011  
County Trego  
NW NW SE Sec. 22 Twp 11 Rge. 23 East  
..... West

2310 Ft North from Southeast Corner of Section  
2310 Ft West from Southeast Corner of Section  
(Note: Locate well in section plat below)

Lease Name Baughman Well # 1

Field Name Wildcat

Producing Formation

Elevation: Ground 2282 KB 2287

Section Plat

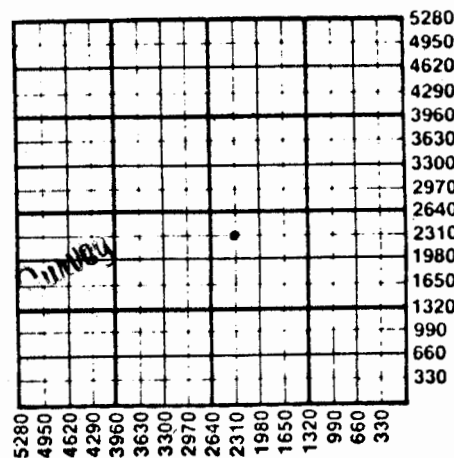

WATER SUPPLY INFORMATION

Disposition of Produced Water: Disposal  
Docket # Repressuring

Questions on this portion of the ACO-1 call:

Water Resources Board (913) 296-3717

Source of Water:  
Division of Water Resources Permit #

Groundwater.....Ft North from Southeast Corner  
(Well) .....Ft West from Southeast Corner of  
Sec Twp Rge East West

Surface Water.....Ft North from Southeast Corner  
(Stream, pond etc).....Ft West from Southeast Corner  
Sec Twp Rge East West

Other (explain) City Water.....  
(purchased from city, R.W.D. #)

INSTRUCTIONS: This form shall be completed in duplicate and filed with the Kansas Corporation Commission, 200 Colorado Derby Building, Wichita, Kansas 67202, within 90 days after completion or recompletion of any well. Rule 82-3-130 and 82-3-107 apply.  
Information on side two of this form will be held confidential for a period of 12 months if requested in writing and submitted with the form. See rule 82-3-107 for confidentiality in excess of 12 months.  
One copy of all wireline logs and drillers time log shall be attached with this form. Submit CP-4 form with all plugged wells. Submit CP-111 form with all temporarily abandoned wells.

96521

SIDE TWO

Operator Name Raymond Oil Company, Inc. Lease Name Baughman Well # 1

Sec. 22 Twp. 11 Rge. 23  East  West County Trego

WELL LOG

INSTRUCTIONS: Show important tops and base of formations penetrated. Detail all cores. Report all drill stem tests giving interval tested, time tool open and closed, flowing and shut-in pressures, whether shut-in pressure reached static level, hydrostatic pressures, bottom hole temperature, fluid recovery, and flow rates if gas to surface during test. Attach extra sheet if more space is needed. Attach copy of log.

Drill Stem Tests Taken  Yes  No  
Samples Sent to Geological Survey  Yes  No  
Cores Taken  Yes  No

Formation Description  
 Log  Sample

DST #1: 3504' - 3548', 30-30-30-30,  
Rec. 3'M, IFP 34#-34#,  
ISIP 386#, FFP 34#-34#,  
FSIP 261#.

Name	Top	Bottom
Topeka	3273'	
Heebner	3498'	
Lansing	3536'	
RTD	3748'	

No logs were run.

CASING RECORD <input type="checkbox"/> New <input type="checkbox"/> Used							
Report all strings set-conductor, surface, intermediate, production, etc.							
Purpose of String	Size Hole Drilled	Size Casing Set (in O.D.)	Weight Lbs/Ft.	Setting Depth	Type of Cement	#Sacks Used	Type and Percent Additives
Surface	15"	10-3/4"		164'	unknown		unknown
.....	.....	.....	.....	.....	.....	.....	.....
.....	.....	.....	.....	.....	.....	.....	.....
.....	.....	.....	.....	.....	.....	.....	.....
PERFORATION RECORD				Acid, Fracture, Shot, Cement Squeeze Record			
Shots Per Foot	Specify Footage of Each Interval Perforated			Amount and Kind of Material Used		Depth	
.....	.....			.....		.....	
.....	.....			.....		.....	
.....	.....			.....		.....	
.....	.....			.....		.....	
TUBING RECORD				Liner Run <input type="checkbox"/> Yes <input type="checkbox"/> No			
Size	Set At	Packer at					
.....	.....	.....					
Date of First Production		Producing Method					
.....		<input type="checkbox"/> Flowing <input type="checkbox"/> Pumping <input type="checkbox"/> Gas Lift <input type="checkbox"/> Other (explain).....					

22-11-23W

DRILLER'S WELL LOG >

DATE COMMENCED: December 13, 1985  
DATE COMPLETED: December 19, 1985

Raymond Oil Company, Inc.  
BAUGHMAN #1  
NW NW SE  
Sec. 22, T11S, R23W  
Trego County, ks.

ELEVATION: 2287 K.B.

0 - 730' Washed hole to 730', out of hole  
730 - 3273' Shale & Lime Streaks  
3273 - 3498' Lime  
3498 - 3502' Shale  
3502 - 3536' Lime & Shale  
3536 - 3748' Lime  
3748' RTD

FORMATION DATA

Topeka	3273'
Heebner	3498'
Lansing	3536'
RTD	3748'

Surface Pipe: Set 10-3/4"  
@ 164' on 10-13-55.

JAN 13 1985  
State Geologist Survey  
WICHITA

A F F I D A V I T

STATE OF KANSAS-COUNTY OF BARTON) ss

Bill Draney of lawful age, does swear and state that the facts and statements herein are true and correct to the best of his knowledge.

Bill Draney

Subscribed and sworn to before me this 30 day of December 1985.

My Comm. Expires:

4-29-86

Lawrence M. Hague  
Notary Public