

STATE CORPORATION COMMISSION OF KANSAS  
OIL & GAS CONSERVATION DIVISION

WELL COMPLETION OR RECOMPLETION FORM  
ACO-1 WELL HISTORY

DESCRIPTION OF WELL AND LEASE

Operator: License # 9041  
Name Josph H. Strabala  
Address 312 E. Uintah  
City/State/Zip Colo.. Springs, Colo.. 80903

Purchaser.....

Operator Contact Person John Fose  
Phone 713-2388 (913)

Contractor: License # 9087  
Name R. & C. Drilling Co. Inc.

Wellsite Geologist Mark Torr  
Phone 913-625-3131

Designate Type of Completion  
 New Well  Re-Entry  Workover  
 Oil  SWD  Temp Abd  
 Gas  Inj  Delayed Comp.  
 Dry  Other (Core, Water Supply etc.)

If **OWWO**: old well info as follows:  
Operator .....  
Well Name .....  
Comp. Date ..... Old Total Depth.....

WELL HISTORY

Drilling Method:  
 Mud Rotary  Air Rotary  Cable  
8-16-85... 8-23-85... 8-23-85...  
Spud Date Date Reached TD Completion Date  
3980.....  
Total Depth PBTD

Amount of Surface Pipe Set and Cemented at 232' feet  
Multiple Stage Cementing Collar Used?  Yes  No  
If yes, show depth set.....feet  
If alternate 2 completion, cement circulated  
from.....feet depth to.....w/.....SX cmt

API NO. 15-195-21,755

County Trego

NW 1/4 SE 1/4 SE 1/4 Sec 30 Twp 11 Rge 23  East  West

830 Ft North from Southeast Corner of Section  
780 Ft West from Southeast Corner of Section

(Note: Locate well in section plat below)

Lease Name Rhoades Well # 1

Field Name.....

Producing Formation.....

Elevation: Ground 2347 KB 2352

Section Plat

SEP 10 1985  
State Geological Survey  
WICHITA

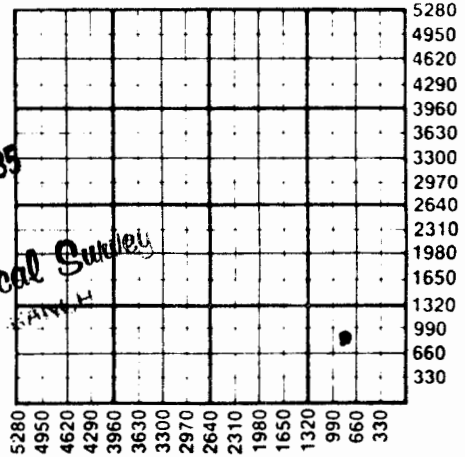

WATER SUPPLY INFORMATION

Disposition of Produced Water:  Disposal  Repressuring  
Docket # .....

Questions on this portion of the ACO-1 call:

Water Resources Board (913) 296-3717

Source of Water:  
Division of Water Resources Permit #.....

Groundwater.....Ft North from Southeast Corner  
(Well) .....Ft West from Southeast Corner of  
Sec Twp Rge  East  West

Surface Water 330 Ft North from Southeast Corner  
(Stream, pond, etc) 660 Ft West from Southeast Corner  
Sec 30 Twp 11 Rge 23  East  West

Other (explain).....  
(purchased from city, R.W.D. #)

INSTRUCTIONS: This form shall be completed in duplicate and filed with the Kansas Corporation Commission, 200 Colorado Derby Building, Wichita, Kansas 67202, within 90 days after completion or recompletion of any well. Rule 82-3-130 and 82-3-107 apply.

Information on side two of this form will be held confidential for a period of 12 months if requested in writing and submitted with the form. See rule 82-3-107 for confidentiality in excess of 12 months.

One copy of all wireline logs and drillers time log shall be attached with this form. Submit CP-4 form with all plugged wells. Submit CP-111 form with all temporarily abandoned wells.

**SIDE TWO**

Operator Name Joseph H. Strabala Lease Name Rhoades Well # 1

Sec. 30 Twp. J.1 Rge. 23  East  West County Trego

**WELL LOG**

**INSTRUCTIONS:** Show important tops and base of formations penetrated. Detail all cores. Report all drill stem tests giving interval tested, time tool open and closed, flowing and shut-in pressures, whether shut-in pressure reached static level, hydrostatic pressures, bottom hole temperature, fluid recovery, and flow rates if gas to surface during test. Attach extra sheet if more space is needed. Attach copy of log.

Drill Stem Tests Taken  Yes  No  
 Samples Sent to Geological Survey  Yes  No  
 Cores Taken  Yes  No

0' - 1910' Sand & Shale  
 1910' - 1958' Anhydrite  
 1958' - 3980' Shale & Lime R.T.D.

DST # 1:  
 Interval Tested: 3754' to 3780'.  
 Times: 30-60-60-60.  
 Recovery: 236' of muddy water.  
 Shut-in Pressures: 1237 to 1146 PSI.  
 Flow Pressures: 35-58 & 81-127 PSI.

**Formation Description**  
 Log  Sample

| Name          | Top  | Bottom |
|---------------|------|--------|
| Heebner Shale | 3692 | 3695   |
| Toronto       | 3716 | 3730   |
| L-KC          | 3730 | 3978   |

REC'D 10 1005

**State Geological Survey  
 WICHITA BRANCH**

|  |   |                           |                |   |  |             |                            |
|--|---|---------------------------|----------------|---|--|-------------|----------------------------|
| CASING RECORD <input checked="" type="checkbox"/> New <input type="checkbox"/> Used<br>Report all strings set-conductor, surface, intermediate, production, etc. |   |                           |                |   |  |             |                            |
| Purpose of String  | Size Hole Drilled                           | Size Casing Set (in O.D.) | Weight Lbs/Ft. | Setting Depth   | Type of Cement   | #Sacks Used | Type and Percent Additives |
| Surface  | 12 1/4                                      | 8 5/8                     | 24             | 232   | Common   | 150         |                            |
| PERFORATION RECORD   |   |                           |                | Acid, Fracture, Shot, Cement Squeeze Record   |  |             |                            |
| Shots Per Foot   | Specify Footage of Each Interval Perforated |                           |                | (Amount and Kind of Material Used)  |  | Depth       |                            |
|  |   |                           |                |   |  |             |                            |
| TUBING RECORD  |   |                           |                | Liner Run   | <input type="checkbox"/> Yes <input type="checkbox"/> No |             |                            |
| Date of First Production   | Producing Method                            |                           |                | <input type="checkbox"/> Flowing <input type="checkbox"/> Pumping <input type="checkbox"/> Gas Lift <input type="checkbox"/> Other (explain)..... |  |             |                            |