

Section 24 Township 11 Range 19W

Well No. #1 Richards

Company Jones, Shelburne & Farmer

NORTH

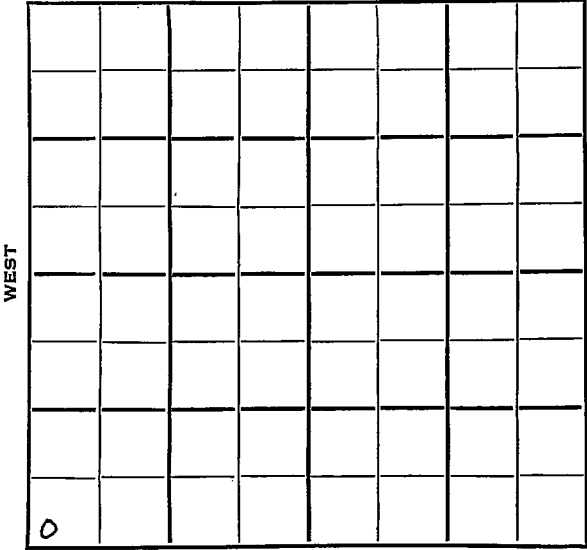

13

SOUTH



Sec. 24 ~~21~~ Twp. 11 R. 19 W

Well No. # 1 Richards Farm

Jones, Shelburne & Farmer Company

J-S-F Contractor

Semi-Wildcat

Ft. from N. Line

330 Ft. from S. Line

Ft. from E. Line

330 Ft. from W. Line

SW SW SW

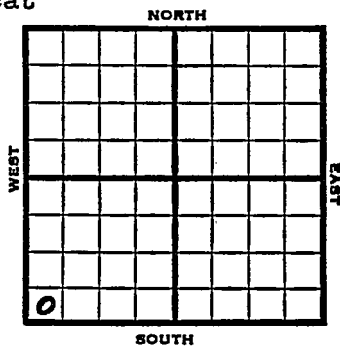

1953 Elev. 2065' REPORT

2/25 RUR  
 3/12 8" @ 165 Anhy 1422' Heeb 3270  
 Tor 3289' Lans 3312' Arb. 3595  
 DST 3590-3600, 1 hr, 1100' clean oil  
 1040# RTD 3600' 5" @ 3596

3/19 CO 3600 FU 400' oil 14 hrs.  
 S/8½ BOPH 2 hrs. FU 2100' oil  
 & trace wtr 13 hrs.  
 DST 3428-3541, 1 hr, 50' SW  
 1005#

3/26 NR  
 4/1 Spud 2-24-53  
 Oil Well  
 TD 3600  
 8" @ 165  
 Anhy 1422, Heeb 3270, Tor 3289, Lans  
 3312, Arb 3595,  
 DST 3590-3600 open 1 hr. Rec 1100'  
 clean oil 1040#  
 TD 3600  
 5" @ 3596  
 CO to 3600  
 FU 400' oil 14 hr. S/ 8½ boph  
 2 hr. FU 2100' oil 13 hr.  
 DST 3428-3541 open 1 hr. Rec 50' SW  
 1050#  
 Comp. 89 bopd

**COMPLETED OVER**

1953

Information brought forward



Map No. \_\_\_\_\_ Sec. 24 Twp. 11 R. 19W

Well No. 1 Richards

Jones, Shelburne & Farmer Company

**CORRECTION**

Contractor

SW SW SW

SECTION PLAT

\_\_\_\_\_ Ft. from N. Line

330 Ft. from S. Line

\_\_\_\_\_ Ft. from E. Line

330 Ft. from W. Line

? Ellis  
Graham County

RECORD

Location \_\_\_\_\_

Cased \_\_\_\_\_ in., \_\_\_\_\_ ft.

Rig up \_\_\_\_\_

Sand \_\_\_\_\_

Drilling and Remarks:

Gas \_\_\_\_\_

Oil \_\_\_\_\_

Reported  
21-11-19W

Total Depth \_\_\_\_\_

PRODUCTION

1st 24 hrs. Nat. \_\_\_\_\_

1st 24 hrs. after shot \_\_\_\_\_

Gas \_\_\_\_\_ Cu. Ft.

Dry Hole \_\_\_\_\_

Abandoned \_\_\_\_\_

Date

FEB 25 1953

19

J. G. McGEHEE Scout

Hi, JOE

Better sick the dogs on this one.

I've searched in vain in something to give you a lead on this one. It

just don't jive with anything we have.

(~~xxxx~~ hint) We may have returned the first report. Also spot your corrections.

love,

luville

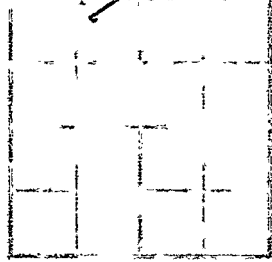

RECEIVED

MAR 6 1953

MAR 6 1953

- Scout Cards *mm*
- Land Small Map
- Land Wall Map
- Tracings
- France Map
- Pierce Map
- Misc.

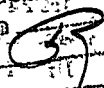

Date

Kansas

Map No. \_\_\_\_\_ Sec. 24 Twp. 11 R. 19W

Well No. 1 Richards

Jones, Shelburne & Farmer Company

CORRECTION Contractor

SW SW SSW

SECTION PLAT

\_\_\_\_\_ Ft. from N. Line

330 Ft. from S. Line

\_\_\_\_\_ Ft. from E. Line

330 Ft. from W. Line

Ellis County

Location \_\_\_\_\_

Rig up \_\_\_\_\_

Drilling and Remarks:

Reported  
21-11-19W  
Graham County.

RECORD

Cased \_\_\_\_\_ in., \_\_\_\_\_ ft.

Sand \_\_\_\_\_

Gas \_\_\_\_\_

Oil \_\_\_\_\_

Total Depth \_\_\_\_\_

PRODUCTION

1st 24 hrs. Nat. \_\_\_\_\_

1st 24 hrs. after shot \_\_\_\_\_

Gas \_\_\_\_\_ Cu. Ft.

Dry Hole \_\_\_\_\_

Abandoned \_\_\_\_\_

Date

FEB 25 1953 19

J. G. McGEHEE Scout

