

PI

State Geological Survey
WICHITA BRANCH

KANSAS DRILLERS LOG

S. 12 T. 11S R. 24W ^{XX} W

API No. 15 — 195 — 20,855
County Number

Loc. C NW NW

County Trego

Operator
Keith F. Walker

Address
219 Stanley, Ardmore, Oklahoma 73401

Well No. #1 Lease Name Irving Walker

Footage Location
660 feet from (N) ^{XX} line 660 feet from ^{XX} (W) line

Principal Contractor John O. Farmer, Inc. Geologist Cary McConnell

Spud Date 7-25-81 Total Depth 3876' P.B.T.D.

Date Completed 8-2-81 Oil Purchaser Koch

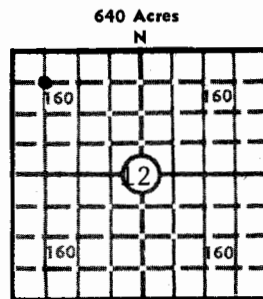

Elev.: Gr. 2279'

DF 2282' KB 2284'

CASING RECORD

Report of all strings set — surface, intermediate, production, etc.

Purpose of string	Size hole drilled	Size casing set (in O.D.)	Weight lbs/ft.	Setting depth	Type cement	Sacks	Type and percent additives
Surface	12-1/4"	8-5/8"	24	213'	Common	170	
Production	7-7/8"	4-1/2"	9.5	3875'	Common	125	

LINER RECORD

PERFORATION RECORD

Top, ft.	Bottom, ft.	Sacks cement	Shots per ft.	Size & type	Depth interval
			4	1/2 Jets	3818-3824

Size	Setting depth	Packer set at
2 3/8	3814	

ACID, FRACTURE, SHOT, CEMENT SQUEEZE RECORD

Amount and kind of material used	Depth interval treated
1000 gallons 15 % regular acid	3818-3824

INITIAL PRODUCTION

Date of first production October 16, 1981	Producing method (flowing, pumping, gas lift, etc.) Pumping
RATE OF PRODUCTION PER 24 HOURS	Oil 60 bbls. Gas 0 MCF Water 0 bbls. Gas-oil ratio CFPB
Disposition of gas (vented, used on lease or sold) none	Producing interval (s) 3818-3824

INSTRUCTIONS: As provided in KCC Rule 82-2-125, within 90 days after completion of a well, one completed copy of this Drillers Log shall be transmitted to the State Geological Survey of Kansas, 4150 Monroe Street, Wichita, Kansas 67209. Copies of this form are available from the Conservation Division, State Corporation Commission, 3830 So. Meridian (P.O. Box 17027), Wichita, Kansas 66217. Phone AC 316-522-2206. If confidential custody is desired, please note Rule 82-2-125. Drillers Logs will be on open file in the Oil and Gas Division, State Geological Survey of Kansas, Lawrence, Kansas 66044.

Operator Keith F. Walker		DESIGNATE TYPE OF COMP.: OIL, GAS, DRY HOLE, SWDW, ETC.:
Well No. #1	Lease Name Irving Walker	Oil
S 12 T11S R 24W ^{EX} W		

WELL LOG

Show all important zones of porosity and contents thereof; cored intervals, and all drill-stem tests, including depth interval tested, cushion used, time tool open, flowing and shut-in pressures, and recoveries.

SHOW GEOLOGICAL MARKERS, LOGS RUN, OR OTHER DESCRIPTIVE INFORMATION.

FORMATION DESCRIPTION, CONTENTS, ETC.	TOP	BOTTOM	NAME	DEPTH
Clay & Sand, Blue Shale	0	214		
Shale & Sand	214	1408		
Sand	1408	1636		
Red Bed	1636	1883		
Anhydrite	1883	1926		
Shale & Shells	1926	2300		
Lime & Shale	2300	2485		
Shale & Lime	2485	2790		
Lime & Shale	2790	2960		
Shale & Lime	2960	3240		
Lime & Shale	3240	3693		
Lime	3693	3876		

USE ADDITIONAL SHEETS, IF NECESSARY, TO COMPLETE WELL RECORD.

Date Received	<i>John O. Farmer</i>
	Signature
	President
	Title
	August 6, 1981
	Date

96823