

KANSAS DRILLERS LOG
State Geological Survey

IMPORTANT
 Kans. Geo. Survey request
 samples on this well.

S. 23 T. 11 R. 24 ^E/_W
 Loc. C SL SE
 County Trego

API No. 15 — WICHITA, BRANCH — 20,282
 County Number

Operator
Chief Drilling Co., Inc.

Address 905 Century Plaza Wichita, Kansas 67202

Well No. #1 Lease Name Schaus

Footage Location
 feet from (N) (S) line _____ feet from (E) (W) line _____

Principal Contractor Company Tools Geologist Don Strong

Spud Date 6/24/74 Total Depth 4375' P.B.T.D. _____

Date Completed 7/18/74 Oil Purchaser Clear Creek

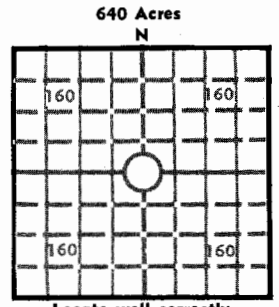

Elev.: Gr. 2445

DF 2447 KB 2450

CASING RECORD

Report of all strings set — surface, intermediate, production, etc.

Purpose of string	Size hole drilled	Size casing set (in O.D.)	Weight lbs/ft.	Setting depth	Type cement	Sacks	Type and percent additives
Surface	12 1/4"	8 5/8"	28#	200'	Common Quick Set	160	
Production		5 1/2"	15#	4046'	60-40 posmix 50-50 posmix	200 500	10 Bbls. salt flush - 6% gel

LINER RECORD

PERFORATION RECORD

Top, ft.	Bottom, ft.	Sacks cement	Shots per ft.	Size & type	Depth interval
TUBING RECORD			4	DP	3977-3980'
			4	DP	3957-3960'

ACID, FRACTURE, SHOT, CEMENT SQUEEZE RECORD

Amount and kind of material used	Depth interval treated
500 gal. 15% reg. acid w/mud additives	3977-3980'

INITIAL PRODUCTION

Date of first production <u>7/19/74</u>	Producing method (flowing, pumping, gas lift, etc.) <u>Pump</u>			
RATE OF PRODUCTION PER 24 HOURS	Oil <u>109</u> bbls.	Gas <u>50</u> MCF	Water <u>50</u> bbls.	Gas-oil ratio <u>CFPB</u>
Disposition of gas (vented, used on lease or sold)			Producing interval(s) <u>3977-3980 3957-3960</u>	

INSTRUCTIONS: As provided in KCC Rule 82-2-125, within 90 days after completion of a well, one completed copy of this Drillers Log shall be transmitted to the State Geological Survey of Kansas, 4150 Monroe Street, Wichita, Kansas 67209. Copies of this form are available from the Conservation Division, State Corporation Commission, 3830 So. Meridian (P.O. Box 17027), Wichita, Kansas 66217. Phone AC 316-522-2206. If confidential custody is desired, please note Rule 82-2-125. Drillers Logs will be on open file in the Oil and Gas Division, State Geological Survey of Kansas, Lawrence, Kansas 66044.

Operator **Chief Drilling Co., Inc.** DESIGNATE TYPE OF COMP.: OIL, GAS, DRY HOLE, SWDW, ETC.:

Well No. **1** Lease Name **Schaus** Oil

S 23 T 11 R 24 W E
W

WELL LOG

Show all important zones of porosity and contents thereof; cored intervals, and all drill-stem tests, including depth interval tested, cushion used, time tool open, flowing and shut-in pressures, and recoveries.

SHOW GEOLOGICAL MARKERS, LOGS RUN, OR OTHER DESCRIPTIVE INFORMATION.

FORMATION DESCRIPTION, CONTENTS, ETC.	TOP	BOTTOM	NAME	DEPTH
DST #1 3922-3947' Open 2½ hours Rec. 680' water IBHP: 1422#/30" FBHP: 1420#/45" FP: 45-296"			<u>ELECTRIC</u>	<u>LOG TOPS</u>
			Anhydrite	2037 + 413
			Base Anhy.	2078 + 372
			Heebner	3757 - 1307
			Toronto	3781 - 1331
			Lansing	3794 - 1344
			Base K.C.	4034 - 1584
			Marmaton	4058 - 1608
			Congl. Shale	4297 - 1847
			Cherty Congl.	4322 - 1872
			Miss. Lime	4358 - 1908
			LTD	4376 - 1926
DST #2 3946-3968' Open 1 hour 15" Gas to surface in 70" Rec. 1580' oil 40.8° gravity IBHP: 1442#/30" FBHP: 1430#/45" FP: 139-837#				
DST #3 3968-3988' Open 2 hours Rec. 75' heavy oil cut mud IBHP: 48#/30" FBHP: 48#/45" FP: 25-48#				
DST #4 3986-4040' Open 2 hours Rec. 540' water IBHP: 1422#/30" FBHP: 1360#/45" FP: 44-305#				

USE ADDITIONAL SHEETS, IF NECESSARY, TO COMPLETE WELL RECORD.



Jim Robinson
Signature

Vice President
Title

July 30, 1974
Date

29086

WELL LOG

CHIEF DRILLING CO., INC.
Suite 905 Century Plaza
Wichita, Kansas 67202

#1 SCHAUS
C SL SE/4 Sec. 23-11-24W
Trego County, Kansas

CONTRACTOR: Company Tools
CASING RECORD: Set 194' of 8 5/8" w/160 sacks
Common Quick Set Cement; 4070'
5 1/2" w/200 sacks 60-40 Posmix
10 Bbl. salt flush & 500 sacks
50-50 posmix 6% gel

COMMENCED: 6/24/74
COMPLETED: 7/4/74

<u>FORMATION</u>	<u>FROM</u>	<u>TO</u>	<u>ELEVATION</u>
Surface Hole	0	203	2445 Gr.
Shale & Sand	203	990	2447 D.F.
Shale & Shells	990	1560	2450 K.B.
Sand & Shale	1560	1830	
Shale & Shells	1830	2036	
Anhydrite	2036	2078	
Shale & Shells	2078	2815	
Shale & Lime	2815	3500	
Lime & Shale	3500	3820	
Lime	3820	4375	
Total Depth	4375		

ELECTRIC LOG TOPS

Anhydrite	2037 +	413
Base Anhy.	2078 +	372
Heebner	3757 -	1307
Toronto	3781 -	1331
Lansing	3794 -	1344
Base K.C.	4034 -	1584
Marmaton	4058 -	1608
Congl. Shale	4297 -	1847
Cherty Congl.	4322 -	1872
Miss. Lime	4358 -	1908
T.D.	4375 -	1925

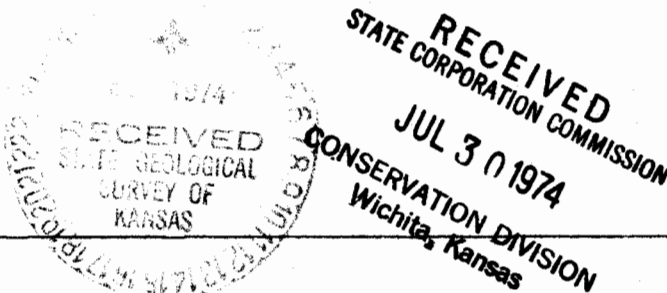

(STATE OF KANSAS, COUNTY OF SEDGWICK) ss:

I hereby certify that the above is a true and correct copy of the Driller's log of the well drilled in the C SL SE/4 of Section 23-11-24W, Trego County, Kansas, to the best of my knowledge and belief.

CHIEF DRILLING CO., INC.

Jim Robinson
Jim Robinson, Vice President

Subscribed and sworn to before me this 12th day of July, 1974.

Virginia S. Fabian
Virginia S. Fabian, Notary Public

