

STATE CORPORATION COMMISSION OF KANSAS
OIL & GAS CONSERVATION DIVISION
WELL COMPLETION OR RECOMPLETION FORM
ACO-1 WELL HISTORY
DESCRIPTION OF WELL AND LEASE

Operator: License # 6889
Name Oxford Exploration, Inc.
Address 1000 Denver Club Building
518-17th Street
City/State/Zip Denver, CO 80202

Purchaser NZA

Operator Contact Person David E. Park, Jr.
Phone (303) 572-3821

Contractor: License # 5422
Name Abercrombie Drilling, Inc.

Wellsite Geologist Dusty Rhodes
Phone (913) 473-5419

Designate Type of Completion
 New Well Re-Entry Workover
 Oil SWD Temp Abd
 Gas Inj Delayed Comp.
 Dry Other (Core, Water Supply etc.)

If **OWWO**: old well info as follows:
Operator
Well Name
Comp. Date Old Total Depth

WELL HISTORY

Drilling Method:
 Mud Rotary Air Rotary Cable
4/16/86 4/21/86 4/22/86
Spud Date Date Reached TD Completion Date
4150
Total Depth PBDT

Amount of Surface Pipe Set and Cemented at 218 feet
Multiple Stage Cementing Collar Used? Yes No
If yes, show depth set feet
If alternate 2 completion, cement circulated from feet depth to w/SX cmt
Cement Company Name Allied
Invoice # 46575

API NO. 15-195-21,857
County Trego
SE NE NW 33 11S 24 East
Sec Twp Rge West

4290 Ft North from Southeast Corner of Section
2970 Ft West from Southeast Corner of Section
(Note: Locate well in section plat below)

Lease Name Malinowsky Well # 1-33

Field Name

Producing Formation NONE

Elevation: Ground 2514 KB 2519

Section Plat

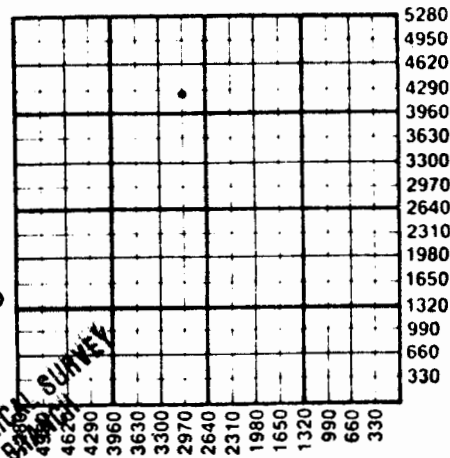

Disposition of Produced Water: Disposal
Docket # Repressuring

Questions on this portion of the ACO-1 call:
Water Resources Board (913) 296-3717

Source of Water:
Division of Water Resources Permit #

Groundwater Ft North from Southeast Corner
(Well) Ft West from Southeast Corner of
Sec Twp Rge East West

Surface Water 330 Ft North from Southeast Corner
(Stream, pond etc.) 2640 Ft West from Southeast Corner
Trego Sec 25 Twp 11 Rge 25 East West

X Other (explain) Edgar Schmidt
(purchased from city, R.W.D. #)

INSTRUCTIONS: This form shall be completed in duplicate and filed with the Kansas Corporation Commission, 200 Colorado Derby Building, Wichita, Kansas 67202, within 90 days after completion or recompletion of any well. Rule 82-3-130 and 82-3-107 apply. Information on side two of this form will be held confidential for a period of 12 months if requested in writing and submitted with the form. See rule 82-3-107 for confidentiality in excess of 12 months. One copy of all wireline logs and drillers time log shall be attached with this form. Submit CP-4 form with all plugged wells. Submit CP-111 form with all temporarily abandoned wells.