

15-195-20420

State Geological Survey
 WICHITA, BRANCH
 KANSAS DRILLERS LOG

API No. 15 — 195 — 20,420
 County Number

S. 11 T. 11 R. 25 ^{EW}
 Loc. NE SE NE
 County Trego

Operator
Mack Oil Co.

Address
908 Union Center Wichita, Kansas 67202

Well No. #1 Lease Name R. N. Tidball

Footage Location
1650 feet from (N) ~~35~~ line 330 feet from (E) ~~35~~ line of NE/4

Principal Contractor Helberg Drlg. Geologist Earl Moore

Spud Date 8-9-77 Total Depth 3965 P.B.T.D.

Date Completed 8-18-77 Oil Purchaser

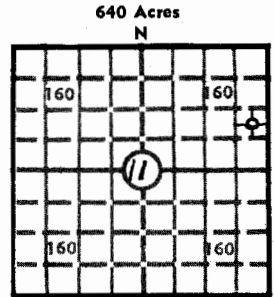

Elev.: Gr. 2342'
 DF 2344' KB 2347'

CASING RECORD

Report of all strings set — surface, intermediate, production, etc.

| Purpose of string | Size hole drilled | Size casing set (in O.D.) | Weight lbs/ft. | Setting depth | Type cement | Sacks | Type and percent additives |
|-------------------|-------------------|---------------------------|----------------|---------------|-------------|-------|----------------------------|
| surface pipe | 12 1/4" | 8 5/8" | 28# | 213' | common | 125 | 3% CC |
| | | | | | | | |
| | | | | | | | |
| | | | | | | | |

LINER RECORD

PERFORATION RECORD

| Top, ft. | Bottom, ft. | Sacks cement | Shots per ft. | Size & type | Depth interval |
|----------|-------------|--------------|---------------|-------------|----------------|
| | | | | | |
| | | | | | |
| | | | | | |

TUBING RECORD

| Size | Setting depth | Packer set at |
|------|---------------|---------------|
| | | |
| | | |
| | | |

ACID, FRACTURE, SHOT, CEMENT SQUEEZE RECORD

| Amount and kind of material used | Depth interval treated |
|----------------------------------|------------------------|
| | |
| | |
| | |
| | |

INITIAL PRODUCTION

Date of first production _____ Producing method (flowing, pumping, gas lift, etc.) _____

| RATE OF PRODUCTION PER 24 HOURS | Oil | Gas | Water | Gas-oil ratio |
|--|-------|-----|------------------------|---------------|
| | bbls. | MCF | bbls. | CFPB |
| Disposition of gas (vented, used on lease or sold) | | | Producing interval (s) | |

INSTRUCTIONS: As provided in KCC Rule 82-2-125, within 90 days after completion of a well, one completed copy of this Drillers Log shall be transmitted to the State Geological Survey of Kansas, 4150 Monroe Street, Wichita, Kansas 67209. Copies of this form are available from the Conservation Division, State Corporation Commission, 3830 So. Meridian (P.O. Box 17027), Wichita, Kansas 66217. Phone AC 316-522-2206. If confidential custody is desired, please note Rule 82-2-125. Drillers Logs will be on open file in the Oil and Gas Division, State Geological Survey of Kansas, Lawrence, Kansas 66044.

Operator MACK OIL CO. DESIGNATE TYPE OF COMP.: OIL, GAS, DRY HOLE, SWDW, ETC.: DRY HOLE

Well No. 1 Lease Name R. N. Tidball

S11 T11 R25W4

WELL LOG
 Show all important zones of porosity and contents thereof; cored intervals, and all drill-stem tests, including depth interval tested, cushion used, time tool open, flowing and shut-in pressures, and recoveries.
 SHOW GEOLOGICAL MARKERS, LOGS RUN, OR OTHER DESCRIPTIVE INFORMATION.

| FORMATION DESCRIPTION, CONTENTS, ETC. | TOP | BOTTOM | NAME | DEPTH |
|--|-----|--------|-----------|--------------|
| Sand | | 230 | L-GR-N | 0' -3958' |
| Sand & Shale | | 1964 | | |
| Anhydrite | | 2005 | Anhydrite | 1964 (+ 383) |
| Shale | | 3585 | Heebner | 3660 (-1313) |
| Shale & Lime | | 3823 | Lansing | 3702 (-1355) |
| Lime | | 3965 | B/KC | 3941 (-1594) |
| | | RTD | LTD | 3959 |
| DST #1 3835-3880 30"-30"-60"-45" Rec. 10' M, BHP's 109-109# FP's 66-76# | | | | |
| DST #2 3880-3945 30"-30"-60"-45" Rec. 660' MSW, BHP's 1062-847# FP's 87-328# | | | | |

USE ADDITIONAL SHEETS, IF NECESSARY, TO COMPLETE WELL RECORD.

Date Received _____

Nancy Laggart Signature
 Secretary Title

 8-25-77 Date

9LS86