

Incl 8/20/84 KCC pl

STATE CORPORATION COMMISSION OF KANSAS OIL & GAS CONSERVATION DIVISION

WELL COMPLETION OR RECOMPLETION FORM ACO-1 WELL HISTORY

DESCRIPTION OF WELL AND LEASE

Operator: license # 6889 name Oxford Exploration Company address 1550 Denver Club Bldg. Denver, CO 80202 City/State/Zip

Operator Contact Person David E. Park, Jr. Phone 303-572-3821

Contractor: license # Murfin Drilling Company name 6033

Wellsite Geologist Dusty (Chuck) Rhodes Phone 913-743-5419

Date Type of Completion [X] New Well [ ] Re-Entry [ ] Workover [ ] Oil [ ] Gas [X] Dry [ ] SWD [ ] Inj [ ] Other (Core, Water Supply etc.) [ ] Temp Abd [ ] Delayed Comp.

If OWWO: old well info as follows: Operator Well Name Comp. Date Old Total Depth

WELL HISTORY

Drilling Method: [X] Mud Rotary [ ] Air Rotary [ ] Cable Spud Date 8-1-84 Date Reached TD 8-20-84 Completion Date 8-20-84

Total Depth 4200' PBSD

Amount of Surface Pipe Set and Cemented at 252' feet

Multiple Stage Cementing Collar Used? [X] Yes [ ] No

If Yes, Show Depth Set feet

If alternate 2 completion, cement circulated from feet depth to w/ SX cmt

API NO. 15 - 195-21,558 County Trego SE SE NE (location) Sec 33 Twp 11S Rge 25W [ ] East [ ] West

2970 Ft North from Southeast Corner of Section 300 Ft West from Southeast Corner of Section (Note: locate well in section plat below)

Lease Name Weissbeck Well# 33-8-4

Field Name

Producing Formation

Elevation: Ground 2556 KB 2561

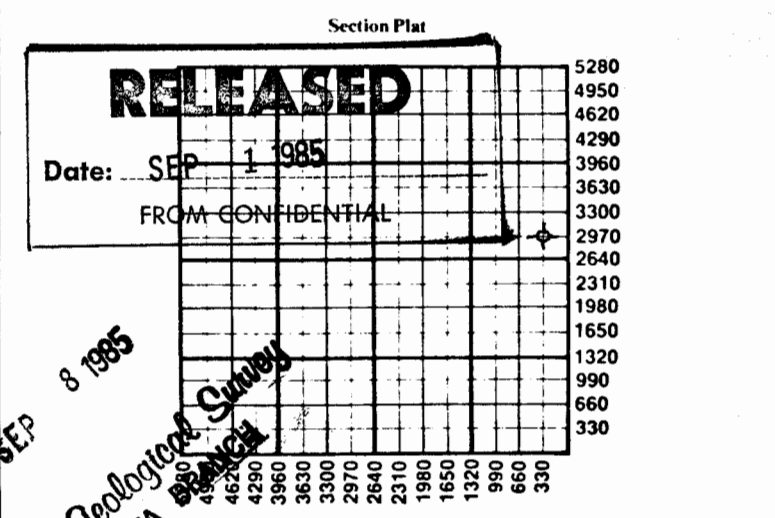

WATER SUPPLY INFORMATION

Source of Water: Division of Water Resources Permit #

[ ] Groundwater (Well) Ft North From Southeast Corner and Ft. West From Southeast Corner of Sec Twp Rge [ ] East [ ] West

[ ] Surface Water (Stream, Pond etc.) Ft North From Southeast Corner and Ft West From Southeast Corner Sec Twp Rge [ ] East [ ] West

[ ] Other (explain) (purchased from city, R.W.D.#)

Disposition of Produced Water: [ ] Disposal [ ] Repressuring

Docket #

INSTRUCTIONS: This form shall be completed in duplicate and filed with the Kansas Corporation Commission, 200 Colorado Derby Building, Wichita, Kansas 67202, within 90 days after completion or recompletion of any well. Rules 82-3-130 and 82-3-107 apply. Information on side two of this form will be held confidential for a period of 12 months if requested in writing and submitted with the form. See rule 82-3-107 for confidentiality in excess of 12 months.

Operator Name Oxford Exploration Co. Lease Name Weissbeck Well# 33-8-4 SEC 33 TWP. 11S RGE. 25W  East  West

**WELL LOG**

**INSTRUCTIONS:** Show important tops and base of formations penetrated. Detail all cores. Report all drill stem tests giving interval tested, time tool open and closed, flowing and shut-in pressures, whether shut-in pressure reached static level, hydrostatic pressures, bottom hole temperature, fluid recovery, and flow rates if gas to surface during test. Attach extra sheet if more space is needed. Attach copy of log.

Drill Stem Tests Taken  Yes  No  
 Samples Sent to Geological Survey  Yes  No  
 Cores Taken  Yes  No

Formation Description  
 Log  Sample

DST #1: 4055-4105'  
 30-60-30-60  
 Strong blow throughout. Rec. 600' MSW w/ oil shows throughout. SIP 1386-1386, FP 58-119/210-304, HP 2189-2177.

DST #2: 4044-4065' (straddle test)  
 30-30-30-30  
 No blow - flush tool. Rec. 5' SOCM. SIP 93-93, FP 21-66/23-23, HP 2170-2154.

Name	Top	Bottom
Heebner	-1293'	
Toronto	-1315'	
Lansing	-1329'	
B/KC	-1579'	

CASING RECORD <input type="checkbox"/> new <input type="checkbox"/> used							
Report all strings set - conductor, surface, intermediate, production, etc.							
Purpose of string	size hole drilled	size casing set (in O.D.)	weight lbs/ft.	setting depth	type of cement	# sacks used	type and percent additives
Surface casing	12 1/4"	8 5/8"	10#	252'	common	150	3% cc, 2% gel
PERFORATION RECORD				Acid, Fracture, Shot, Cement Squeeze Record			
shots per foot	specify footage of each interval perforated			(amount and kind of material used)			Depth

# WELL LOG

**COMPANY** OXFORD EXPLORATION CO., INC.  
 1550 Denver Club Bldg.  
 Denver, Co 80202  
**FARM** WEISSBECK **NO.** 33-8-4 ✓

**SEC.** 33 **T.** 11S **R.** 25W  
**LOC.** SE SE NE

**RIG. NO.** 15  
**TOTAL DEPTH** 4200'  
**COMM.** 8-14-84 **COMP.** 8-20-84

**COUNTY** Trego  
 KANSAS

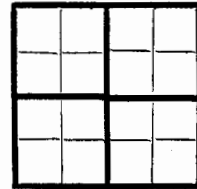

**CONTRACTOR** MURFIN DRILLING COMPANY  
 250 N. Water, Suite 300  
 Wichita, KS 67202

**CASING**  
 20 10  
 15 8 -5/8" csg set @ 252' w/150 sx Common,  
 12 6 3% CC, 2% gel  
 13 5

ELEVATION

PRODUCTION

FIGURES INDICATE BOTTOM OF FORMATIONS

Top Soil & Sand	252'
Clay & Shale	912'
Sand	1000'
Shale	1130'
Shale & Sand	1695'
Sand	1900'
Shale	2134'
Anhydrite	2181'
Shale	3700'
Shale & Lime	4105'
Lime (RTD)	4200'

SEP - 8 1985  
 State Geological Survey  
 WICHITA BRANCH

SEP 21 1984  
**CONFIDENTIAL**

State Geological Survey  
 WICHITA BRANCH

SEP 19 1984