

HAVE  
have log

KANSAS CORPORATION COMMISSION

WELL RECORD

28-11-26w

(Mail to Kansas Geological Survey, 4150 Monroe Street, Wichita, Kansas 67209)

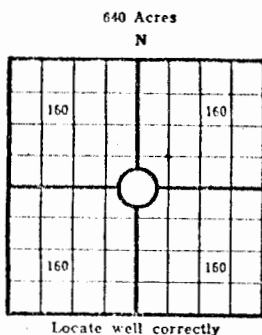

Lease Name: Bedard Well No. 1  
Well Located: Gove County  
SE SE NW SEC 28 TWP 11S RGE 26W  
Operator: Herndon Drilling Co.  
Address: Box 489, Tulsa, Oklahoma 74101  
Elevation: Ground 2657 D.F. 2662 K.B.  
Type Well: (Oil, gas, dry hole) Dry Hole

Drilling Commenced: 11-30-1971 Drilling Completed: 12-4-1971  
Well Completed: 12-4-1971 Total Depth 2890  
Initial Production: \_\_\_\_\_

Casing Record

Size: 8 5/8" Set at 207 Size: \_\_\_\_\_ Set at \_\_\_\_\_  
Size: \_\_\_\_\_ Set at \_\_\_\_\_ Size: \_\_\_\_\_ Set at \_\_\_\_\_

Liner Record

Size: \_\_\_\_\_ Set from \_\_\_\_\_ To \_\_\_\_\_

Cementing

<u>Casing Size</u>	<u>Sacks</u>	<u>Type Cement and Additives</u>
<u>8 5/8"</u>	<u>175</u>	_____
_____	_____	_____
_____	_____	_____

Perforations

<u>Formation</u>	<u>Perforated Interval and Number Shots</u>
_____	_____
_____	_____
_____	_____
_____	_____

Electric Log Run (Show type log and depths covered)

GAMMA 1900-2417

SHOW DRILL STEM TESTS, *cont.*  
Well Stimulation and  
Production Tests

28-11-26w

Formation      Top      Bottom

Anyhydrite

2253

Base

2293

T. D.

2890

Shale & Sand	0	780
Shale	780	1330
Shale & Sand	1330	2255
Shale & Shells	2330	2560
Shale & Lime	2560	2860
Lime & Shale	2860	2890
R.T.D.		2890

48486