

7-11-31W

Sub

STATE CORPORATION COMMISSION OF KANSAS  
OIL & GAS CONSERVATION DIVISION  
WELL COMPLETION OR RECOMPLETION FORM  
ACO-1 WELL HISTORY  
DESCRIPTION OF WELL AND LEASE

API NO. 15-063-21-225  
County...Gove  
25'S of..SW..SE..SW. Sec.7... Twp.11.Rge..31. X East West

Operator: License # 3849  
Name Strategic Petroleum Limited Partnership  
Address 200 N. Pearl St.  
#2100 IR 399  
City/State/Zip Dallas, TX 75201-2831

305.... Ft North from Southeast Corner of Section  
3630.... Ft West from Southeast Corner of Section  
(Note: Locate well in section plat below)

Purchaser.....NA

Lease Name.....SWART Well # 1-7  
Field Name.....

Operator Contact Person Robert Waller  
Phone 405-840-5500

Producing Formation.....NA

Contractor: License # 5883  
Name Warrior Drilling Co

Elevation: Ground 3010 KB 3017

Wellsite Geologist Chuck Inmich  
Phone 316-684-5500

Section Plat

NOV 01 1988

KANSAS GEOLOGICAL SURVEY  
WICHITA BRANCH  
RECEIVED  
STATE CORPORATION COMMISSION

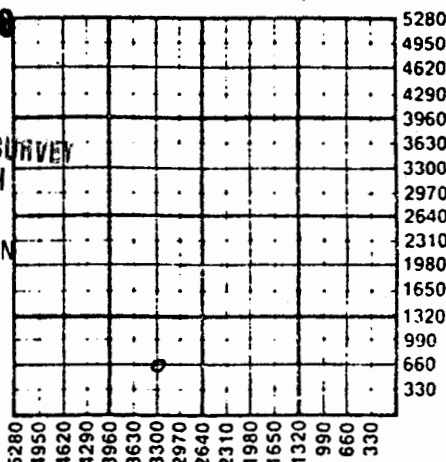

Designate Type of Completion  
X New Well Re-Entry Workover  
Oil SWD Temp Abd  
Gas Inj Delayed Comp.  
Dry Other (Core, Water Supply etc.)

NOV 31 1988

CONSERVATION DIVISION  
Wichita, Kansas

OWNO: old well info as follows:  
Operator  
Well Name  
Comp. Date Old Total Depth

WATER SUPPLY INFORMATION

Disposition of Produced Water: Disposal  
Docket # Repressuring

WELL HISTORY

Drilling Method:  
X Mud Rotary Air Rotary Cable  
10-03-88 10-10-88 10-10-88  
Spud Date Date Reached TD Completion Date  
4750' NA  
Total Depth PBTD

Questions on this portion of the ACO-1 call:  
Water Resources Board (913) 296-3717

Source of Water:  
Division of Water Resources Permit # T-88-496

X Groundwater 4630 Ft North from Southeast Corner  
(Well) 1900 Ft West from Southeast Corner of  
NE/4 Sec 7 Twp 11 Rge 31 East X West

Surface Water.....Ft North from Southeast Corner  
(Stream, pond etc).....Ft West from Southeast Corner  
Sec Twp Rge East West

Other (explain).....  
(purchased from city, R.W.D. #)

Amount of Surface Pipe Set and Cemented at 279' feet  
Multiple Stage Cementing Collar Used? Yes X No  
If yes, show depth set NA feet  
If alternate 2 completion, cement circulated  
from NA feet depth to NA w/ SX cmt  
Cement Company Name NA  
Invoice # NA

INSTRUCTIONS: This form shall be completed in triplicate and filed with the Kansas Corporation Commission, 200 Colorado Derby Building, Wichita, Kansas 67202, within 120 days of the spud date of any well. Rule 82-3-130, 82-3-107 and 82-3-106 apply.

Information on side two of this form will be held confidential for a period of 12 months if requested in writing and submitted with the form. See rule 82-3-107 for confidentiality in excess of 12 months. One copy of all wireline logs and drillers time log shall be attached with this form. Submit CP-4 form with all plugged wells. Submit CP-111 form with all temporarily abandoned wells.

All requirements of the statutes, rules and regulations promulgated to regulate the oil and gas industry have been fully complied with and the statements herein are complete and correct to the best of my knowledge.

Signature [Signature]  
Title Agent for Strategic Petroleum Inc. Date 10/27/88

K.C.C. OFFICE USE ONLY  
F Letter of Confidentiality Attached  
C Wireline Log Received  
C Drillers Timelog Received  
Distribution  
KCC SWD/Rep NGPA  
KGS Plug Other  
(Specify)

Subscribed and sworn to before me this 27 day of October 1988  
[Signature]  
Date Commission Expires August 1, 1988

Wireline logs and drillers time logs sent directly to the Kansas Geological Survey

Sec. 7 Twp. 11 Rge. 31

Operator Name ... Strategic Petroleum Limited Partnership ... Lease Name ... SWART ... Well # ... 1-7.

Sec ... 7 ... Twp ... 11S ... Rge ... 31 ... County ... GOVE

WELL LOG

INSTRUCTIONS: Show important tops and base of formations penetrated. Detail all cores. Report all drill stem tests giving interval tested, time tool open and closed, flowing and shut-in pressures, whether shut-in pressure reached static level, hydrostatic pressures, bottom hole temperature, fluid recovery, and flow rates if gas to surface during test. Attach extra sheet if more space is needed. Attach copy of log.

Drill Stem Tests Taken [ ] Yes [X] No
Samples Sent to Geological Survey [ ] Yes [ ] No
Cores Taken [ ] Yes [X] No

Formation Description [X] Log [X] Sample

Name Top Bottom

FORMATION TOPS AND STRUCTURAL POSITION

Table with columns: FORMATION, SAMPLE, DATUM, E. LOG, DATUM, A, B, C, D. Rows include ANHYDRITE, BASE OF ANHYDRITE, HEEBNER, TORBETO, LARKING, MUNGIE CREEK SHALE, STARK SHALE, BASE KANSAS CITY, PAWNER, FT. SLATT, CHAMBERLAIN SHALE, COSSUMERSHIRE, MISSISSIPPIAN, TOTAL DEPTH.

REFERENCE WELLS FOR STRUCTURAL POSITION

Table with columns: REFERENCE WELL, SECTION, T, R, S, W. Rows include BETH, INC. #1 SWART, PICKERILL #1 PIONEER 'B', PICKERILL #1 WISLAND 'H'.

CASING RECORD [X] New [ ] Used

Report all strings set-conductor, surface, intermediate, production, etc.

Table with columns: Purpose of String, Size Hole Drilled, Size Casing Set (in O.D.), Weight Lbs/Ft., Setting Depth, Type of Cement, #Sacks Used, Type and Percent Additives. Row 1: Surface, 12.1/4, 8.5/8", 20#, 279', 60/40, 20.0, 3%cc, 2%ge.

PERFORATION RECORD

Table with columns: Shots Per Foot, Specify Footage of Each Interval Perforated, Acid, Fracture, Shot, Cement Squeeze Record (Amount and Kind of Material Used), Depth.

TUBING RECORD Size Set At Packer at Liner Run [ ] Yes [ ] No

Date of First Production Producing Method [ ] Flowing [ ] Pumping [ ] Gas Lift [ ] Other (explain)

Table with columns: Oil, Gas, Water, Gas-Oil Ratio, Gravity. Row 1: Estimated Production Per 24 Hours, Bbl's, MCF, Bbl's, CFPB.

METHOD OF COMPLETION

Production Interval

Disposition of gas: [ ] Vented [ ] Sold [ ] Used on Lease [ ] Open Hole [ ] Perforation [ ] Other (Specify) [ ] Dually Completed [ ] Commingled

## FORMATION TOPS AND STRUCTURAL POSITION

FORMATION	SAMPLE	DATUM	E. LOG	DATUM	A	B	C	D
ANHYDRITE	2529	+ 484	2527	+ 486	-1	+6	+8	
BASE OF ANHYDRITE	2557	+ 456	2554	+ 459	FUT	+5	+8	
HEEDNER	4008	- 995	4005	- 992	-14	-10	-9	
TORONTO	4036	-1023	4033	-1020	-6	-8	-8	
LANING	4050	-1037	4047	-1034	-7	-8	-8	
MUNCIE CREEK SHALE	4181	-1168	4183	-1170	-15	-16	-9	
STARK SHALE	4273	-1260	4269	-1256	-17	-15	-9	
BASE KANSAS CITY	4341	-1328	4339	-1326	-21	-22	-19	
PAWNEE	4457	-1444	4460	-1447	-27	-21	-18	
FT. SLOTT	4528	-1515	4527	-1514	-27	-20	-18	
CHEROKEE SHALE	4557	-1544	4554	-1541	-26	-21	-19	
CONGLOMERATE	4624	-1611	4622	-1609	-32	-27	-28	
MISSISSIPPIAN	4664	-1651	4666	-1653	-46	-59	-38	
TOTAL DEPTH	4750	-1737	4749	-1736				

## REFERENCE WELLS FOR STRUCTURAL POSITION

A	PETX. INC. #1 SMART	APP. C NW SW	SECTION 7-T115-R31W	0
B	PICKRELL #1 PIONEER 'B'	C NE NE	SECTION 18-T115-R31W	0
C	PICKRELL #1 WIELAND 'H'	C SW SW	SECTION 8-T115-R31W	0
D				0