

8-15-31W

KANSAS CORPORATION COMMISSION
WELL RECORD

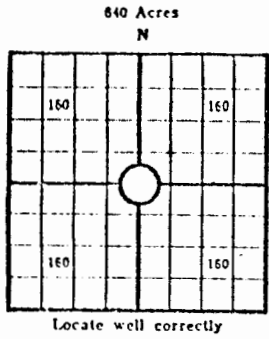

(Mail to Kansas Geological Survey, 4150 Monroe Street, Wichita, Kansas 67209)



API # 15-063-20, 102

Lease Name: Wieland "H" Well No. 1
Well Located: C SW SW
SEC 8 TWP 11S RGE 31W
Operator: Pickrell Drilling Company
Address: 705 Fourth National Bank Bldg., Wichita, Kansas
Elevation: Ground 3008' D.F. 3010' K.B. 3013
Type Well: (Oil, gas, dry hole) Oil

Drilling Commenced: 11/22 19 71 Drilling Completed: 12/9/ 19 71
Well Completed: 19 Total Depth 4670
Initial Production: _____

Casing Record

Size: 8-5/8" Set at 245' Size: _____ Set at _____
Size: 5-1/2" Set at 4668' Size: _____ Set at _____

Liner Record

Size: _____ Set from _____ To _____

Cementing

Casing Size	Sacks	Type Cement and Additives
<u>8-5/8"</u>	<u>150</u>	<u>3/2</u>
<u>5-1/2"</u>	<u>200</u>	<u>Common + 10% salt & 1/4# sack flosed.</u>

Perforations

Formation	Perforated Interval and Number Shots
<u>Pawnee Lime</u>	<u>4485-87, 4489-95' w/2 jets/ft.</u>
_____	_____
_____	_____

Electric Log Run (Show type log and depths covered)

GR-N, Guard-Cal., Sonic (Great Guns)

FORMATION, TESTING AND COMPLETION RECORD

Cont.

8-11s-31

Show Drill Stem Tests,
Well Stimulation and
Production Tests

Formation	Top	Bottom
Surface Soil	0	90
Sandy Clay	90	180
Shale	180	810
Shale & Sand Stks	810	1610
Shale & Sand	1610	2085
Shale & Lime	2085	2525
Anhydrite	2525	2590
Shale & Lime	2590	3035
Lime & Shale	3035	3130
Shale & Lime	3130	3450
Lime	3450	3740
Shale & Lime	3740	3900
Lime & Shale	3900	4040
Lime	4040	4085
Shale & Lime	4085	4110
Lime	4110	4655
Miss., RTD	4655	4670

DST # 1 4063-85 Open 1½ hrs., weak blow increasing to strong. Rec. 570 fluid, 10' clean oil, 20' OCM, 540' oil cut muddy water. IBHP 1265#/30" to 1160#/60", FP 31-284.

DST # 2 4105-4120 Open 1 hr, weak blow 50 min. rec. 20' mud w/spots of oil. BHP 1276/30" to 1139#/60", FP 21-31#.

DST # 3 4172-4205 Open 2 hrs, good blow thruout Rec. 120' gas in pipe & 250' fluid, 130' muddy oil (50% oil), 120' gassy muddy oil (70% oil), no water. BHP 1282/30".to 1255#/60#.

DST # 4 4205-4235, Open 1 hr, weak blow 10 minut Flushed. Weak blow 10 minutes. Rec. 20' of mud w/few spots oil. BHP 327#/30" to 122#/60". FP 42-52#.

DST 3 5 4230-4262, Open 1 hr, gas to surface in 40 minutes. Too small to measure. Rec. 2400' clean gassy oil, 450' muddy oil. No water. BHP 1301#/30" to 1255#/60", FP 200# to 959#.

DST # 6 4259-4285 Open 2 hrs, good blow throughout rec. 90' clean oil, 180' muddy oil, 60' OCM, 240' water. BHP 1350#/30" to 1286#/60". FP 52# to 253#.

DST # 7 4466-4500 Open 1½ hrs., gas to surface in 20 min. Too small to measure. Rec. 2900' clean gassy oil. 200' muddy, gassy oil. No water. BHP 1160#/30" to 1118#/60", FP 189# to 1044#.

DST # 8 4556-4597 Open 40 min. Weak blow for 1 min. Rec. 40' mud w/scum of oil. BHP 1234#/30" to 1160#/60" FP 42#-52#.

DST # 9 4613-4625 Open 1 hr, weak blow 10 min. Flushed Rec. 10' mud w/spots of oil. BHP 31#/30" to 52#/60" FP 31-21#.

DST # 10 4638-4650 Open 40 min. Weak blow 10 min. Flushed Rec. 30' VSOCM w/pint of free oil on top. BHP 745#/30" to 54/30", FP 21-32#.

DST # 11 4652-70 Open 2 hrs. Weak blow increasing to fair. Rec. 180' gas in pipe and 20' of clean gassy oil, 160' SOCM, 180' slightly salty water. BHP 1160#/30" to 1160#/60". FP 42# to 179#.

