

12-11-32W

State Geological Survey
WICHITA, BRANCH

KANSAS DRILLERS LOG

S. 12 T. 11 R. 32 ^E_W
Loc. SW NE
County Logan

API No. 15 — 109 — 20,026
County Number

Operator
Pickrell Drilling Company

Address 705 Fourth National Bank Building
Wichita, Kansas

Well No. #1 Lease Name City of Oakley (Airport)

Footage Location
feet from (N) (S) line feet from (E) (W) line

Principal Contractor Geologist
Pickrell Drilling Co. Dan Bowles

Spud Date Total Depth P.B.T.D.
9/4/73 4640

Date Completed Oil Purchaser
9/17/73

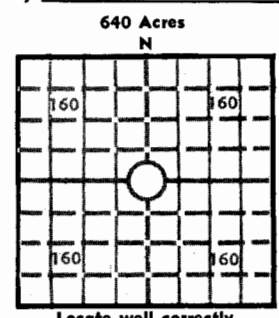

Elev.: Gr. _____
DF _____ KB 3039

CASING RECORD

Report of all strings set — surface, intermediate, production, etc.

Purpose of string	Size hole drilled	Size casing set (in O.D.)	Weight lbs/ft.	Setting depth	Type cement	Sacks	Type and percent additives
Surface casing	8 5/8"	8 5/8"		284'	Common	160	
Prod. casing	4 1/2"	4 1/2"		4633'	Common	225	

LINER RECORD

PERFORATION RECORD

Top, ft.	Bottom, ft.	Sacks cement	Shots per ft.	Size & type	Depth interval

Size	Setting depth	Packer set at

ACID, FRACTURE, SHOT, CEMENT SQUEEZE RECORD

Amount and kind of material used	Depth interval treated

INITIAL PRODUCTION

Date of first production		Producing method (flowing, pumping, gas lift, etc.)			
RATE OF PRODUCTION PER 24 HOURS	Oil	Gas	Water	Gas-oil ratio	
	bbls.	bbls.	MCF	bbls.	CFPB
Disposition of gas (vented, used on lease or sold)			Producing interval (s)		

INSTRUCTIONS: As provided in KCC Rule 82-2-125, within 90 days after completion of a well, one completed copy of this Drillers Log shall be transmitted to the State Geological Survey of Kansas, 4150 Monroe Street, Wichita, Kansas 67209. Copies of this form are available from the Conservation Division, State Corporation Commission, 3830 So. Meridian (P.O. Box 17027), Wichita, Kansas 66217. Phone AC 316-522-2206. If confidential custody is desired, please note Rule 82-2-125. Drillers Logs will be on open file in the Oil and Gas Division, State Geological Survey of Kansas, Lawrence, Kansas 66044.

Operator		DESIGNATE TYPE OF COMP.: OIL, GAS, DRY HOLE, SWDW, ETC.:
Well No. 1		Oil
Lease Name		City of Oakley (Airport)
S _____ T _____ R _____ E _____ W _____		

WELL LOG

Show all important zones of porosity and contents thereof; cored intervals, and all drill-stem tests, including depth interval tested, cushion used, time tool open, flowing and shut-in pressures, and recoveries.

SHOW GEOLOGICAL MARKERS, LOGS RUN, OR OTHER DESCRIPTIVE INFORMATION.

FORMATION DESCRIPTION, CONTENTS, ETC.	TOP	BOTTOM	NAME	DEPTH
Clay & Shale	0	284		
Shale & Shells	284	1740		
Shale & Sand	1740	2215		
Red Beds	2215	2250		
Anhydrite	2250	2585		
Shale & Shells	2585	2900		
Shale	2900	3010		
Shale & Lime	3010	3375		
Lime & Shale	3375	3475		
Shale & Lime	3475	3695		
Lime & Shale	3695	3895		
Shale & Lime	3895	3995		
Lime & Shale	3995	4060		
Lime RTD	4060	4640		
DST #1, 4072-94, open 2 hours. Rec. 1260' SW. ISIP 1236#/30", FSIP 1206#/60", FP 75-647#.				
DST #2, 4116-38, open 2 hrs., rec. 120' gas in pipe, 60' clean oil & 30' heavily oil cut mud. ISIP 888#/30", FSIP 797#/60", FP 45-75#.				
DST #3, 4239-74, open 2 hrs. Rec. 780' gas in pipe, 540' total fluid = 240' clean oil (38° API), 240' mud cut oil & 60' oil cut mud. ISIP 1009#/30", FSIP 1009#/60", FP 45-255#.				
DST #4, 4272-4304, open 2 hrs. Rec. 2460' gas in pipe, 840' total fluid = 660' clean gassy oil (36° API), 180' oil cut mud. ISIP 1206#/30", FSIP 1145#/60", FP 60-346#.				
DST #5, 4484-4519, open 1 hr. Rec. 30' mud. ISIP 60#/30", FSIP 60#/30", FP 60-60#.				
DST #6, 4514-49, open 2 hrs. Rec. 150' gas in pipe, 30' clean oil & 60' oil cut mud. ISIP 526#/30", FSIP 617#/60", FP 60-90#.				
DST #7, 4571-4641, open 1 hr. Rec. 30' oil cut mud. ISIP 105#/30", FSIP 90#/30", FP 60-75#.				

USE ADDITIONAL SHEETS, IF NECESSARY, TO COMPLETE WELL RECORD.

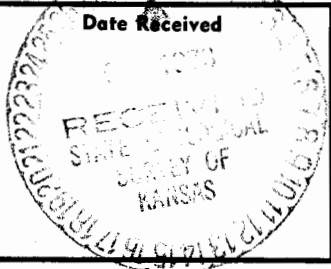

Signature _____

Title _____

Date _____

04-1001

12-11-32W

640 Acres

N

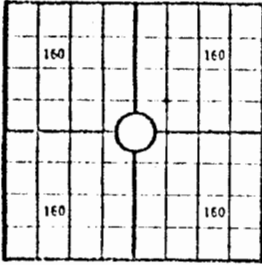

Locate well correctly

Lease Name: City of Oakley (Airport) Well No. 1

Well Located: C SW NE

SEC 12 TWP 11S RGE 32W

Operator: Pickrell Drilling Company

Address: 705 Fourth National Bank Building, Wichita, Ks. 67202

Elevation: Ground D.F. K.B. 3039 K.B.

Type Well: (Oil, gas, dry hole) Oil

Drilling Commenced: Sept. 4 19 73 Drilling Completed: Sept. 17 19 73
 Well Completed: Sept. 17 19 73 Total Depth 4640'
 Initial Production: N/A

Casing Record

Size: 8 5/8" Set at 284' Size: Set at
 Size: 4 1/2" Set at 4633' Size: Set at

Liner Record

Size: Set from To

Cementing

<u>Casing Size</u>	<u>Sacks</u>	<u>Type Cement and Additives</u>
<u>8 5/8"</u>	<u>160 sx</u>	<u>Common</u>
<u>4 1/2"</u>	<u>225</u>	<u>Common</u>
<u> </u>	<u> </u>	<u> </u>

Perforations

<u>Formation</u>	<u>Perforated Interval and Number Shots</u>
<u> </u>	<u> </u>
<u> </u>	<u> </u>
<u> </u>	<u> </u>

Electric Log Run (Show type log and depths covered)

Great Guns Gamma Ray Neutron Guard Cliper

(Fill in formation and related information on reverse side)

FORMATION, TESTING AND COMPLETION RECORD

Show Drill Stem Tests,
Well Stimulation and
Production Tests

Formation	Top	Bottom	
Clay & Shale	0	284	
Shale & Shells	284	1740	DST #1, 4072-94, open 2 hours. Rec. 1260' salt water. ISIP 1236#/30", FSIP 1206#/60", FP 75-647#.
Shale & Sand	1740	2215	
Red Beds	2215	2250	
Anhydrite	2250	2585	
Shale & Shells	2585	2900	DST #2, 4116-38, open 2 hours, Rec. 120' gas in pipe, 60' clean oil & 30' heavily oil cut mud. ISIP 888#/30", FSIP 797#/60", FP 45-75#.
Shale	2900	3010	
Shale & Lime	3010	3375	
Lime & Shale	3375	3475	DST #3, 4239-74, open 2 hours. Rec. 780' gas in pipe, 540' total fluid = 240' clean oil (38° API), 240' mud cut oil & 60' oil cut mud. ISIP 1009#/30", FSIP 1009#/60", FP 45-255#.
Shale & Lime	3475	3695	
Lime & Shale	3695	3895	DST #4, 4272-4304, open 2 hours, rec. 2460' gas in pipe, 840' total fluid = 660' clean gassy oil (36° API), 180' oil cut mud. ISIP 1206#/30", FSIP 1145#/60", FP 60-346#.
Shale & Lime	3895	3995	
Lime & Shale	3995	4060	DST #5, 4484-4519, open 1 hour. REc. 30' mud. ISIP 60#/30", FSIP 60#/30", FP 60-60#.
Lime, RTD	4060	4640	
			DST #6, 4514-4549, open 2 hours. REc. 150' gas in pipe, 30' clean oil & 60' oil cut mud. ISIP 526#/30", FSIP 617#/60", FP 60-90#.
			DST #7, 4571-4641, open 1 hour. Rec. 30' oil cut mud. ISIP 105#/30", FSIP 90#/30", FP 60-75#.

