

Geological Survey

WICHITA, BRANCH

KANSAS DRILLERS LOG

IMPORTANT
 Kans. Geo. Survey request
 samples on this well.

API No. 15 — 109 — 20,052
 County Number

S. 32 T. 11 R. 32 ^R/_W
 Loc. C SE SW
 County Logan

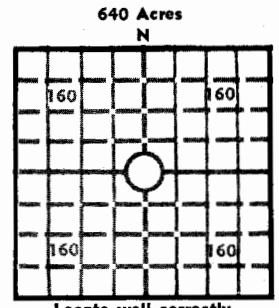

Elev.: Gr. 3058
 DF 3061 KB 3063

Operator
Chief Drilling Co., Inc. & Bill J. Porter

Address
905 Century Plaza Wichita, Kansas 67202

Well No. #1 Lease Name Holmberg

Footage Location
 feet from (N) (S) line _____ feet from (E) (W) line _____

Principal Contractor Company Tools Geologist Tom Wesselowski

Spud Date 12/18/75 Total Depth 4703' P.B.T.D. _____

Date Completed 1/5/76 Oil Purchaser _____

CASING RECORD

Report of all strings set — surface, intermediate, production, etc.

Purpose of string	Size hole drilled	Size casing set (in O.D.)	Weight lbs/ft.	Setting depth	Type cement	Sacks	Type and percent additives
	12 1/4"	8 5/8"	28 lb.	257'	quick set	170	

LINER RECORD

PERFORATION RECORD

Top, ft.	Bottom, ft.	Sacks cement	Shots per ft.	Size & type	Depth interval

TUBING RECORD

Size	Setting depth	Packer set at

ACID, FRACTURE, SHOT, CEMENT SQUEEZE RECORD

Amount and kind of material used	Depth interval treated

INITIAL PRODUCTION

Date of first production _____ Producing method (flowing, pumping, gas lift, etc.) _____

RATE OF PRODUCTION PER 24 HOURS	Oil	Gas	Water	Gas-oil ratio
	bbis.	MCF	bbis.	CFPB

Disposition of gas (vented, used on lease or sold) _____ Producing interval (s) _____

INSTRUCTIONS: As provided in KCC Rule 82-2-125, within 90 days after completion of a well, one completed copy of this Drillers Log shall be transmitted to the State Geological Survey of Kansas, 4150 Monroe Street, Wichita, Kansas 67209. Copies of this form are available from the Conservation Division, State Corporation Commission, 3830 So. Meridian (P.O. Box 17027), Wichita, Kansas 66217. Phone AC 316-522-2206. If confidential custody is desired, please note Rule 82-2-125. Drillers Logs will be on open file in the Oil and Gas Division, State Geological Survey of Kansas, Lawrence, Kansas 66044.

Operator

Chief Drilling Co., Inc.

DESIGNATE TYPE OF COMP.: OIL, GAS, DRY HOLE, SWDW, ETC.:

Well No.

#1

Lease Name

Holmberg

Dry Hole

S 32 T 11S R 32W^E_W

WELL LOG

Show all important zones of porosity and contents thereof; cored intervals, and all drill-stem tests, including depth interval tested, cushion used, time tool open, flowing and shut-in pressures, and recoveries.

SHOW GEOLOGICAL MARKERS, LOGS RUN, OR OTHER DESCRIPTIVE INFORMATION.

FORMATION DESCRIPTION, CONTENTS, ETC.	TOP	BOTTOM	NAME	DEPTH
DST #1 4133-4165' Open 30 Shut 30 Open 90 Shut 30 Weak steady blow Rec. 600' water IBHP: 1250# FBHP: 1162# FP: 60-366#			Anhydrite Base Anhy. Heebner Toronto Lansing Base K.C. Marmaton Ft. Scott Cheorkee	2592 2618 4023 4051 4068 4352 4389 4541 4565
DST #2 4232-4280' Open 30 Shut 30 Open 60 Shut 30 Weak steady blow Rec. 70' VS10CM IBHP: 533# FBHP: 333# FP: 38-58#			Miss. LTD	4655 4703
DST #3 4570-4635' Open 30 Shut 30 Open 90 Shut 60 Good blow. Rec. 1000' OCMW 340' water IBHP: 1175# FBHP: 1125# FP: 73-633#				

USE ADDITIONAL SHEETS, IF NECESSARY, TO COMPLETE WELL RECORD.

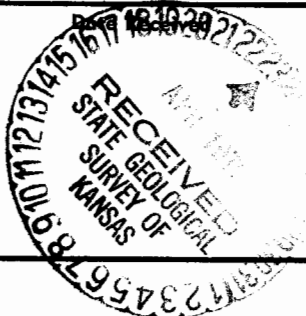

Jim Robinson

Signature

Jim Robinson, Vice President

Title

January 6, 1976

Date

101018