

15-609-20088

State Geological Survey

WICHITA BRANCH  
KANSAS DRILLERS LOG

API No. 15 \_\_\_\_\_ County \_\_\_\_\_ Number \_\_\_\_\_

Operator  
Donald C. Slawson

Address  
200 Douglas Building, Wichita, Kansas 67202

Well No. #1 Lease Name Voth 'K'

Footage Location  
2080 feet from (N) (S) line 2310' feet from (E) (W) line

Principal Contractor Slawson Drilling Co., Inc. Geologist Ralph Ruwwe

Spud Date 8/27/77 Total Depth 4780 P.B.T.D. N/A

Date Completed 9/5/77 Oil Purchaser N/A

S. 21 T. 11 R. 33W  
Loc. 200' S NE NE SW  
County Logan

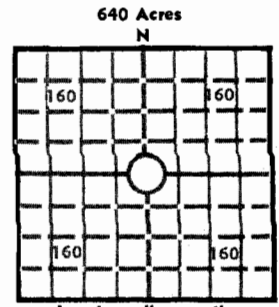

Elev.: Gr. 3144  
DF 3146 KB 3149

CASING RECORD

Report of all strings set — surface, intermediate, production, etc.

Purpose of string	Size hole drilled	Size casing set (in O.D.)	Weight lbs/ft.	Setting depth	Type cement	Sacks	Type and percent additives
Surface	12 1/4"	8 5/8"	28#	278'	60/40 poz	200	2% gel, 3% cc

LINER RECORD

PERFORATION RECORD

Top, ft.	Bottom, ft.	Sacks cement	Shots per ft.	Size & type	Depth interval

TUBING RECORD

Size	Setting depth	Packer set at

ACID, FRACTURE, SHOT, CEMENT SQUEEZE RECORD

Amount and kind of material used	Depth interval treated

INITIAL PRODUCTION

Date of first production	Producing method (flowing, pumping, gas lift, etc.)
RATE OF PRODUCTION PER 24 HOURS	Oil bbls. Gas MCF Water bbls. Gas-oil ratio CFPB
Disposition of gas (vented, used on lease or sold)	Producing interval (s)

INSTRUCTIONS: As provided in KCC Rule 82-2-125, within 90 days after completion of a well, one completed copy of this Drillers Log shall be transmitted to the State Geological Survey of Kansas, 4150 Monroe Street, Wichita, Kansas 67209. Copies of this form are available from the Conservation Division, State Corporation Commission, 3830 So. Meridian (P.O. Box 17027), Wichita, Kansas 66217. Phone AC 316-522-2206. If confidential custody is desired, please note Rule 82-2-125. Drillers Logs will be on open file in the Oil and Gas Division, State Geological Survey of Kansas, Lawrence, Kansas 66044.

Operator Donald C. Slawson DESIGNATE TYPE OF COMP.: OIL, GAS, DRY HOLE, SWDW, ETC.: dry hole

Well No. #1 Lease Name Voth 'K'

S 21 T 11 R 33

**WELL LOG**

Show all important zones of porosity and contents thereof; cored intervals, and all drill-stem tests, including depth interval tested, cushion used, time tool open, flowing and shut-in pressures, and recoveries.

SHOW GEOLOGICAL MARKERS, LOGS RUN, OR OTHER DESCRIPTIVE INFORMATION.

FORMATION DESCRIPTION, CONTENTS, ETC.	TOP	BOTTOM	NAME	DEPTH
0 - 281 Surface hole			LOG TOPS	
281 - 1908 Shale and shells			ANH 2633 (+516)	
1908 - 2282 Shale, shells and sand			B/ANH 2661 (+488)	
2282 - 2404 Shale			WAB 3696 (-547)	
2404 - 2637 Shale and shells			HEEB 4058 (-909)	
2637 - 2661 Anhydrite			TORO 4082 (-933)	
2661 - 2947 Shale and shells			LANS 4098 (-949)	
2947 - 4096 Shale and Lime			STK 4324 (-1175)	
4096 - 4542 Lime			B/KC 4383 (-1234)	
4542 - 4558 Lime and shale			PAWN 4520 (-1371)	
4558 - 4780 Lime			L/CK 4606 (-1457)	
4780 RTD			JH ZN 4651 (-1502)	
			SD 4712 (-1563)	
			MISS 4730 (-1581)	
			LTD 4779 (-1630)	
DST #1 4325-4360 (200' zn), VWB Rec. 25' M, NS, IFP 37-37#, ISIP 1315#, FFP 37-37#, FSIP 1297#, 115°				

USE ADDITIONAL SHEETS, IF NECESSARY, TO COMPLETE WELL RECORD.

Date Received	
	R.J. Thatcher Signature
	R.J. Thatcher Title
	October 5, 1977 Date

101344

WELL LOG

21-11-33W

OPERATOR: Donald C. Slawson  
200 Douglas Building  
Wichita, Kansas 67202

LEASE: #1 Voth 'K'  
200' S/NE NE SW Sec. 21-11-33W  
Logan County, Kansas

CONTRACTOR: Slawson Drilling Co., Inc.

COMMENCED: August 27, 1977

COMPLETED: September 5, 1977

CASING: 8 5/8" @ 278' w/200 sx 60/40 poz

0 - 281	Surface hole
281 - 1908	Shale and shells
1908 - 2282	Shale, shells and sand
2282 - 2404	Shale
2404 - 2637	Shale and shells
2637 - 2661	Anhydrite
2661 - 2947	Shale and shells
2947 - 4096	Shale and Lime
4096 - 4542	Lime
4542 - 4558	Lime and shale
4558 - 4780	Lime
4780	RTD

STATE OF KANSAS        )  
                              )  
                              )        SS.  
COUNTY OF SEDGWICK )

I, R.J. Thatcher, of the Slawson Drilling Company, Inc. upon oath state that the above and foregoing is a true and correct copy of the log of the #1 Voth 'K' test.

  
\_\_\_\_\_  
R.J. Thatcher