

State Geological Survey
WICHITA, BRANCH

KANSAS DRILLERS LOG

API No. 15 — 109 — 20047
County Number

408
5 1975

S. 15 T. 11 R. 33W ^E _W

Loc. NW SW NE

County Logan

Operator
Donald C. Slawson

Address
408 120 Bldg. Wichita, Kansas 67202

Well No. 1 Lease Name Pinkston "A"

Footage Location
feet from (N) (S) line _____ feet from (E) (W) line _____

Principal Contractor Slawson Drlg. Co., Inc. Geologist George Mueller

Spdd-Date July 7, 1975 Total Depth 4682 P.B.T.D. _____

Date Completed July 18, 1975 Oil Purchaser N/A

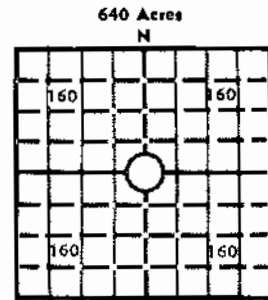

Locate well correctly
Elev.: Gr. 3148
DF 3150 KB 3153

CASING RECORD

Report of all strings set—surface, intermediate, production, etc.

Purpose of string	Size hole drilled	Size casing set (in O.D.)	Weight lbs/ft.	Setting depth	Type cement	Socks	Type and percent additives
Surface	12 1/2"	8 5/8"		250'	60/40 Poz	200 sx	

LINER RECORD

PERFORATION RECORD

Top, ft.	Bottom, ft.	Sacks cement	Shots per ft.	Size & type	Depth interval

TUBING RECORD

Size	Setting depth	Packer set at

ACID, FRACTURE, SHOT, CEMENT SQUEEZE RECORD

Amount and kind of material used	Depth interval treated

INITIAL PRODUCTION

Date of first production _____ Producing method (flowing, pumping, gas lift, etc.) _____

RATE OF PRODUCTION PER 24 HOURS	Oil	Gas	Water	Gas-oil ratio
	bbls.	MCF	bbls.	CFPB

Disposition of gas (vented, used on lease or sold) _____ Producing interval (s) _____

INSTRUCTIONS: As provided in KCC Rule 82-2-125, within 90 days after completion of a well, one completed copy of this Drillers Log shall be transmitted to the State Geological Survey of Kansas, 4150 Monroe Street, Wichita, Kansas 67209. Copies of this form are available from the Conservation Division, State Corporation Commission, 3830 So. Meridian (P.O. Box 17027), Wichita, Kansas 66217. Phone AC 316-522-2206. If confidential custody is desired, please note Rule 82-2-125. Drillers Logs will be on open file in the Oil and Gas Division, State Geological Survey of Kansas, Lawrence, Kansas 66044.

96858

Operator Donald C. Slawson		DESIGNATE TYPE OF COMP.: OIL, GAS, DRY HOLE, SWDW, ETC.: Dry Hole
Well No. 1	Lease Name Pinkston "A"	
S 15 T 11 R 33W E W		

WELL LOG

Show all important zones of porosity and contents thereof; cored intervals, and all drill-stem tests, including depth interval tested, cushion used, time tool open, flowing and shut-in pressures, and recoveries.

SHOW GEOLOGICAL MARKERS, LOGS RUN, OR OTHER DESCRIPTIVE INFORMATION.

FORMATION DESCRIPTION, CONTENTS, ETC.	TOP	BOTTOM	NAME	DEPTH
			EL tops	
Surface Hole	0	255	Anhy	2641 (+512)
Shale & Shells	255	2641	Heeb	4066 (-913)
Anhydrite	2641	2668	Tor	4095 (-942)
Shale & Shells	2668	2903	Lans	4110 (-957)
Shale	2903	3168	Stark	4330 (-1177)
Shale & Lime	3168	4123	B/KC	4386 (-1233)
Lime	4123	4682	Marm	4416 (-1263)
RTD	4682		Paw	4528 (-1375)
			Up/Ch	4575 (-1422)
			Lwr/Ch	4608 (-1455)
			John. Zn	4651 (-1498)
			LTD	4683 (-1530)
<p>DST #1 4170-4200, 30-45-45-60, weak ing to strong blow, rec. 610' Mdy SW, IFP 18-194#, FFP 194-323#, ISIP 1229#, FSIP 1192#.</p> <p>DST #2 4324-53, 30-45-30-30, weak blow 30" rec. 50' mud SSC, IFP 27-37#, FFP 37-37#. ISIP 1247#, FSIP 803#.</p> <p>DST #3 4602-59, 30-45-45-60, weak to fair blow rec. 82' OCM, IFP 46-56#, FFP 74-92#, ISIP 776#, FSIP 342#.</p>				



USE ADDITIONAL SHEETS, IF NECESSARY, TO COMPLETE WELL RECORD.

Date Received	<i>James C. Resenberg</i>
	James C. Resenberg Petroleum Engineer
	Title
	July 30, 1975
	Date

OPERATOR: Donald C. Slawson
 408 120 Bldg.
 Wichita, Kansas 67202

LEASE: #1 Pinkston "A"
 NW SW NE of Sec. 15-11-33W
 Logan County, Kansas

CONTRACTOR: Slawson Drilling Company, Inc.

COMMENCED: July 7, 1975

COMPLETED: July 18, 1975

CASING: Set 8 5/8" @ 250' w/200 sx

TOTAL DEPTH: 4682 feet

15-11-33W

15-109-20,047

0 - 255 Surface Hole
 255 - 2641 Shale & Shells
 2641 - 2668 Anhydrite
 2668 - 2903 Shale & Shells
 2903 - 3168 Shale
 3168 - 4123 Shale & Lime
 4123 - 4682 Lime
 4682 RTD



STATE OF KANSAS)
) SS.
 COUNTY OF SEDGWICK)

I, JAMES C. REMSBERG, of the Slawson Drilling Company, Inc. upon oath state that the above and foregoing is a true and correct copy of the log of the #1 Pinkston "A" well.

James C. Remsberg

 JAMES C. REMSBERG

Subscribed and sworn to before me this 30th day of July, 1975

Dolores B. Coady

 Dolores B. Coady, Notary Public

My Commission Expires:

