

State Geological Survey
WICHITA BRANCH

KANSAS DRILLERS LOG

API No. 15 — 109 — 20047 20039 (DRL 1/40)

S. 15 T. 11 R. 33W E

Loc. C SE SE

County Logan

Operator
Donald C. Slawson

Address
408 120 Bldg. Wichita, Kansas 67202

Well No. 1 Lease Name Pinkston 'B'

Footage Location
660 feet from (N) line 660 feet from (W) line

Principal Contractor Slawson Drlg. Co., Inc. Geologist Ralph Ruwwe

Spud Date March 28, 1975 Total Depth 4720 P.B.T.D. 4667

Date Completed April 11, 1975 Oil Purchaser Koch

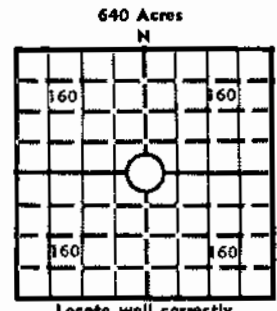

Elev.: Gr. 3135
DF 3137 KB 3140

CASING RECORD

Report of all strings set — surface, intermediate, production, etc.

Purpose of string	Size hole drilled	Size casing set (in O.D.)	Weight lbs/ft.	Setting depth	Type cement	Sacks	Type and percent additives
Surface	12 1/2"	8 5/8"		248	60/40 Poz	175 sx	
Production	7 7/8"	4 1/2"	10.5	4717	50/50 Poz	150 sx	18% salt 3/4 % CFR-2

LINER RECORD

PERFORATION RECORD

Top, ft.	Bottom, ft.	Sacks cement	Shots per ft.	Size & type	Depth interval
			2	jet shots	4636-43'

TUBING RECORD

Size	Setting depth	Packer set at
2 3/8"	4648	

ACID, FRACTURE, SHOT, CEMENT SQUEEZE RECORD

Amount and kind of material used	Depth interval treated
1500 ga MOD 202	4636-43'

INITIAL PRODUCTION

Date of first production 4-29-75 Producing method (flowing, pumping, gas lift, etc.) Pumping

RATE OF PRODUCTION PER 24 HOURS
Oil 215 Gas 38 Water 38 Gas-oil ratio
bbls. MCF bbls. CFPB

Disposition of gas (vented, used on lease or sold) Producing interval (s)
4636-43

INSTRUCTIONS: As provided in KCC Rule 82-2-125, within 90 days after completion of a well, one completed copy of this Drillers Log shall be transmitted to the State Geological Survey of Kansas, 4150 Monroe Street, Wichita, Kansas 67209. Copies of this form are available from the Conservation Division, State Corporation Commission, 3830 So. Meridian (P.O. Box 17027), Wichita, Kansas 66217. Phone AC 316-522-2206. If confidential custody is desired, please note Rule 82-2-125. Drillers Logs will be on open file in the Oil and Gas Division, State Geological Survey of Kansas, Lawrence, Kansas 66044.

90859

Operator Donald C. Slawson		DESIGNATE TYPE OF COMP.: OIL, GAS, DRY HOLE, SWDW, ETC.:
Well No. 1	Lease Name Pinkston 'B'	Oil
S 15 T 11 R 33W E W		

WELL LOG

Show all important zones of porosity and contents thereof; cored intervals, and all drill-stem tests, including depth interval tested, cushion used, time tool open, flowing and shut-in pressures, and recoveries.

SHOW GEOLOGICAL MARKERS, LOGS RUN,
OR OTHER DESCRIPTIVE INFORMATION.

FORMATION DESCRIPTION, CONTENTS, ETC.	TOP	BOTTOM	NAME	DEPTH
			El tops	
Sand & Shale	0	389	Anhy	2628 (+512)
Shale	389	1456	Heeb	4049 (-909)
Shale & Sand	1456	1832	Tor	4078 (-938)
Shale & Shells	1832	2957	Lans	4094 (-954)
Lime & Shale	2957	3933	Stark	4313 (-1173)
Lime	3933	4696	B/KC	4373 (-1233)
Mississippi	4696	4720	Marm	4404 (-1264)
RTD	4720		Pawnee	4511 (-1371)
			L/Cher	4591 (-1451)
			Congl	4653 (-1513)
			Sand	4669 (-1529)
			Miss	4696 (-1556)
			LTD	4718 (-1578)
<p>DST #1 4154-4178, 30,45,45,60, wk bl inc to fair, rec 135' oil-spotted mud (10% wtr-grindout), IBHP 1283#, IFP 32-56#, FBHP 1264#, FFP 53-95#.</p> <p>DST # 2 4216-4290, 30,45,45,60, wk bl throughout, rec. 35' OCM. (20% oil, 2% wtr, 1' free oil), IBHP 870#, IFP 56-59#, FBHP 878#, FFP 66-72#.</p> <p>DST #3 4286-4318, 30,30,30,30, vy. wk bl 50", rec. 15' mud, no show, IBHP 40-43#, IFP 40-43#, FBHP 987#, FFP 47-51#.</p> <p>DST #4 4584-4660, 30,45,45,60, GTS-2 hrs strong blow thruout, rec. 2350' total fluid, 1025' clean gassy oil (GR 25° Approx) 1325' muddy, gassy oil (5% mud) Bottom Grindout - 6% mud - 1% wtr. IBHP 1147#, IFP 231-662#, FBHP 1146#, FFP 68-957#.</p> <p><u>Completion Data</u> Perf 4636-43 w/2 JSPF: Swbd 15 BOPH, 25° API, (500' OB): 3150' FU (all oil): 1500 GA MOD 202: trtg rt 2 BPM @ 50#, ISIP o#: Set 2 Hrs: Swbd ld & swbd tstd 1650' OB, 50+ BOPH: Ran tbg & rds. State Potential - 215.07 BOPD, 15% wtr.</p>				

USE ADDITIONAL SHEETS, IF NECESSARY, TO COMPLETE WELL RECORD.

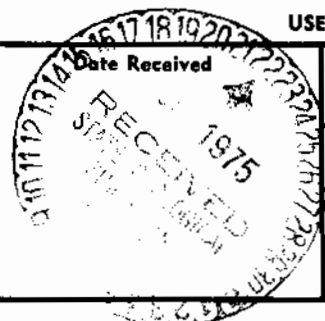

James C. Reusch
James C. Reusch
Petroleum Engineer
Title
July 21, 1975
Date

