

State Geological Survey
WICHITA, BRANCH

KANSAS DRILLERS LOG

API No. 15 — 167 — 20,837
County Number

S. 8 T. 12 R. 15 ^W_W

Loc. NE SW NE

County Russell

Operator
Sohio Petroleum Company

Address
Box 673 Russell, Kansas 67665

Well No. #27 Lease Name Oswald-Wilcox "A"

Footage Location
1650 feet from (N) line 1650' feet from (E) line

Principal Contractor
Abercrombie Drilling, Inc. Geologist Francis Whisler

Spud Date 1/25/76 Total Depth 3192' P.B.T.D. 2435'

Date Completed April 14, 1976 Oil Purchaser Sohio Petroleum Company

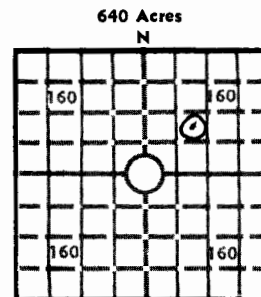

Elev.: Gr. 1751'

DF 1757' KB 1758'

CASING RECORD

Report of all strings set — surface, intermediate, production, etc.

Purpose of string	Size hole drilled	Size casing set (in O.D.)	Weight lbs/ft.	Setting depth	Type cement	Sacks	Type and percent additives
Surface	12-1/4"	8-5/8"	28#	125' RDB	Common	125 sx	2% salt, 3% CaCl
Production	7-7/8"	5-1/2"	14#	3189' RDB	Howcolite 50/50 POZ	175 sx 150 sx	10# Gil, 18% slt, 34% CFR-2
		DV tool @		821'	Howcolite	225 sx	10# Gil

LINER RECORD

PERFORATION RECORD

Top, ft.	Bottom, ft.	Sacks cement	Shots per ft.	Size & type	Depth interval
	None			See back.	

Size	Setting depth	Packer set at
2-7/8	2401'	None

ACID, FRACTURE, SHOT, CEMENT SQUEEZE RECORD

Amount and kind of material used	Depth interval treated
See back	See back

INITIAL PRODUCTION

Date of first production 4-15-76	Producing method (flowing, pumping, gas lift, etc.) Pumping
RATE OF PRODUCTION PER 24 HOURS	Oil 152 bbls. Gas --- MCF Water 17 bbls. Gas-oil ratio --- CFPB
Disposition of gas (vented, used on lease or sold) None	Producing interval(s) 2399-2408 3rd Tarkio

INSTRUCTIONS: As provided in KCC Rule 82-2-125, within 90 days after completion of a well, one completed copy of this Drillers Log shall be transmitted to the State Geological Survey of Kansas, 4150 Monroe Street, Wichita, Kansas 67209. Copies of this form are available from the Conservation Division, State Corporation Commission, 3830 So. Meridian (P.O. Box 17027), Wichita, Kansas 66217. Phone AC 316-522-2206. If confidential custody is desired, please note Rule 82-2-125. Drillers Logs will be on open file in the Oil and Gas Division, State Geological Survey of Kansas, Lawrence, Kansas 66044.

DESIGNATE TYPE OF COMP.: OIL, GAS, DRY HOLE, SWDW, ETC.:

Operator: Sohio Petroleum Company
 Well No. 27 Lease Name: Oswald-Wilcox "A"
 S 8 T 12S R 15 W

Oil

WELL LOG

Show all important zones of porosity and contents thereof; cored intervals, and all drill-stem tests, including depth interval tested, cushion used, time tool open, flowing and shut-in pressures, and recoveries.

SHOW GEOLOGICAL MARKERS, LOGS RUN, OR OTHER DESCRIPTIVE INFORMATION.

FORMATION DESCRIPTION, CONTENTS, ETC.	TOP	BOTTOM	NAME	DEPTH
DST #1 - 2387-2420 Tool open 20 min with weak to fair blow, tool shut in 60 min, tool open 60 min with good to strong blow, tool shut in 90 min.			Grand Haven	2297'
Recovery: 186' of gas in pipe, 248' of slight oil and gas cut mud.			Dover Lime	2330'
IBHP: 331 PSI, IFP: 98 to 107 PSI FBHP: 322 PSI, FFP: 116 to 134 PSI			1st Tarkio Sd	2314'
Logs: GR-Neut. Guard w/Caliper			Dover Lime	2330'
History: TD 3192'			2nd Tarkio Sd	2332'
Acidize open hole 3189' - 3192' w/250 gal 15% NE acid, tested.			Tarkio Lime	2370'
Perf. 2614-19 2 JSPF acidize w/500 gal 28% NE			3rd Tarkio Sd	2398'
2892-98 " " " " " " "			Elmont Lime	2423'
2912-16 " " " " " " "			Topeka Lime	2611'
2926-30 " " " " " " "			Heebner Shale	2832'
Set BP @ 3170' tested above zones.			Toronto Lime	2853'
Set BP @ 2460'			L-KC	2887'
Perf 2399-2408 w/2 DWL #3 shots/ft. Set BP @ 2445' w/1 sk cement on top. Top of cement @ 2435' Acidized 2399-2408' w/350 gallon 15% HCL w/135 gal aromatic solvent & 15 gal Parachek 140. Fraced 2399-2408' w/3000 gal pad, 7500 gal sand. Carrying fluid, 2500 gal flush & 17,250# 10-20 sand. Ran tubing and rods, put well on pump.			Arbuckle	3188'

USE ADDITIONAL SHEETS, IF NECESSARY, TO COMPLETE WELL RECORD.

Date Received

W. Z. Ward
 Signature
 District Superintendent
 Title
 May 13, 1976
 Date

100523

OPERATOR: Sohio Petroleum Company
 CONTRACTOR: Abercrombie Drilling, Inc.
 WELL NAME: OSWALD-WILCOX "A" #27
 LOCATION: NE SW NE Section 8-12S-15W
 Russell County, Kansas
 SPUD DATE: January 25, 1976
 COMPLETION DATE: February 2, 1976

0	15	Clay
15	55	Rock
55	260	Shale
260	340	Sand
340	650	Shale
650	690	Sand
690	807	Shale
807	843	Anhydrite
843	1140	Shale
1140	1890	Shale & Lime
1890	2516	Lime & Shale
2516	3195	Lime
	3195	Rotary Total Depth

Drilled 127' of 12½" hole. Ran 3 jts. of 8 5/8" casing, Set @ 125.20' K.B. Cemented with 125 sx. Common Cement, 2% salt, 3% ca. cl. Cement circulated. Plug was down @ 10:45 p.m. January 25, 1976.

Ran 99 jts. of 5½" Set @ 3189' with 175 sx. on bottom, 225 top. Top stage to cement. Plug was down @ 8:45 a.m. February 2, 1976.

SAMPLE TOPS

Anhydrite 807'
 B/Anhydrite 843'

STATE OF KANSAS)
) SS
 COUNTY OF SEDGWICK)

Jerry A. Langrehr-Executive Vice President of Abercrombie Drilling, Inc., does hereby state that the above and foregoing is a true and correct copy of the log of the OSWALD-WILCOX "A" #27 NE SW NE Section 8-12S-15W Russell County, Kansas.

ABERCROMBIE DRILLING, INC.

By: Jerry A. Langrehr
 Jerry A. Langrehr-Exec. V.P.