

KANSAS CORPORATION COMMISSION

WELL RECORD

32-12-17W

(Mail to Kansas Geological Survey, 4150 Monroe Street, Wichita, Kansas 67209)

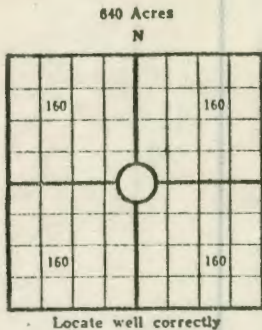

Locate well correctly

Lease Name: Staab Well No. 3
 Well Located: Ellis County, Kansas
SE NW SE SEC 32 TWP 12 RGE 17W
 Operator: Beacon Resources Corporation
 Address: 1000 Century Plaza, Wichita, Kansas 67202
 Elevation: Ground 2076 D.F. 2078' K.B. 2081
 Type Well: (Oil, gas, dry hole) Oil

Drilling Commenced: 11-14 1971 Drilling Completed: 11/22 1971
 Well Completed: 1/5 1972 Total Depth 3660'
 Initial Production: 105 bbls./day, 14% wtr. per productivity test (St.) dtd. 3/3/72

Casing Record

Size: 8-5/8 Set at 250' Size: _____ Set at _____
 Size: 5 1/2" Set at 3659' Size: _____ Set at _____

Liner Record

Size: None set Set from _____ To _____

Cementing

Casing Size	Sacks	Type Cement and Additives
<u>8-5/8"</u>	<u>150 sx.</u>	<u>HA5 Common</u>
<u>5 1/2"</u>	<u>100 sx</u>	<u>SS Common w/10 bbls. salt flush</u>
<u>5 1/2"</u>	<u>250 "</u>	<u>50/50 Pozmix w/6% gel</u>

Perforations

Formation	Perforated Interval and Number Shots
<u>K.C.</u>	<u>3517-20' w/2/ft.</u>
<u>K.C.</u>	<u>3502-06' w/2/ft.</u>
<u>Lansing/K.C.</u>	<u>3426-30' w/2/ft.</u>

Electric Log Run (Show type log and depths covered)

Welex Radiation-Guard from 0' - 3659'
Welex Gamma Collar Log from 0' - 3659'

(Fill in formation and related information on reverse side)

FORMATION, TESTING AND COMPLETION RECORD

32-12-17w

Show Drill Stem Tests,
Well Stimulation and
Production Tests

Formation	Top	Bottom	Tests
			DST #1 3363-3380 30-30-90-30 30' OSWM 60' WM 60' MW 856# - 768# 40# - 104#
			DST #2 3385-3405 30-30-30-30 15' mud. FP 32-32 BHP 48# - 32# T 104°
			DST #3 3404-3422 30-30-90-30 150' GIP 30' HOCM 60' SOCM 288# - 192# FP 40# - 64# T 103°
			DST #4 3421-3432 30-30-30-30 420' GIP 65' HOCM 120' M.O. 614# - 564# FP 25# - 62# T104°
			DST #5 3432 - 50 30-30-30-30 5' mud. 426#-288# FP 25# - 25# T 105°
			DST #6 3488-3555 30-30-90-30 170' GIP 130' OGCM 280#-272# FP 64# - 96#
			DST #7 3528-3590 30-30-30-30 10' mud 112#-96# FP 64# - 64# T104°
			250 gals. M.A.
			1 000 " 28% + 1,000 15% (re-acidized)
			250 " M.A.
			2 000 " 28% + 2,000 gals. 15% (re-acidized)
			3 500 + 3,000 = 6,500 gals. total
K.C.	3517-20'		
Lsg./K.C.	3426-30'		

Log Tops
 Anhy. 1287 (+794)
 Heeb. 3298 (-1217)
 Toronto 3321 (-1240)
 Lsg. 3345 (-1264)
 B/K.C. 3586 (-1405)
 Arbuckle 3653 (-1572)
 LTD 3659 (-1578)

LOG TOPS

ANHY	1294
HEEB	3298
LKC	3345
ARB	3650
LTD	3659
RTD	3660

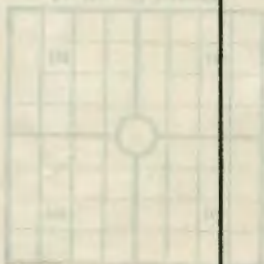

35-15-11M

h9h9IS