

PI  
PI  
Jm

KANSAS  
State Geological Survey  
WICHITA BRANCH

WELL COMPLETION REPORT AND  
DRILLER'S LOG

S. 5 T. 12 R. E 19 W  
Loc. NE/C SW/4  
County Ellis

API No. 15 \_\_\_\_\_  
County \_\_\_\_\_ Number \_\_\_\_\_

Operator  
-Don E. Pratt

Address  
P.O. Box 370-Hays, KS 67601

Well No. 1-5 Lease Name Homburg Estate

Footage Location  
feet from (N) (S) line \_\_\_\_\_ feet from (E) (W) line \_\_\_\_\_

Principal Contractor Murfin Drilling Co., Geologist Green & Green

Spud Date 8-11-81 Date Completed 8-18-81 Total Depth 3756 P.B.T.D. \_\_\_\_\_

Directional Deviation \_\_\_\_\_ Oil and/or Gas Purchaser \_\_\_\_\_

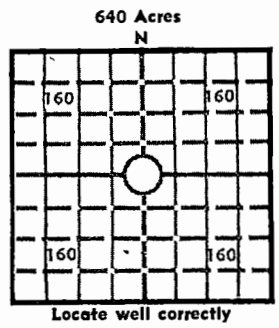

Elev.: Gr. 2136  
DF 2139 KB 2141

CASING RECORD

Report of all strings set— surface, intermediate, production, etc.

Purpose of string	Size hole drilled	Size casing set (in O.D.)	Weight lbs/ft.	Setting depth	Type cement	Sacks	Type and percent additives
surface	20½	8 5/8"	20#	180'	CQS ε	135	

LINER RECORD

PERFORATION RECORD

Top, ft.	Bottom, ft.	Sacks cement	Shots per ft.	Size & type	Depth interval

Size	Setting depth	Packer set at

ACID, FRACTURE, SHOT, CEMENT SQUEEZE RECORD

Amount and kind of material used	Depth interval treated

INITIAL PRODUCTION

Date of first production \_\_\_\_\_ Producing method (flowing, pumping, gas lift, etc.) \_\_\_\_\_

RATE OF PRODUCTION PER 24 HOURS	Oil	Gas	Water	Gas-oil ratio
	bbls.	bbls.	bbls.	CFPB

Disposition of gas (vented, used on lease or sold) \_\_\_\_\_ Producing interval (s) \_\_\_\_\_

INSTRUCTIONS: As provided in KCC Rule 82-2-125, within 90 days after completion of a well, one completed copy of this Drillers Log shall be transmitted to the State Geological Survey of Kansas, 4150 Monroe Street, Wichita, Kansas 67209. Copies of this form are available from the Conservation Division, State Corporation Commission, 245 No. Water, Wichita, Kansas 67202. Phone AC 316-522-2206. If confidential custody is desired, please note Rule 82-2-125. Drillers Logs will be on open file in the Oil and Gas Division, State Geological Survey of Kansas, Lawrence, Kansas 66044.

Operator Don E. Pratt		DESIGNATE TYPE OF COMP.: OIL, GAS, DRY HOLE, SWDW, ETC.: Dry hole
Well No. 1-5	Lease Name Homburg Estate	
S 5 T 12 R 19 <sup>E</sup> <sub>W</sub>		

**WELL LOG**

Show all important zones of porosity and contents thereof; cored intervals, and all drill-stem tests, including depth interval tested, cushion used, time tool open, flowing and shut-in pressures, and recoveries.

SHOW GEOLOGICAL MARKERS, LOGS RUN, OR OTHER DESCRIPTIVE INFORMATION.

FORMATION DESCRIPTION, CONTENTS, ETC.	TOP	BOTTOM	NAME	DEPTH
Geological report and well log attached.				

USE ADDITIONAL SHEETS, IF NECESSARY, TO COMPLETE WELL RECORD.

Date Received	BY DON E. PRATT
	<i>Susie Ubert</i> Signature
	SUSIE UBERT, OFFICE MGR Title
	9-24-81 Date