

KANSAS DRILLERS LOG

State Geological Survey
WICHITA, BRANCH

S. 31 T. 12S. R. 20 E. W

Loc. NW SE SE

County Ellis

API No. 15 — 051 — 22,239
County Number

Operator
Southern States Oil Company

Address
P.O. Box 1365, Great Bend, Kansas 67530

Well No. 7 Lease Name Bittel

Footage Location
990 feet from (N) (S) line 990 feet from (E) (W) line

Principal Contractor Geologist
Revlin Drlg, Inc. Green & Green

Spud Date Total Depth P.B.T.D.
1-16-81 3830

Date Completed Oil Purchaser
1-25-81 Koch Oil

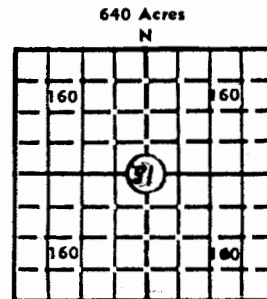

Locate well correctly

Elev.: Gr. 2149

DF KB 2154

CASING RECORD

Report of all strings set — surface, intermediate, production, etc.

Purpose of string	Size hole drilled	Size casing set (In O.D.)	Weight lbs/ft.	Setting depth	Type cement	Sacks	Type and percent additives
Surface	12 1/4"	8-5/8	28#	281	60/40 Poz	165	2% gel, 3%CC
Production	7-7/8"	5 1/2"	14#	3826'	Common	150	

LINER RECORD

PERFORATION RECORD

Top, ft.	Bottom, ft.	Sacks cement	Shots per ft.	Size & type	Depth interval

Size	Setting depth	Packer set at
2-7/8"EUE	3810'	

ACID, FRACTURE, SHOT, CEMENT SQUEEZE RECORD

Amount and kind of material used	Depth interval treated

INITIAL PRODUCTION

Date of first production 2-17-81	Producing method (flowing, pumping, gas lift, etc.) Pumping			
RATE OF PRODUCTION PER 24 HOURS	Oil 110 bbls.	Gas — MCF	Water Trace bbls.	Gas-oil ratio — CFPB
Disposition of gas (vented, used on lease or sold) None		Producing interval (s) Arbuckle		

INSTRUCTIONS: As provided in KCC Rule 82-2-125, within 90 days after completion of a well, one completed copy of this Drillers Log shall be transmitted to the State Geological Survey of Kansas, 4150 Monroe Street, Wichita, Kansas 67209. Copies of this form are available from the Conservation Division, State Corporation Commission, 3830 So. Meridian (P.O. Box 17027), Wichita, Kansas 66217. Phone AC 316-522-2206. If confidential custody is desired, please note Rule 82-2-125. Drillers Logs will be on an open file in the Oil and Gas Division, State Geological Survey of Kansas, Lawrence, Kansas 66044.

Operator Southern States Oil Company		DESIGNATE TYPE OF COMP.: OIL, GAS, DRY HOLE, SWDW, ETC.: Oil
Well No. 7	Lease Name Bittel	
s 31 T12s R 20 K W		

WELL LOG

Show all important zones of porosity and contents thereof; cored intervals, and all drill-stem tests, including depth interval tested, cushion used, time tool open, flowing and shut-in pressures, and recoveries.

SHOW GEOLOGICAL MARKERS, LOGS RUN, OR OTHER DESCRIPTIVE INFORMATION.

FORMATION DESCRIPTION, CONTENTS, ETC.	TOP	BOTTOM	NAME	DEPTH
Anhydrite	1488			
Topeka	3165			
Heebner	3398			
Toronto	3418			
Lansing-Kansas City	3436			
Base-Kansas City	3694			
Marmaton Chert	3735			
Arbuckle	3824			
Rotary Total Depth	3830			
DST #1 3482-3525': IOP-30, ISI-30, FOP-30, FSI-30, IFP 31-63, FFP 63-94, ISIP-691, FSIP-660			Recovered 140' OCM.	
DST #2 3580-3638': IOP-30, ISI-30, FOP-30, FSI-30, IFP 42-42, FFP 42-42, ISIP-105, FSIP-52			Recovered 15' Mud,	
DST #3 3725-3765': IOP-30, ISI-30, FOP-45, FSI-30, w/trace oil on tool, IFP 83-352, FFP 352-600, ISIP-993, FSIP-869			Recovered 1620' SW	
DST #4 3804-3830': IOP-30, ISI-30, FOP-30, FSI-30, Gassy free oil, 250' GMCO, IFP 62-103, FFP 103-186, ISIP-1200, FSIP-1190			Recovered 175'	
RECOMMENDATIONS: It was recommended and confirmed by all parties to set pipe and test the Arbuckle open hole, If and when the Arbuckle depletes, there are some other zones that should be tested. These are noted in the above descriptions.				

USE ADDITIONAL SHEETS, IF NECESSARY, TO COMPLETE WELL RECORD.

Date Received	<p><i>Charles Blakerby</i> Signature</p> <p>Gen. Supt. Title</p> <p>Feb. 25, 1981 Date</p>
---------------	--