

KANSAS

State Geological Survey
WICHITA BRANCH

WELL COMPLETION REPORT AND
DRILLER'S LOG

S. 2 T. 12S R. 22 ^{XX} W

API No. 15 — 195 — 20,830
County Number

Loc. SW NE NW

County Trego

Operator

A. Scott Ritchie

Address

125 N. Market, Suite 950 Wichita, Kansas 67202

Well No.

1

Lease Name

Pfannenstiel "A"

Footage Location

660 feet from (N) ~~XX~~ line 660 feet from (E) ~~XX~~ line

Principal Contractor

Murfin Drilling Company

Geologist

Galen Babcock

Spud Date

9/19/81

Date Completed

10/01/81

Total Depth

4089'

P.B.T.D.

none

Directional Deviation

Oil and/or Gas Purchaser

none

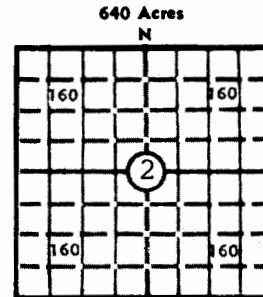

Elev.: Gr. 2375'

DF KB 2380'

CASING RECORD

Report of all strings set — surface, intermediate, production, etc.

Purpose of string	Size hole drilled	Size casing set (in O.D.)	Weight lbs/ft.	Setting depth	Type cement	Sacks	Type and percent additives
Surface		8-5/8"		207'	common quickset	160	

LINER RECORD

PERFORATION RECORD

Top, ft.	Bottom, ft.	Sacks cement	Shots per ft.	Size & type	Depth interval

Size	Setting depth	Packer set at

ACID, FRACTURE, SHOT, CEMENT SQUEEZE RECORD

Amount and kind of material used	Depth interval treated

INITIAL PRODUCTION

Date of first production		Producing method (flowing, pumping, gas lift, etc.)			
RATE OF PRODUCTION PER 24 HOURS	Oil	Gas	Water	Gas-oil ratio	
	bbls.	MCF	bbls.	CFPB	
Disposition of gas (vented, used on lease or sold)			Producing interval (s)		

INSTRUCTIONS: As provided in KCC Rule 82-2-125, within 90 days after completion of a well, one completed copy of this Drillers Log shall be transmitted to the State Geological Survey of Kansas, 4150 Monroe Street, Wichita, Kansas 67209. Copies of this form are available from the Conservation Division, State Corporation Commission, 245 No. Water, Wichita, Kansas 67202. Phone AC 316-522-2206. If confidential custody is desired, please note Rule 82-2-125. Drillers Logs will be on open file in the Oil and Gas Division, State Geological Survey of Kansas, Lawrence, Kansas 66044.

Operator **A. Scott Ritchie** DESIGNATE TYPE OF COMP.: OIL, GAS, DRY HOLE, SWDW, ETC.: **Dry hole**

Well No. **1** Lease Name **Pfannenstiel "A"**

S 2 T 12SR22 W

WELL LOG

Show all important zones of porosity and contents thereof; cored intervals, and all drill-stem tests, including depth interval tested, cushion used, time tool open, flowing and shut-in pressures, and recoveries.

SHOW GEOLOGICAL MARKERS, LOGS RUN, OR OTHER DESCRIPTIVE INFORMATION.

FORMATION DESCRIPTION, CONTENTS, ETC.	TOP	BOTTOM	NAME	DEPTH
---------------------------------------	-----	--------	------	-------

DST #1 from 3547'-3640' (Lower Topeka). Recovered 127' of mud, no show oil.
IFP:76-86#/30"; ISIP:1221#/45";
FFP:97-119#/30"; FSIP:1199#/45".

ELECTRIC LOG TOPS

DST #2 from 3628'-3693' (Toronto and Top zones). Recovered 245' of muddy water, slight show oil.
IFP:65-108#/30"; ISIP:1092#/45";
FFP:141-163#/30"; FSIP:1027#/45".

Anhy	1825' (+ 555)
B/Anhydrite	1867' (+ 513)
Topeka	3414' (-1034)
Heebner	3628' (-1248)
Toronto	3650' (-1270)
Lansing	3664' (-1284)
B/KC	3924' (-1544)
Marmaton	3986' (-1606)
Arbuckle	4070' (-1690)
LTD	4088' (-1708)

DST #3 from 3693'-3738' (35' & 50' zones). Recovered 510' of salt water.
IFP:65-163#/30"; ISIP:898#/30";
FFP:217-271#/30"; FSIP:887#/30".

DST #4 from 3736'-3754' (70' zone). Recovered 15' of mud, no show of oil.
IFP:43-43#/30"; ISIP:882#/30";
FFP:43-43#/30"; FSIP:747#/30".

DST #5 from 3752'-3792'. Packer failure.

DST #6 from 3748'-3792' (90' & 100' zones). Recovered 362' of muddy water, no show of oil.
IFP:97-130#/30"; ISIP:974#/45";
FFP:184-217#/30"; FSIP:952#/45".

DST #7 from 3786'-3866' (140', 160', & 180' zones). Recovered 4' of mud.
IFP:54-54#/30"; ISIP:326#/30";
FFP:54-54#/30"; FSIP:108#/30".

DST #8 from 3864'-3929' (200' & 220' zones). Recovered 65' mud, no show of oil.
IFP:65-65#/30"; ISIP:1145#/30";
FFP:76-76#/30"; FSIP:1092#/30".

DST #9 from 3993'-4040' (Marmaton). Recovered 15' of mud, few specks of oil.
IFP:43-43#/30"; ISIP:857#/30"; FFP:54-54#/30"; FSIP:769#/30".

USE ADDITIONAL SHEETS, IF NECESSARY, TO COMPLETE WELL RECORD.

Date Received	<i>F. Judson Hipps</i> Signature
	F. Judson Hipps, Geologist Title
	October 19, 1981 Date