

22-12-23W

KANSAS DRILLERS LOG

State Geological Survey
WICHITA, BRANCH

S. 22 T. 12 R. 23 ^EW
Loc. SW NW NE
County Trego

API No. 15 — 195 — 20,292
County Number

Operator
Beren Corporation

Address
970 Fourth Financial Center, Wichita, Kansas 67202

Well No. 1 Lease Name Donald

Footage Location
990 feet from (N) ~~6~~ line 2310 feet from (E) ~~XX~~ line

Principal Contractor Red Tiger Drilling Geologist Max S. Houston

Spud Date December 17, 1974 Total Depth 3390 P.B.T.D. -----

Date Completed December 22, 1974 Oil Purchaser -----

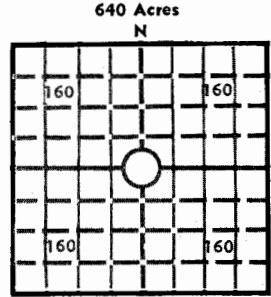

Locate well correctly
Elev.: Gr. 2414
DF _____ KB _____

CASING RECORD

Report of all strings set — surface, intermediate, production, etc.

Purpose of string	Size hole drilled	Size casing set (in O.D.)	Weight lbs/ft.	Setting depth	Type cement	Sacks	Type and percent additives
Surface	12 3/4"	8-5/8	28	255	60/40 Poz.	165	2% Gel, 3% CC

LINER RECORD

PERFORATION RECORD

Top, ft.	Bottom, ft.	Sacks cement	Shots per ft.	Size & type	Depth interval

Size	Setting depth	Packer set at

ACID, FRACTURE, SHOT, CEMENT SQUEEZE RECORD

Amount and kind of material used	Depth interval treated

INITIAL PRODUCTION

Date of first production	Producing method (flowing, pumping, gas lift, etc.)				
RATE OF PRODUCTION PER 24 HOURS	Oil	Gas	Water	Gas-oil ratio	
	bbls.	MCF	bbls.	CFPB	
Disposition of gas (vented, used on lease or sold)			Producing interval(s)		

INSTRUCTIONS: As provided in KCC Rule 82-2-125, within 90 days after completion of a well, one completed copy of this Drillers Log shall be transmitted to the State Geological Survey of Kansas, 4150 Monroe Street, Wichita, Kansas 67209. Copies of this form are available from the Conservation Division, State Corporation Commission, 3830 So. Meridian (P.O. Box 17027), Wichita, Kansas 66217. Phone AC 316-522-2206. If confidential custody is desired, please note Rule 82-2-125. Drillers Logs will be on open file in the Oil and Gas Division, State Geological Survey of Kansas, Lawrence, Kansas 66044.

Operator

DESIGNATE TYPE OF COMP.: OIL, GAS, DRY HOLE, SWDW, ETC.:

Boren Corporation

Dry Hole

Well No.

Lease Name

1

Donald

S 22 T 12 R 23 E W

WELL LOG

Show all important zones of porosity and contents thereof; cored intervals, and all drill-stem tests, including depth interval tested, cushion used, time tool open, flowing and shut-in pressures, and recoveries.

SHOW GEOLOGICAL MARKERS, LOGS RUN, OR OTHER DESCRIPTIVE INFORMATION.

FORMATION DESCRIPTION, CONTENTS, ETC.	TOP	BOTTOM	NAME	DEPTH
NO DST's			Anhydrite	1870-1905



USE ADDITIONAL SHEETS, IF NECESSARY, TO COMPLETE WELL RECORD.

Date Received

Max S. Houston

Signature

Max S. Houston, Geologist

Title

May 21, 1975

Date

103823

Geological Survey
WICHITA, BRANCH

15-195-20292 ✓

22-12-23w

DRILLERS LOG

No. 1 Donald

CASING RECORD:

3-5/8" @ 260'
w/165 sx. cmt.

TOTAL DEPTH: 3390'

COMPANY:

CONTRACTOR: Red Tiger Drilling Company

COMMENCED: December 17, 1974

COMPLETED: December 23, 1974

DESCRIPTION:

SW NW NE
22-12S-23W
Trego County,
Kansas

ELEVATION: 2419' K.B.

FORMATION

FROM

TO

REMARKS

Shale, Sand & Shale	0	265
Post Rock & Shale	265	1060
Shale & Sand	1060	1310
Sand	1310	1600
Shale & Sand	1600	1855
Redbed	1855	1870
Anhydrite	1870	1905
Redbed & Shale	1905	2048
Shale	2048	2454
Shale & Lime	2454	2570
Shale	2570	2795
Lime & Shale	2795	3120
Lime	3120	3390



I certify that this is a true and correct copy of the above log to the best of my knowledge.

RED TIGER DRILLING COMPANY

Linda H. Dickens
Linda H. Dickens

Subscribed and sworn to before me this 26th day of December, 1974.