

PT

State Geological Survey
WICHITA BRANCH

KANSAS DRILLERS LOG

API No. 15 — 195 County — 20,854 Number

S. 4 T. 12S R. 24W ^{XX}W
 Loc. NE SE NW
 County Trego

Operator Keith F. Walker

Address 219 Stanley, Ardmore, Oklahoma 73401

Well No. #1 Lease Name Malinowsky

Footage Location 990 feet from ~~XX~~ (S) line 330 feet from (E) ~~XX~~ line

Principal Contractor John O. Farmer, Inc. Geologist Cary McConnell

Spud Date 8-4-81 Total Depth 4149' P.B.T.D.

Date Completed 8-13-81 Oil Purchaser

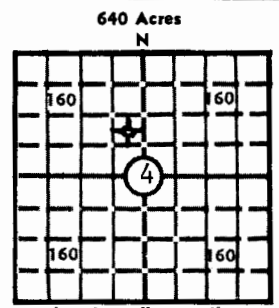

Locate well correctly
 Elev.: Gr. 2528'
 DF 2531' KB 2533'

CASING RECORD

Report of all strings set — surface, intermediate, production, etc.

Purpose of string	Size hole drilled	Size casing set (in O.D.)	Weight lbs/ft.	Setting depth	Type cement	Sacks	Type and percent additives
Surface	12-1/4"	8-5/8"	24	216'	Common	175	

LINER RECORD

PERFORATION RECORD

Top, ft.	Bottom, ft.	Sacks cement	Shots per ft.	Size & type	Depth interval

Size	Setting depth	Packer set at

ACID, FRACTURE, SHOT, CEMENT SQUEEZE RECORD

Amount and kind of material used	Depth interval treated

INITIAL PRODUCTION

Date of first production _____ Producing method (flowing, pumping, gas lift, etc.) _____

RATE OF PRODUCTION PER 24 HOURS	Oil _____ bbls.	Gas _____ MCF	Water _____ bbls.	Gas-oil ratio _____ CFPB
---------------------------------	-----------------	---------------	-------------------	--------------------------

Disposition of gas (vented, used on lease or sold) _____ Producing interval (s) _____

INSTRUCTIONS: As provided in KCC Rule 82-2-125, within 90 days after completion of a well, one completed copy of this Drillers Log shall be transmitted to the State Geological Survey of Kansas, 4150 Monroe Street, Wichita, Kansas 67209. Copies of this form are available from the Conservation Division, State Corporation Commission, 3830 So. Meridian (P.O. Box 17027), Wichita, Kansas 66217. Phone AC 316-522-2206. If confidential custody is desired, please note Rule 82-2-125. Drillers Logs will be on open file in the Oil and Gas Division, State Geological Survey of Kansas, Lawrence, Kansas 66044.

Operator Keith F. Walker		DESIGNATE TYPE OF COMP.: OIL, GAS, DRY HOLE, SWDW, ETC.:
Well No. #1	Lease Name Malinowsky	Dry Hole
S 4 T 12S R 24W ^K _W		

WELL LOG

Show all important zones of porosity and contents thereof; cored intervals, and all drill-stem tests, including depth interval tested, cushion used, time tool open, flowing and shut-in pressures, and recoveries.

SHOW GEOLOGICAL MARKERS, LOGS RUN,
OR OTHER DESCRIPTIVE INFORMATION.

FORMATION DESCRIPTION, CONTENTS, ETC.	TOP	BOTTOM	NAME	DEPTH
Clay & Sand	0	145		
Blue Shale	145	215		
Shale & Sand	215	1635		
Sand	1635	1861		
Red Bed	1861	2110		
Anhydrite	2110	2170		
Shale & Shells	2170	2440		
Lime & Shale	2440	2835		
Shale & Lime	2835	2965		
Lime & Shale	2965	3260		
Shale & Lime	3260	3380		
Lime & Shale	3380	3925		
Lime	3925	4149		

USE ADDITIONAL SHEETS, IF NECESSARY, TO COMPLETE WELL RECORD.

Date Received	<i>John O. Farmer</i>
	Signature
	President
	Title
	August 17, 1981
	Date