

IMPORTANT
 Kans. Geo. Survey request
 samples on this well.

15-195-20481

KANSAS DRILLERS LOG

API No. 15 — 195 — 20,481
 County Number

Operator
 Don E. Pratt Oil Operations

Address
 P. O. Box 370 Hays, Kansas 67601

Well No. #1-2
 Lease Name Hobbs

Footage Location
 330 feet from (N) (S) line 330 feet from (E) (W) line

Principal Contractor
 Murfin Drilling Co.,
 Geologist
 Green & Green

Spud Date 7-15-78
 Total Depth 4210'
 P.B.T.D.

Date Completed 7-22-78
 Oil Purchaser OKC

S. 2 T. 12 R. 25 E
 W

Loc. SW SW NE

County Trego

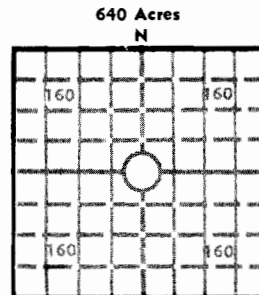

Locate well correctly

Elev.: Gr. 2560

DF 2562 KB 2565

CASING RECORD

Report of all strings set — surface, intermediate, production, etc.

Purpose of string	Size hole drilled	Size casing set (in O.D.)	Weight lbs/ft.	Setting depth	Type cement	Sacks	Type and percent additives
Surface	12½"	8 5/8"	20#	211'	CQS	180	
Oil string		4½"	15#	4206'	CQS	200	

LINER RECORD

PERFORATION RECORD

Top, ft.	Bottom, ft.	Sacks cement	Shots per ft.	Size & type	Depth interval
			4		4080-86

TUBING RECORD

Size	Setting depth	Packer set at
2 3/8"	4143'	

ACID, FRACTURE, SHOT, CEMENT SQUEEZE RECORD

Amount and kind of material used	Depth interval treated
2,000 Gals.,	

INITIAL PRODUCTION

Date of first production 8-1-78
 Producing method (flowing, pumping, gas lift, etc.) swab

RATE OF PRODUCTION PER 24 HOURS
 Oil 80 bbl. 8 hrs. bbls.
 Gas MCF
 Water bbls.
 Gas-oil ratio CFPB

Disposition of gas (vented, used on lease or sold) Producing interval(s)

INSTRUCTIONS: As provided in KCC Rule 82-2-125, within 90 days after completion of a well, one completed copy of this Drillers Log shall be transmitted to the State Geological Survey of Kansas, 4150 Monroe Street, Wichita, Kansas 67209. Copies of this form are available from the Conservation Division, State Corporation Commission, 3830 So. Meridian (P.O. Box 17027), Wichita, Kansas 66217. Phone AC 316-522-2206. If confidential custody is desired, please note Rule 82-2-125. Drillers Logs will be on open file in the Oil and Gas Division, State Geological Survey of Kansas, Lawrence, Kansas 66044.

Operator
Don E. Pratt

DESIGNATE TYPE OF COMP.: OIL, GAS,
DRY HOLE, SWDW, ETC.:
oil.

Well No.

#1

Lease Name

Hobbs.

S 2 T 12 R 25 W
xxx

WELL LOG

Show all important zones of porosity and contents thereof; cored intervals, and all drill-stem tests, including depth interval tested, cushion used, time tool open, flowing and shut-in pressures, and recoveries.

SHOW GEOLOGICAL MARKERS, LOGS RUN,
OR OTHER DESCRIPTIVE INFORMATION.

FORMATION DESCRIPTION, CONTENTS, ETC.	TOP	BOTTOM	NAME	DEPTH
As per copy of Geological report attached., Well log & copy of Electric log enclosed.,				

USE ADDITIONAL SHEETS, IF NECESSARY, TO COMPLETE WELL RECORD

Date Received

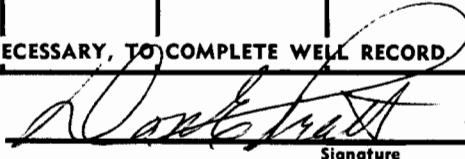
Signature

Don E. Pratt

Operator

Title

8-28-78

Date

163553

WELL LOG

COMPANY Don E. Pratt

SEC. 2 T. 12S R. 25W
LOC. SW SW NE

FARM HOBBS NO. 1

RIG. NO. 16

TOTAL DEPTH 4210'

COUNTY Trego
KANSAS

COMM. July 15, 1978

COMP. July 22, 1978

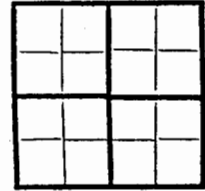

CONTRACTOR Murfin Drilling Company

CASING

20	10	
15	8-5/8"	@ 211' w/180 sx.
12	6	
13	5 1/2"	@ 4206' w/200 sx.

ELEVATION

PRODUCTION

FIGURES INDICATE BOTTOM OF FORMATIONS

65'	Surface soil & Sand	
90'	Sand	
120'	Clay	
212'	Shale	
430'	Sand & Shale	
1240'	Shale & Clay	
1675'	Sand & Shale	
1880'	"Cedar Hills" Sand	
2148'	Sand & Shale	
2187'	Anhydrite	
3790'	Shale	
3998'	Lime & Shale	
4035'	Lime	
4210'	Lime & Shale	RTD