

**KANSAS DRILLERS LOG**

S. 2 T. 12 R. 25 <sup>N</sup>/<sub>W</sub>

API No. 15 — 195 — 20,564  
County Number

Loc. NE NE

County Trego

Operator  
Don E. Pratt

Address  
P. O. Box 370 Hays, Kansas 67601

Well No. #2-2 Lease Name Hobbs

Footage Location  
feet from (N) (S) line feet from (E) (W) line

Principal Contractor Murfin Drilling Co. Geologist Green & Green

Spud Date 8-27-79 Total Depth 4185' P.B.T.D.

Date Completed 9-3-79 Oil Purchaser OKC

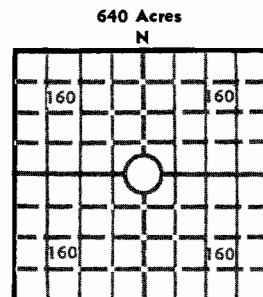

Elev.: Gr. 2533

DF 2535 KB 2538

**CASING RECORD**

Report of all strings set — surface, intermediate, production, etc.

Purpose of string	Size hole drilled	Size casing set (in O.D.)	Weight lbs/ft.	Setting depth	Type cement	Sacks	Type and percent additives
Surface	12½"	8 5/8"	20#	172'	CQS	140	
Oil String		5½"	14#	4182	CQS	200	

**LINER RECORD**

**PERFORATION RECORD**

Top, ft.	Bottom, ft.	Sacks cement	Shots per ft.	Size & type	Depth interval
			4		4064-4070

**TUBING RECORD**

Size	Setting depth	Packer set at
2 3/8"	4090'	

**ACID, FRACTURE, SHOT, CEMENT SQUEEZE RECORD**

Amount and kind of material used	Depth interval treated
1500 gals.	

**INITIAL PRODUCTION**

Date of first production 9-18-79 Producing method (flowing, pumping, gas lift, etc.) Swab

RATE OF PRODUCTION PER 24 HOURS  
Oil 20 bbls. 4 hrs. bbls. Gas MCF Water bbls. Gas-oil ratio CFPB

Disposition of gas (vented, used on lease or sold) Producing interval (s)

INSTRUCTIONS: As provided in KCC Rule 82-2-125, within 90 days after completion of a well, one completed copy of this Drillers Log shall be transmitted to the State Geological Survey of Kansas, 4150 Monroe Street, Wichita, Kansas 67209. Copies of this form are available from the Conservation Division, State Corporation Commission, 3830 So. Meridian (P.O. Box 17027), Wichita, Kansas 66217. Phone AC 316-522-2206. If confidential custody is desired, please note Rule 82-2-125. Drillers Logs will be on open file in the Oil and Gas Division, State Geological Survey of Kansas, Lawrence, Kansas 66044.

Operator DON E. PRATT DESIGNATE TYPE OF COMP.: OIL, GAS, DRY HOLE, SWDW, ETC.: OIL

Well No. 2-2 Lease Name Hobbs

S 2 T 12S R 25W E W

WELL LOG Show all important zones of porosity and contents thereof; cored intervals, and all drill-stem tests, including depth interval tested, cushion used, time tool open, flowing and shut-in pressures, and recoveries. SHOW GEOLOGICAL MARKERS, LOGS RUN, OR OTHER DESCRIPTIVE INFORMATION.

Table with 5 columns: FORMATION DESCRIPTION, CONTENTS, ETC.; TOP; BOTTOM; NAME; DEPTH. Content: Copy of Geological report attached.,

USE ADDITIONAL SHEETS, IF NECESSARY, TO COMPLETE WELL RECORD.

Date Received DON E. PRATT BY Susie Ubert Signature SUSIE UBERT OFFICE MGR Title 9-24-79 Date

LSSE91

# WELL LOG

Copy

**COMPANY** Don E. Pratt      **SEC.2** T.12S R.25W  
**FARM** HOBBS      **NO.** 2-2      **LOC.** 440' Loc NE NE NE  
**RIG. NO.** 16  
**TOTAL DEPTH** 4185'      **COUNTY** Trego County  
**COMM.** 8-27-79      **COMP.** 9-4-79      **KANSAS**  
**CONTRACTOR** Murfin Drilling Company

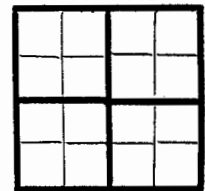

**CASING**  
 20 10  
 15 8-5/8" csg. set @ 172' w/140 sx. of 60-40 Positiv, 5% CaCl.  
 12 6  
 13 5-1/2" csg. set @ 4182' w/200 sx. of Common, 8% Salt, 2% CaCl.

FIGURES INDICATE BOTTOM OF FORMATIONS

30'	Surface Soil
85'	Sand
100'	Ocra
173'	Shale (Blue)
610'	Sand & Shale
1015'	Shale
1185'	Sand
1630'	Shale & Sand
2133'	Sand & Shale
2167'	ANHYDRITE
2320'	Sand & Shale
2925'	Shale
3115'	Shale & Lime
3290'	Lime & Shale
3830'	Shale & Lime
3960'	Lime & Shale
4015'	Shale & Lime
4050'	Lime
4078'	Shale & Lime
4155'	Lime
4185'	Lime & Shale

OCT 11 1979  
 TREGO COUNTY  
 KANSAS