

State Geological Survey  
 WICHITA, BRANCH  
**KANSAS DRILLERS LOG**

S29 T.12 R. 15 <sup>X</sup>/<sub>W</sub>  
 Loc. 990' FWL & 990' FSL  
 County Russell

API No. 15 — 167 — 20,751  
 County Number

Operator  
 Sohio Petroleum Co.

Address  
 Box 673 Russell, Kansas

Well No. # 1 Lease Name Meckel

Footage Location  
 990 feet from (E) (S) line 990 feet from (E) (W) line

Principal Contractor Red Tiger Drilling Company Geologist Francis Whisler

Spud Date July 22, 1975 Total Depth 3400' P.B.T.D. -----

Date Completed August 1, 1975 Oil Purchaser -----

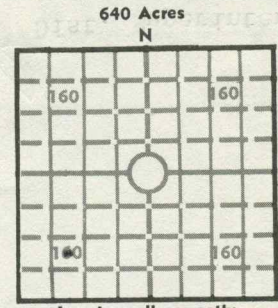

Locate well correctly  
 Elev.: Gr. 1866'  
 DF 1868' KB 1871'

**CASING RECORD**

Report of all strings set — surface, intermediate, production, etc.

Purpose of string	Size hole drilled	Size casing set (in O.D.)	Weight lbs/ft.	Setting depth	Type cement	Sacks	Type and percent additives
Surface	12-1/4"	8-5/8"	28#	113.77'	Portland A	125	2% CaCl

**LINER RECORD**

**PERFORATION RECORD**

Top, ft.	Bottom, ft.	Sacks cement	Shots per ft.	Size & type	Depth interval
	NONE				
<b>TUBING RECORD</b>			NONE		
Size	Setting depth	Packer set at			
NONE					

**ACID, FRACTURE, SHOT, CEMENT SQUEEZE RECORD**

Amount and kind of material used	Depth interval treated
NONE	NONE

**INITIAL PRODUCTION**

Date of first production NONE Producing method (flowing, pumping, gas lift, etc.)

RATE OF PRODUCTION PER 24 HOURS	Oil <u>-----</u> bbls.	Gas <u>-----</u> MCF	Water <u>-----</u> bbls.	Gas-oil ratio <u>-----</u> CFPB
---------------------------------	------------------------	----------------------	--------------------------	---------------------------------

Disposition of gas (vented, used on lease or sold) ----- Producing interval (s) Dry Hole

INSTRUCTIONS: As provided in KCC Rule 82-2-125, within 90 days after completion of a well, one completed copy of this Drillers Log shall be transmitted to the State Geological Survey of Kansas, 4150 Monroe Street, Wichita, Kansas 67209. Copies of this form are available from the Conservation Division, State Corporation Commission, 3830 So. Meridian (P.O. Box 17027), Wichita, Kansas 66217. Phone AC 316-522-2206. If confidential custody is desired, please note Rule 82-2-125. Drillers Logs will be on open file in the Oil and Gas Division, State Geological Survey of Kansas, Lawrence, Kansas 66044.

670769

Operator **Sohio Petroleum Company** DESIGNATE TYPE OF COMP.: OIL, GAS, DRY HOLE, SWDW, ETC.: **Dry Hole**

Well No. **1** Lease Name **Meckel**

S 29 T 12S R 79  W

**WELL LOG**

Show all important zones of porosity and contents thereof; cored intervals, and all drill-stem tests, including depth interval tested, cushion used, time tool open, flowing and shut-in pressures, and recoveries.

SHOW GEOLOGICAL MARKERS, LOGS RUN, OR OTHER DESCRIPTIVE INFORMATION.

FORMATION DESCRIPTION, CONTENTS, ETC.	TOP	BOTTOM	NAME	DEPTH
DST #1	3062	3095	Grand Haven	2,448'
Open 30 min. Shut in 30 min.			Dry Shale	2,456'
Open 60 min. Shut in 60 min.			Langdon	2,484'
Weak blow increasing throughout.			Tarkio Lime	2,521'
Recovery: 130' of muddy water with scum oil on top.			Willard Shale	2,545'
			Topeka	2,771'
			Toronto	3,011'
IFP: 55 to 64 psi			L-KC	3,041'
IBHP: 409 psi			Arbuckle	3,383'
FBHP: 418 psi				
FFP: 64 to 82 psi				
Temp: 90°				
Ran Dresser Atlas Gamma Ray-Laterolog				
No cores..				

USE ADDITIONAL SHEETS, IF NECESSARY, TO COMPLETE WELL RECORD.

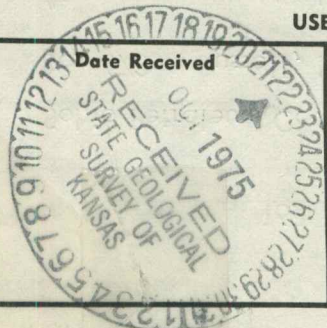

*W. H. Ward*  
 W. H. Ward Signature DIST. Superintendent  
 District Superintendent  
 Title  
 August 29, 1975  
 Date